

ADDENDUM NO. 2

TO: PLANS AND SPECIFICATIONS FOR STATE OF MISSOURI

**Improve Flight Line and Building Renovation
Limited Army Aviation Support Facility
Jefferson City, Missouri
PROJECT NO.: T2037-01**

Bid Opening Date: 1:30 PM, July 22, 2021 (Not Changed)

Bidders are hereby informed that the construction Plans and/or Specifications are modified as follows:

SPECIFICATION CHANGES:

1. Section 321313 – Concrete Paving

a. REVISE Paragraph 2.1-C as follows:

C. Reinforcing Bars: ASTM A 615/A 615M, Grade 60; deformed, epoxy coated at all construction joints. Bars completely encased in the concrete mat will not require epoxy coating.

b. REVISE Paragraph 2.3-B as follows:

B. Moisture-Retaining Cover: ASTM C 171, polyethylene film or white burlap-polyethylene sheet. Not Applicable when penetrating silicate cure and sealer is utilized.

c. REVISE Paragraph 2.3-D as follows:

D. Evaporation Retarder: Waterborne, monomolecular film forming; manufactured for application to fresh concrete. Not Applicable when penetrating silicate cure and sealer is utilized.

d. REVISE Paragraph 2.3-E as follows:

E. Clear Waterborne Membrane-Forming Curing Compound: ASTM C 309, Type 1, Class B, dissipating. Not Applicable when penetrating silicate cure and sealer is utilized.

e. REVISE Paragraph 3.6-B as follows:

B. Comply with the more stringent of ACI 306.1 for cold-weather protection or the following:

1. Follow cold weather concrete placement procedures when the surrounding air temperature is below 40°F or if freezing temperatures are likely during the specified curing period.
2. Place and protect concrete in accordance with ACI 306 during cold weather. Minimum temperature maintained during curing shall be as specified in Table 1.4.1, ACI 306.

3. From November 1st to April 15th, concrete shall not be placed without materials for its protection readily available on the job site, in quantities sufficient to protect all concrete that has not cured for the specified curing time.
 4. The tables and graphs in Chapter 4, ACI 306 indicate the required minimum amount of insulation.
 5. Do NOT use frozen materials or materials containing ice in the concrete.
 6. Forms, reinforcement, filler, etc. are to be free from frost and concrete. Do NOT place forms over or in contact with frozen earth.
 7. Concrete placement with air temperature at or anticipated to fall below 40°F within the 24-hours of placement shall use heated mixing water and aggregate. Protect the concrete by adequate heating and/or covering.
 8. Heating: Within the enclosure, provide artificial heat to maintain the temperatures specified, continuously, and with a reasonable degree of uniformity in all parts of the enclosure.
 - a. All exposed concrete surfaces within the heated area shall be wet down with a hose stream at least once every 24 hours during the heating period.
 - b. The Contractor shall provide adequate fire protection at all times on each floor where heating is in progress.
 - c. The Contractor shall maintain watchmen or other attendants to keep the heating units in continuous operation.
 - d. Do NOT place heating appliances in a manner to endanger formwork, expose any area of concrete to drying out, or other injury due to excessive temperatures.
 - e. Vent heating units. Do NOT permit the heat to dry the concrete. Venting shall adequately exhaust carbon dioxide and carbon monoxide to prevent damage to the concrete and protect the workers.
 9. Covering: Protect exposed surfaces of slabs on earth, frames, slabs, beams, girders, walls, etc., formed with 1 in. or less thick wood forms or all metal forms. Protect with 2-in. blanket insulation covered with polyethylene sheets, Sisalkraft, or tarpaulins. Protection is in addition to curing membrane.
 10. Placing concrete when outside temperature is below 40°F:
 - a. Standard concrete mixes shall have a temperature of not less than 70°F or more than 80°F when placed in the forms.
 - b. Maintain standard concrete mixes at a temperature of not less than 70°F for three days or 50°F for five days.
 - c. Maintain high strength concrete at a temperature of not less than 70°F for two days or 50°F for three days.
 - d. The method of protection and curing shall prevent evaporation of moisture from the concrete and injury to the surface.
 11. After discontinuing heating, lower temperatures gradually. Drop shall not exceed 1 degree per hour for the first 24 hours and 2 degrees per hour thereafter until reaching the outside temperature.
 12. Do NOT use of salts or chemicals for protection from freezing.
 13. Remove and replace concrete damaged by freezing at the Contractor's expense.
- f. REVISE Paragraph 3.9-B as follows:
- B. Sweep and clean surface to eliminate loose material dust and all existing surface paint. Remove any oil, grease or visible curing compound.
- g. REVISE Paragraph 3.10 as follows:

3.10 SEALANT

- A. All Pavement joints shall be sealed with hot-poured joint sealer in compliance with the Standard Specification and Article 1057.5.
 - 1. The hot poured sealer shall be placed utilizing a "V" shaped wand tip, to allow penetration of the materials into the joints while providing neat completely filled joints.
 - 2. Joints shall be completely filled or over banded not to exceed 1½". Excessive over banding shall be removed as directed by the A/E.
- B. Existing Pavement Joints shall have Joint Filler installed prior to hot-poured joint sealer being installed if the existing pavement joint is greater than ½" in width.

DRAWING CHANGES:

1. SHEET G002

- a. ADD General Note 7 as follows:

- 7) Owner will be responsible for moving all movable furnishings out of the work areas to facilitate interior renovation work. Contractor shall coordinate with Owner to schedule furnishing transfers with work activities.

2. SHEET C001

- a. REVISE Permit Requirements Note 2 as follows:

- 2. Owner has applied for the required Floodplain Development Permit for the project with the Missouri Department of Natural Resources (DNR). The Owner will also assume responsibility for any additional permitting application requirements related to "No Rise", "Elevation", and/or "Floodproofing" certificates.

- b. ADD Permit Requirements Note 3 as follows:

- 3. Owner has applied for an FAA Obstruction Evaluation/Airport Airspace Analysis and expects to receive approval for the proposed permanent exterior improvements as well as temporary construction activities with allowable equipment heights up to 30 feet above grade by October 18, 2021. Exterior improvements cannot be initiated until completion of the FAA analysis. Interior renovation work is not subject to the FAA analysis.

- c. ADD Landscape Rock Notes as follows:

LANDSCAPE ROCK NOTES

- 1. Commercial edging shall be powder coated steel edging. Color shall be brown or green per the owner and shall be a minimum 1/8" thick and 6" tall.
- 2. 1 1/2" River Run landscape rock mulch shall be installed to a settled depth of 3" in specified areas.
- 3. Polypropylene weed barrier shall be installed in all landscape rock areas defined by edging and pavements. The landscape fabric shall be a woven, needle-punched polypropylene fabric having a minimum weight of 4.1 ounces per square yard (ASTM D 5261).

3. SHEET C102

- a. REVISE Detail 1, Typical Sidewalk reinforcement note as follows:

6 X 6 W1.4 X W1.4 WWF or #4 Bars @ 3'-0" O.C.

- b. REVISE Detail 2, PCC Paving Detail reinforcement note as follows:

6 X 6 W1.4 X W1.4 WWF or #4 Bars @ 2'-6" O.C.

- c. REVISE Note on Sheet C102 regarding the Base Bid Removable bollards as follows:

BASE BID - 3 EACH 6"Ø, HEAVY DUTY SCH 40 STEEL, 42" EXPOSED HEIGHT, POWDER COATED SAFETY YELLOW, FLUSH MOUNT STAINLESS STEEL OR GALVANIZED EMBEDMENT SLEEVE, LOCKABLE REMOVABLE BOLLARD @ 5'-0" O.C., SLEEVE TO BE EMBEDDED IN CONCRETE SIMILAR TO DETAIL 5, SHEET C102 AND INSTALLED PER MANUFACTURERS REQUIREMENTS

4. SHEET E101

- a. ADD Keynote E13 per attached Exhibit A2-E101.

GENERAL COMMENTS:

1. Bidders needing additional site inspection should contact Missouri National Guard Project Manager Joseph Schaefer at (573) 638-9500 ext. 39692 or joseph.e.schaefer10.nfg@mail.mil to schedule a time to enter the facility.
2. Please contact Mandy Roberson, Contract Specialist, at (573) 522-0074, Mandy.Roberson@oa.mo.gov for questions about bidding procedures, MBE/WBE/SDVE Goals, and other submittal requirements.
3. **All bids shall be submitted on the bid forms without additional terms and conditions, modifications, or stipulations. Each space on the bid forms shall be properly filled including bid amounts for alternates. Failure to do so will result in rejection of the bid.**
4. **MBE/WBE/SDVE participation requirements can be found in DIVISION 00. The MBE/WBE/SDVE participation goals are 10%/10%/3%, respectively. All MBE, WBE, and MBE/WBE contractors, subcontractors, and suppliers must be certified by the State of Missouri, Office of Equal Opportunity. No other certifications from other Missouri certifying agencies will be accepted. If a bidder is unable to meet a participation goal, a Good Faith Effort Determination Form must be completed. Failure to complete this process will result in rejection of the bid.**
5. The deadline for technical questions was July 14, 2021.
6. Changes to, or clarification of, the bid documents are only made as issued in the addenda.
7. All correspondence with respect to this project must include the State of Missouri project number as indicated above.
8. Current Planholders list is available online at: [T2037-01 Improve Flight Line & Building Renovation-Limited Army Aviation Support Facility :: Plan Holders :: State of Missouri Office of Administration \(oafmdcplanroom.com\)](https://oafmdcplanroom.com)
9. Prospective Bidders contact American Document Solutions, 1400 Forum Blvd Suite 7A, Columbia MO 65203, (573) 446-7768 to get plans and specifications.

ATTACHMENTS:

1. Exhibit A2-E101

July 15, 2021

END ADDENDUM NO. 2

KEYNOTE LEGEND

VALUE	DESCRIPTION
E13	PROVIDE NEW DEDICATED CIRCUITS TO THE BREAK ROOM AND OFFICE MINI-SPLIT SYSTEM (FCU-1 & HP-1) FROM EXISTING 120/208V PANEL IN THIS LOCATION.

HANGAR
132

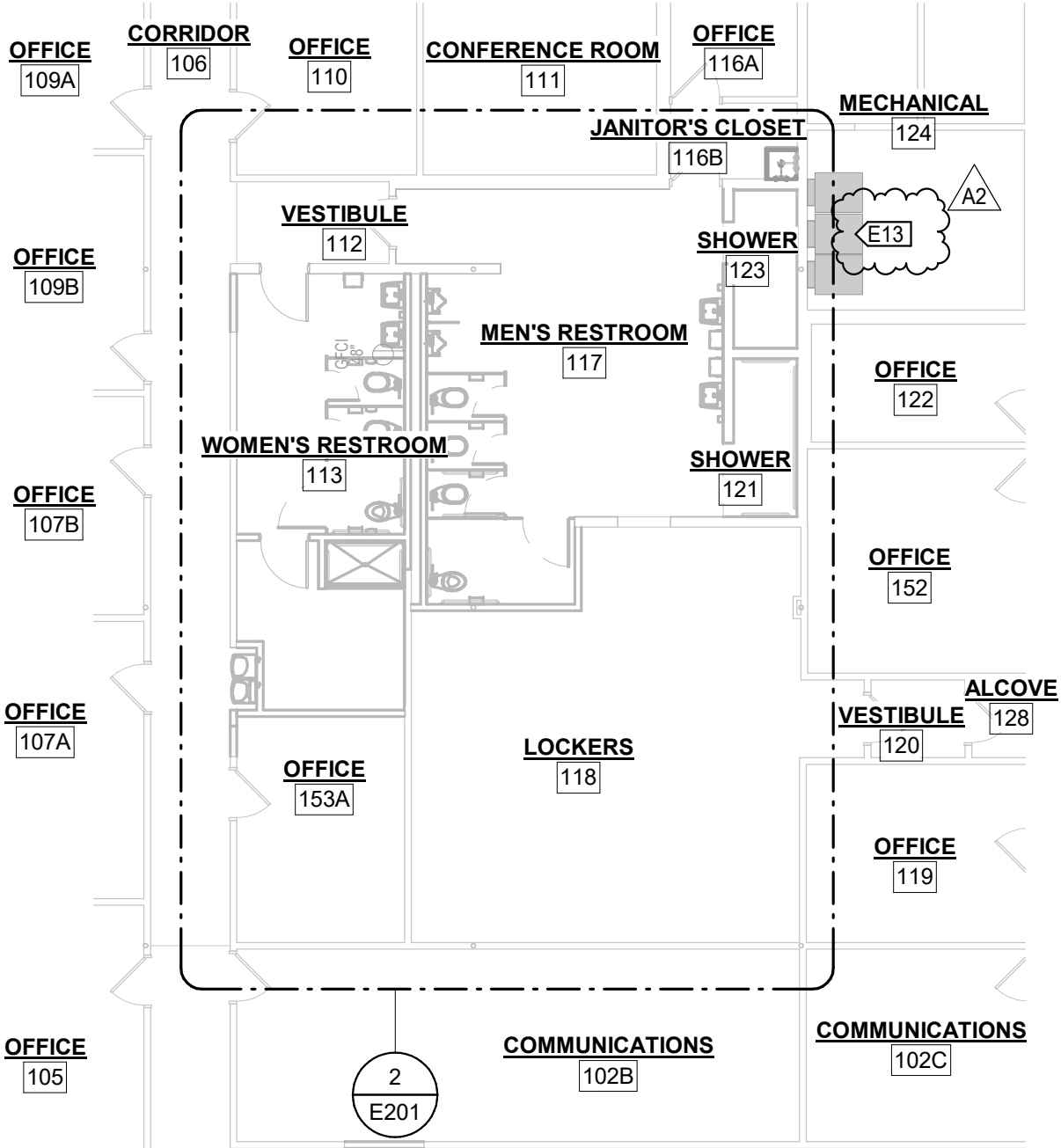

1 MAIN FLOOR POWER PLAN - ADDENDUM 2
3/32" = 1'-0"

KLINGNER
& ASSOCIATES, P.C.
Engineers • Architects • Surveyors

© KLINGNER & ASSOCIATES P.C.

This document shall not be used for any purpose or project for which it is not intended. Klingner & Associates P.C. and their Divisions shall be indemnified by the client and held harmless from all claims, damages, liabilities, losses and expenses, including attorneys fees and costs arising out of such misuse or reuse of the documents. In addition, unauthorized reproduction of these documents, in part or as a whole, is prohibited.

www.klingner.com

REVISION HISTORY			IMPROVE FLIGHT LINE AND PARKING AREA JEFFERSON CITY READINESS CENTER State of Missouri 1225 Cooper Drive Jefferson City, MO 65101	PROJECT NO.
△	DESCRIPTION	DATE		20-5010
A2	ADDENDUM 2	7/15/2021	DATE ISSUED	
SHEET TITLE			07/15/21	
ELECTRICAL PLAN			SHEET	
			A2-E101	