

ADDENDUM NO. 1

TO: PLANS AND SPECIFICATIONS FOR STATE OF MISSOURI

**Replace Flooring & Renovate Front Entrance
Missouri Geological Survey-
Buehler Building
Rolla, Missouri
PROJECT No.: W2303-01**

Bid Opening Date is: 1:30 PM, Tuesday, August 5, 2025 (Not Changed)

Bidders are hereby informed that the Construction Plans and/or Specifications are modified as follows:

SPECIFICATION CHANGES:

1. Section 033511 – Concrete Floor Finishes
 - a. REVISE paragraph 2.02-A.3 as follows: replace “High solids epoxy; two-component,” with “Water-based stain.”

DRAWING CHANGES:

1. SHEET A-601
 - a. ADD “Ceiling Height” column to Room Finish Schedule.
 - b. Revised Room Finish Schedule is attached.
2. SHEET A-202
 - a. REVISE Detail 4 to show bracing.
 - b. Revised Detail attached.

GENERAL COMMENTS:

1. The Pre-Bid Meeting was held July 22, 2025, at 10:00 AM, followed by a walk-through of the site. The Pre-Bid Meeting sign-in sheet is attached.
2. Bidders needing additional site inspection should contact Jerry Prewett at 573.368.2105 to schedule a time if access to the facility is required.
3. Please contact Paul Girouard, Contract Specialist, at 573-751-4797 or paul.girouard@oa.mo.gov, for questions about bidding procedures, MBE\WBE\SDVE goals, and submittal requirements.
4. The deadline for technical questions is Monday, July 28, 2025, at noon.
5. Changes to, or clarification of, the bid documents are only made as issued in the addenda.
6. All correspondence with respect to this project must include the State of Missouri project number as indicated above.
7. Current Planholders list available online at: [W2303-01 Replace Flooring & Renovate Front Entrance - Missouri Geological Survey-Buehler Building :: State of Missouri Office of Administration](#)
8. Prospective Bidders contact American Document Solutions, 1400 Forum Blvd Suite 1C, Columbia MO 65201, 573-446-7768 to order official plans and specifications.
9. **All bids shall be submitted on the bid form without additional terms and conditions, modifications, or stipulations. Each space on the bid form shall be**

properly filled including a bid amount for the alternate. Failure to do so will result in rejection of the bid.

10. MBE/WBE/SDVE participation requirements can be found in DIVISION 00. The MBE/WBE/SDVE participation goals are 10%/10%/3%, respectively. Only certified firms as of the bid opening date can be used to satisfy the MBE/WBE/SDVE participation goals for this project. If a bidder is unable to meet a participation goal, a Good Faith Effort Determination Form must be completed. Failure to complete this process will result in rejection of the bid.
11. The Contractor shall pay not less than the prevailing hourly rate of wages for work of a similar character in the locality in which the work is performed, as determined by the Missouri Department of Labor and Industrial Relations. Bidders are to adhere to Prevailing Wage Hourly Rate of Wages, and the Department of Labor and Industrial Relations can be contacted to determine the applicable wage rate for the work on this project.

ATTACHMENTS:

1. Room Finish Schedule
2. A-202 Detail 4
3. Pre-bid Meeting Sign-In Sheet

July 24, 2025

END ADDENDUM NO. 1

ROOM FINISH SCHEDULE									
ROOM NUMBER	ROOM NAME	FLOOR	BASE	WALL				FINISHED CEILING HEIGHT	NOTES
				NORTH	EAST	SOUTH	WEST		
101	LOBBY	LVT	VINYL	PT	PT	PT	PT	9'-0"	GYP / PT WHERE WALL REMOVAL RESULTS IN EXPOSED UNFINISHED SURFACES. SEE A-104 FOR ALTERNATE NO. 1 FLOOR FINISH.
101A	GALLERY	LVT	VINYL	—	PT	PT	PT	8'-0"	SEE A-104 FOR ALTERNATE NO. 1 FLOOR FINISH.
101B	GALLERY	LVT	VINYL	PT	PT	PT	PT	9'-0"	SEE A-104 FOR ALTERNATE NO. 1 FLOOR FINISH.
116	CORRIDOR	—	VINYL	—	—	—	GYP / PT	8'-5"	
118	CORRIDOR	—	VINYL	GYP / PT	—	—	—	8'-5"	
119	SHIPPING & RECEIVING ROOM	CONC	VINYL	PT	PT	PT	—	10'-7"	
119A	PUBLICATIONS	CPT	VINYL	PT	GYP / PT	GYP / PT	PT	8'-5"	LOCATIONS OF NEW WALL FINISHES ARE INDICATED ON A-103.
119B	STORAGE	CPT	VINYL	PT	PT	PT	PT	8'-5"	
121	GRAPHICS STUDIO	CPT	VINYL	PT	PT	PT	PT	13'-0"	
121A	STORAGE	CPT	VINYL	PT	PT	PT	PT	13'-0"	
LEGEND CPT: CARPET TILE CONC: POLISHED CONCRETE LVT: LUXURY VINYL TILE GYP: GYPSUM BOARD PT: PAINT									

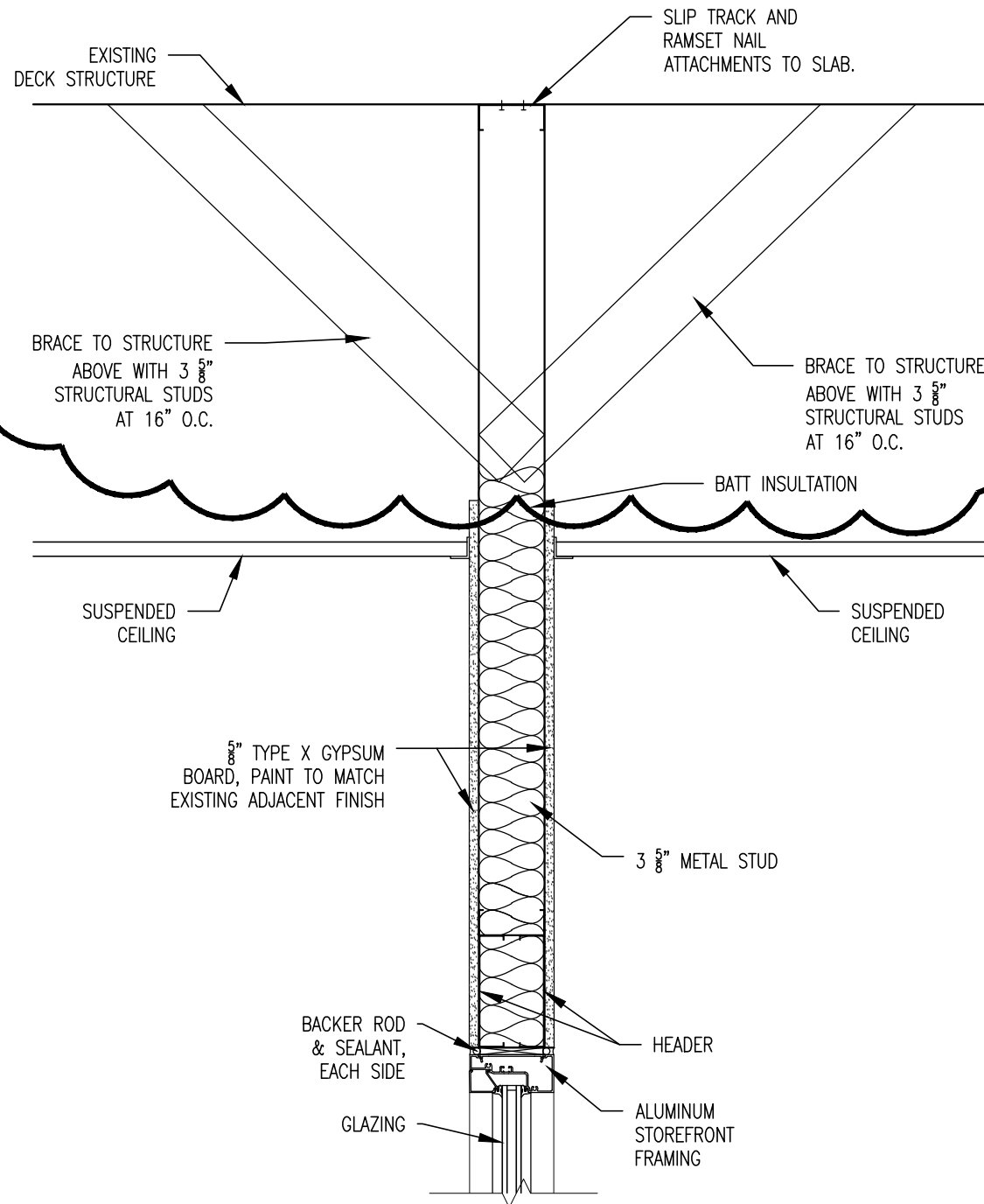

A-202 DETAIL 4

1



Pre-Bid Meeting Attendance Sheet
Geological Survey-Replace Flooring & Renovate Front Entrance
Buehler Building
Rolla, MO

Project No. W2303-01

Name & Title	Company Name & Type of Contracting	MBE/WBE/SDVE Status	Phone	E-Mail Address of Attendee & E-Mail Address of Individual filling out Bid Documents
 Cassandra Schmitz	OA/FMDC Project Manager		573.257.7033	cassandra.schmitz@oa.mo.gov
Sandra Walther 	OA/FMDC Section Leader		573.751.2283	sandra.walther@oa.mo.gov
Frankie Goins	OA/FMDC SEM		573.840.9280	frankie.Goins@oa.mo.gov
Jerry Prewett 	Deputy Director, Missouri Geological Survey		573.368.2105	jerry.prewett@dnr.mo.gov
Nona Lancaster	Administration Program Director Geological Survey		573.368.2123	nona.lancaster@dnr.mo.gov
Tracie Siebeneck on-line via Webex	OA/FMDC Project Manager		573.751.7831	tracie.Siebeneck@oa.mo.gov

Pre-Bid Meeting Attendance Sheet
Geological Survey-Replace Flooring & Renovate Front Entrance
Buehler Building
Rolla, MO

Project No. W2303-01

Name & Title	Company Name Type of Contracting	MBE/WBE/ SDVE Status	Phone	E-Mail Address of Attendee and E-Mail Address of Individual filling out Bid Documents
HH Alexander Haffley	Associate Engineer PMU		573.508.8917	alexander.Haffley@oa.mo.gov
CL Cara Luttrell	OA/FMDC Designer		573.508.2845	cara.luttrell@oa.mo.gov
Brendan Frazer	OA/FMDC Construction Project Specialist		573.690.4958	brendan.frazer@oa.mo.gov
Brad Schaefer	OA/FMDC Design/Develop/Survey Manger B1		573.526.0136	brad.schaefer@oa.mo.gov
Jason Kolks	OA/FMDC CI Planning Manager		573.751.6501	jason.kolks@oa.mo.gov

Project No. W2303-01

Name & Title	Company Name Type of Contracting	MBE/WBE/ SDVE Status	Phone	E-Mail Address of Attendee and E-Mail Address of Individual filling out Bid Documents
Terrell Johnson	SES Construction		573-253-9479	Terrell@SESConstruction.com
Dave Nichols	SES Construction LLC	WBE	573-253-1148	David@sesconstruction.com
Mike Burgart	G.B.H Builders		573-257-1062	Mike@gbhbuilders.com
Matt Benbout	Quality Electric		573-369-3107	qualityele@hughes.net
Tommy Perry	Prist Builders		737-208-9139	tommy@pristbuilders.com
Matt Roark	ARSI, Inc (7547000000)	SDVE	572-896-0222	MattRoark@arsi-mo.com

Pre-Bid Meeting Attendance Sheet
Geological Survey-Replace Flooring & Renovate Front Entrance
Buehler Building
Rolla, MO

Project No. W2303-01

Name & Title	Company Name Type of Contracting	MBE/WBE/ SDVE Status	Phone	E-Mail Address of Attendee and E-Mail Address of Individual filling out Bid Documents
Bob Hoffmeister	ALEXANDER CONST.	WBE	573-465-7830	lbchoff@gmail.com
Jason Delashmit Sr. Project Manager	McNew Electric		573-220 3101	jasond@mcnewelectric.com
Sammy Auxier	Alexander Construction	WBE	573-263-0857	Sammy@alexander-construction.com
Gay Augenstein	THOMAS CONST		314-792-3316	gaugenstein@thomasbuilder.com
Michael Tuttle Sr COO	Spray Services Inc Abatement	WBE	636 239 0404	mistyuttlessi@gmail.com
JASON Miller PM/ESTIMATOR	Environmental Operations (E.O.I.) Abatement, Demo, Consulting		314- 583-5695	Jason@environmentalops.com

Pre-Bid Meeting Attendance Sheet
Geological Survey-Replace Flooring & Renovate Front Entrance
Buehler Building
Rolla, MO

Project No. W2303-01

Name & Title	Company Name Type of Contracting	MBE/WBE/ SDVE Status	Phone	E-Mail Address of Attendee and E-Mail Address of Individual filling out Bid Documents
Michael Aslein Estimator	MSI Constructors		417-881- 0903	estimating@msiconstructors.com

Pre-Bid Meeting Attendance Sheet
Geological Survey-Replace Flooring & Renovate Front Entrance
Buehler Building
Rolla, MO

Project No. W2303-01

Name & Title	Company Name Type of Contracting	MBE/WBE/ SDVE Status	Phone	E-Mail Address of Attendee and E-Mail Address of Individual filling out Bid Documents