

CIPP Lining and Replacement of Storm Sewer Piping

Western Missouri Correctional Center

Cameron, Missouri

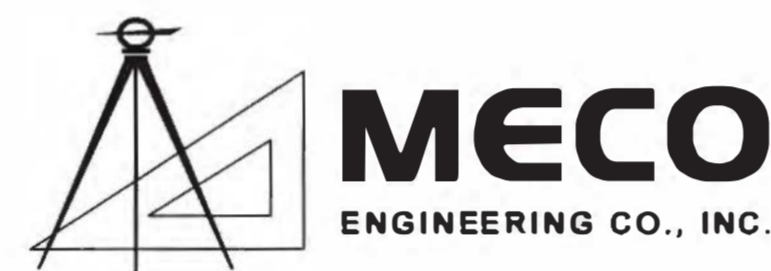
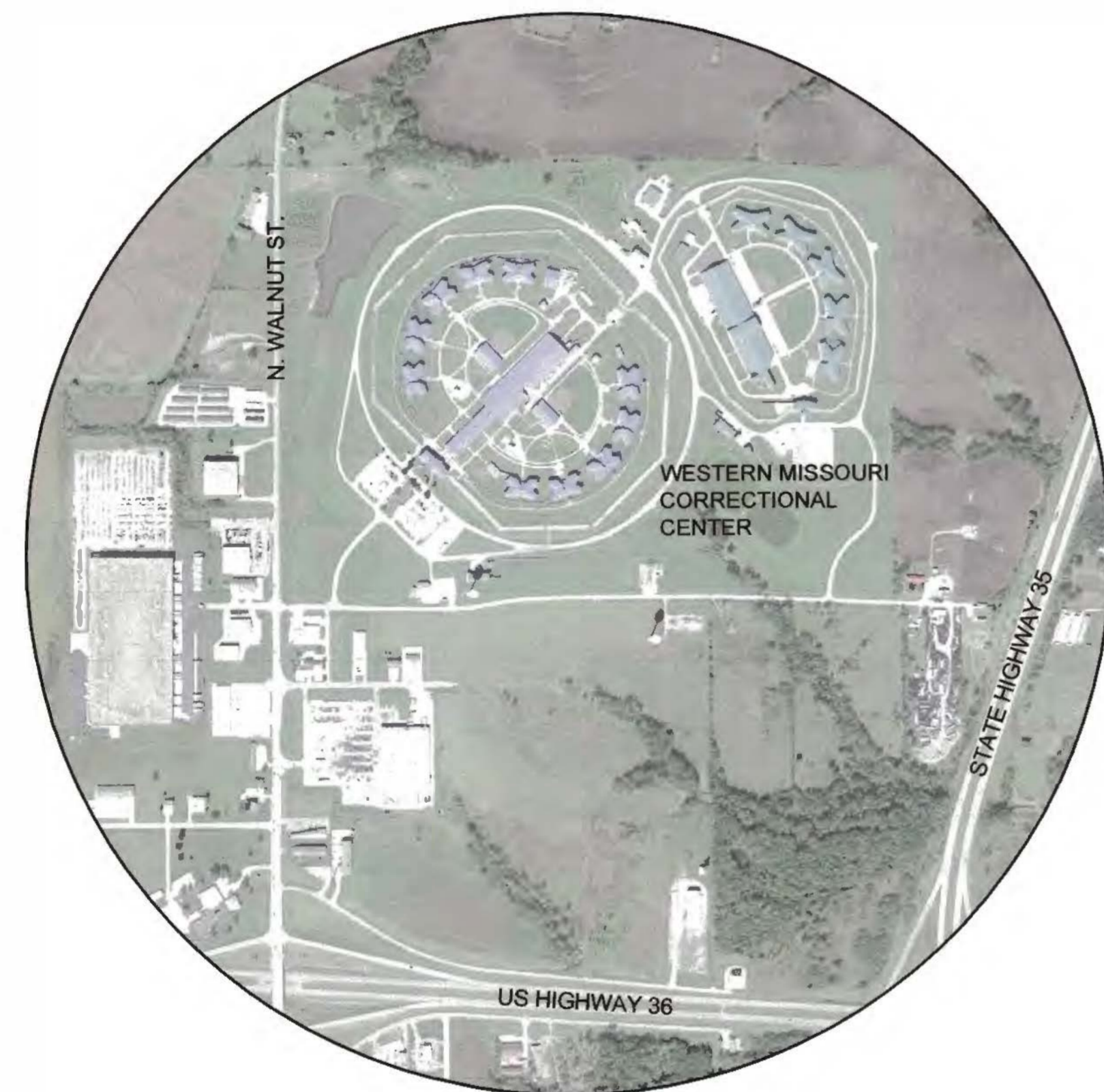

mecoengineering.com
MO Engineering Lic. #000898 - IL Design Firm #184-001749

OFFICE LOCATIONS
HANNIBAL, MO
JEFFERSON CITY, MO
BRANSON, MO
BOONVILLE, MO
PITTSFIELD, IL

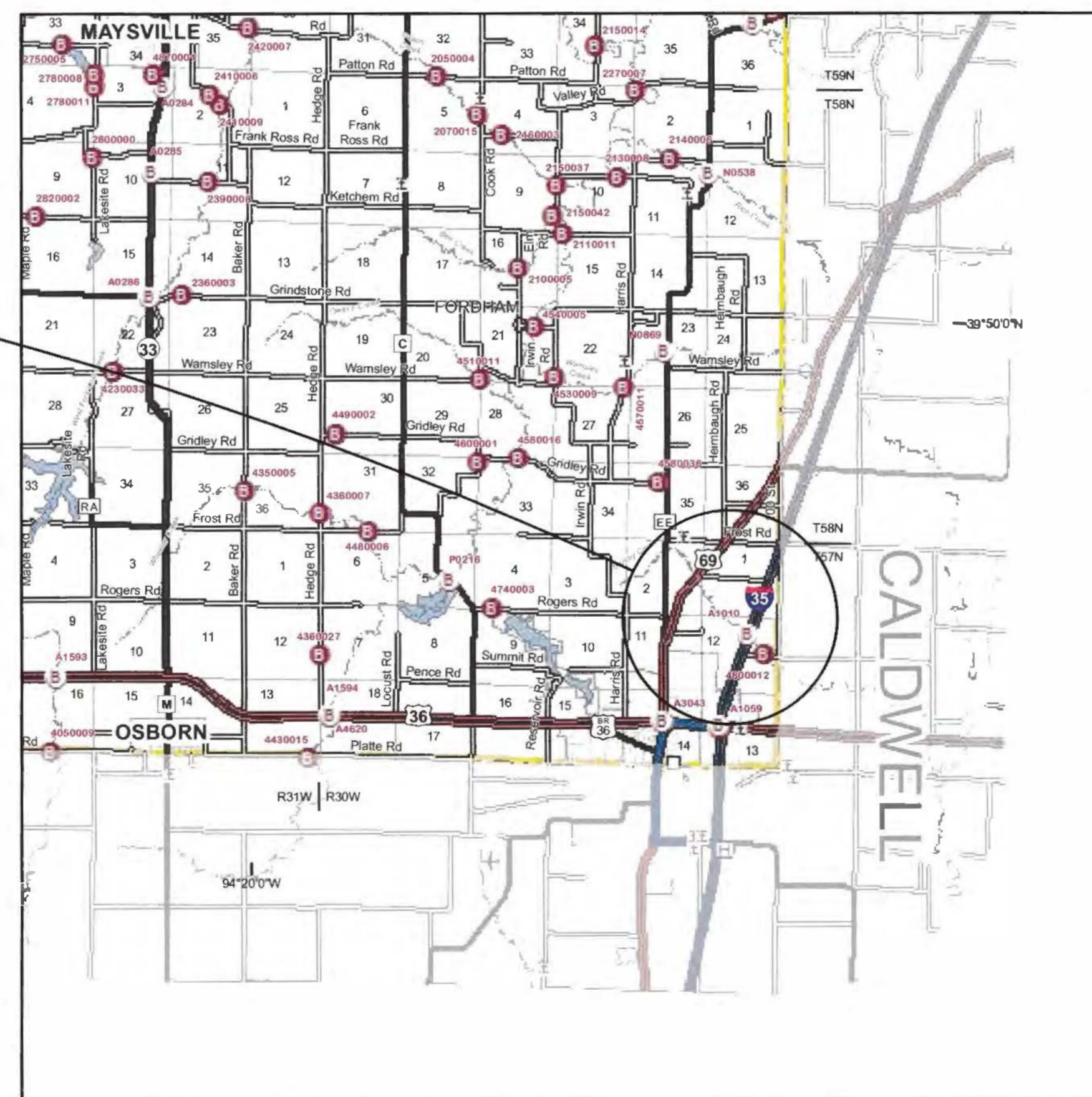

LOCATION MAP

INDEX OF SHEETS

SHEET NO.	SHEET DESCRIPTION
G-001	COVER SHEET / LOCATION MAP
C-101	EXISTING NORTHWEST STORM SEWER SITE CONDITION PLAN
C-102	EXISTING SOUTHEAST STORM SEWER SITE CONDITION PLAN
C-103	NORTHWEST STORM SEWER SITE PLAN BASE BID
C-104	SOUTHEAST STORM SEWER SITE PLAN ALTERNATE BID #1
C-105	NORTHWEST STORM SEWER PROFILES BASE BID
C-106	SOUTHEAST STORM SEWER PROFILES ALTERNATE BID #1
C-501	TYPICAL DETAILS

LEGEND / ABBREVIATIONS

	LIGHT POLE	STA. STATION
	POWER POLE	INV. INVERT
	EXISTING STORM SEWER STRUCTURE	EL. ELEVATION
	EXISTING MANHOLE	N NORTH
	PROPOSED MANHOLE	S SOUTH
	EXISTING STORM SEWER LINE	E EAST
	PROPOSED STORM SEWER LINE	W WEST
	EXISTING UNDERGROUND ELECTRIC	NW NORTHWEST
	EXISTING CHAIN LINK FENCE	NE NORTHEAST
	EXISTING ELECTRIC BORDER WIRE	SW SOUTHWEST
	PROPOSED SILT FENCE	SE SOUTHEAST
	EXISTING EDGE OF ASPHALT	M.H. MANHOLE
	EXISTING CONTOURS	I.D. INSIDE DIAMETER
	EXISTING GRAVE SURFACING	T.O. TOP OF
		T.B.M. TEMPORARY BENCHMARK
		CONC. CONCRETE
		TYP. TYPICAL

OWNER: STATE OF MISSOURI
MICHAEL L. PARSON, GOVERNOR
DEPARTMENT OF CORRECTIONS

PROJECT MANAGEMENT: OFFICE OF ADMINISTRATION
DIVISION OF FACILITIES MANAGEMENT,
DESIGN AND CONSTRUCTION

DESIGNER: MECO ENGINEERING COMPANY INC.

PROJECT NUMBER: C2223-03

SITE NUMBER: 7011
ASSET NUMBER: 9327011049

MISSOURI STATE CERTIFICATE OF AUTHORITY: 00273655



MAX F. MIDDENDORF
PROFESSIONAL ENGINEER
LICENSE NO. E-26008

SHEET NUMBER:

G-001

1 OF 8 SHEETS
SEPTEMBER 26, 2023

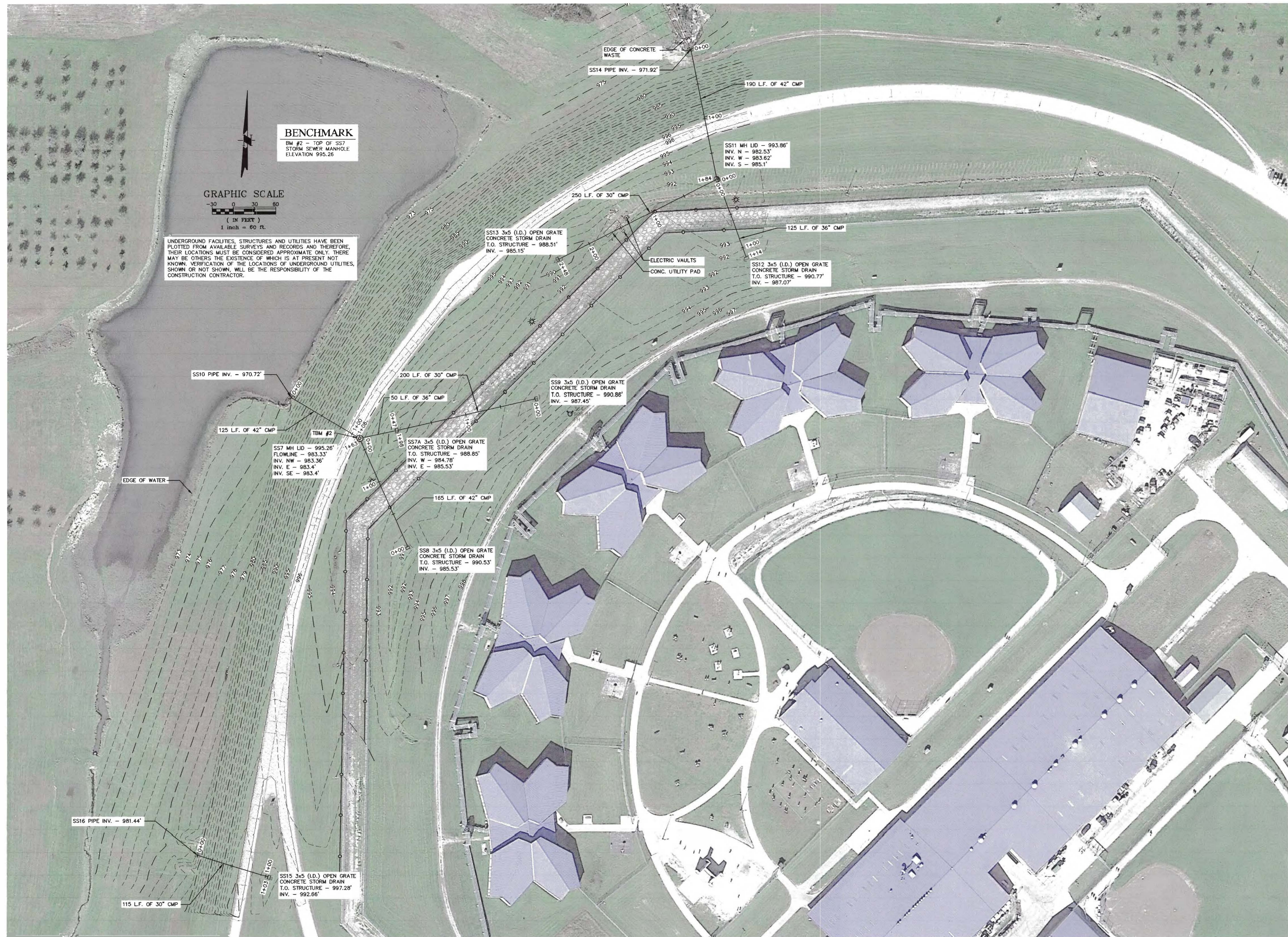

MAX F. MIDDENDORF
 PROFESSIONAL ENGINEER
 LICENSE NO. E-26008

OFFICE LOCATIONS
 HANBIBAL, MO.
 ST. LOUIS, MO.
 BRANSON, MO.
 BOONVILLE, MO.
 PITTSFIELD, IL.

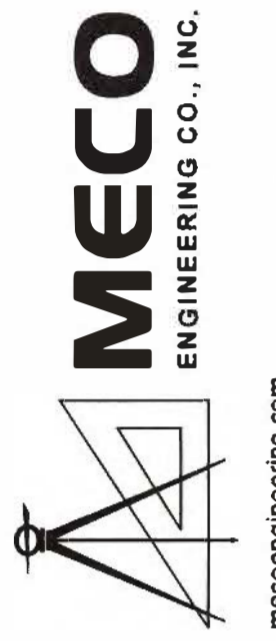

mecoenr.com
 MO Engineering Lic. #000898 - IL Design Firm #184-001749

OFFICE OF ADMINISTRATION
 DIVISION OF FACILITIES
 MANAGEMENT,
 DESIGN AND CONSTRUCTION

DEPARTMENT OF
 CORRECTIONS

STORM SEWER LINING

WESTERN MISSOURI
 CORRECTIONAL CENTER
 CAMERON, MISSOURI

PROJECT # C2223-03
 SITE # 7011
 ASSET # 9327011049

REVISION: _____
 DATE: _____
 REVISION: _____
 DATE: _____
 REVISION: _____
 DATE: _____
 ISSUE DATE: 09/26/2023

CAD DWG FILE: ?
 DRAWN BY: R.HAYES
 CHECKED BY: B.MARTIN
 DESIGNED BY: B.MARTIN

SHEET TITLE:
 EXISTING NORTHWEST
 STORM SEWER SITE
 CONDITION PLAN

SHEET NUMBER:

C-101

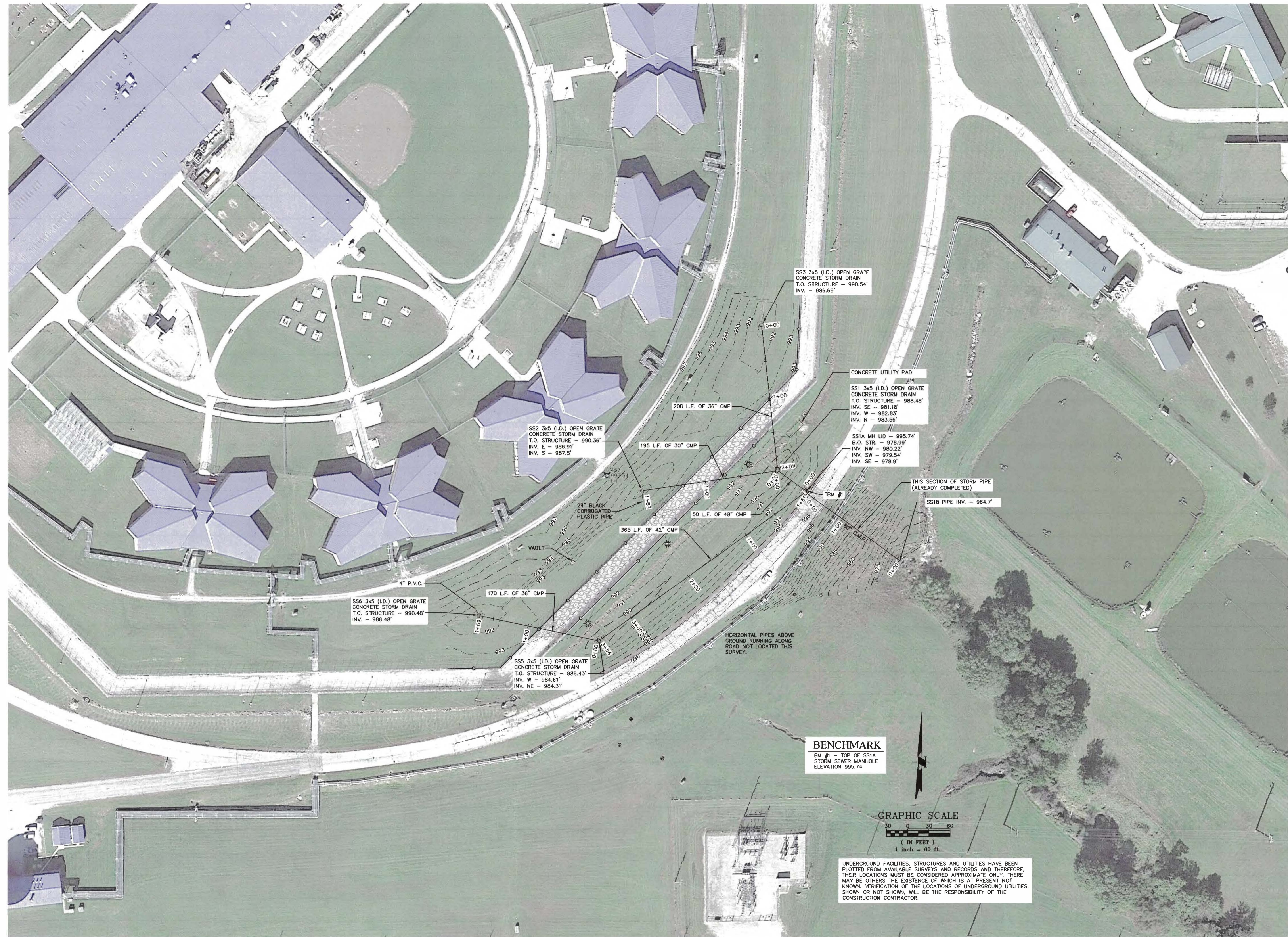

STATE OF MISSOURI
 MICHAEL L. PARSON,
 GOVERNOR



MAX F. MIDDENDORF
 PROFESSIONAL ENGINEER
 LICENSE NO. E-26008

OFFICE LOCATIONS
 HANBIBAL, MO
 SPRINGFIELD, MO
 BECKVILLE, MO
 BOONVILLE, MO
 PITTSFIELD, IL



OFFICE OF ADMINISTRATION
 DIVISION OF FACILITIES
 MANAGEMENT,
 DESIGN AND CONSTRUCTION

DEPARTMENT OF
 CORRECTIONS

STORM SEWER LINING

WESTERN MISSOURI
 CORRECTIONAL CENTER
 CAMERON, MISSOURI

PROJECT # C2223-03
 SITE # 7011
 ASSET # 9327011049

REVISION: _____
 DATE: _____
 REVISION: _____
 DATE: _____
 REVISION: _____
 DATE: _____
 ISSUE DATE: 09/26/2023

CAD DWG FILE: ?
 DRAWN BY: R.HAYES
 CHECKED BY: B.MARTIN
 DESIGNED BY: B.MARTIN

SHEET TITLE:
 EXISTING SOUTHEAST
 STORM SEWER SITE
 CONDITION PLAN

SHEET NUMBER:

C-102

SHEET 3 OF 8
 SEPTEMBER 26, 2023

BENCHMARK
 BM #1 - TOP OF SS1A
 STORM SEWER MANHOLE
 ELEVATION 995.74



UNDERGROUND FACILITIES, STRUCTURES AND UTILITIES HAVE BEEN PLOTTED FROM AVAILABLE SURVEYS AND RECORDS AND THEREFORE, THEIR LOCATIONS MUST BE CONSIDERED APPROXIMATE ONLY. THERE MAY BE OTHERS THE EXISTENCE OF WHICH IS AT PRESENT NOT KNOWN. VERIFICATION OF THE LOCATIONS OF UNDERGROUND UTILITIES, SHOWN OR NOT SHOWN, WILL BE THE RESPONSIBILITY OF THE CONSTRUCTION CONTRACTOR.

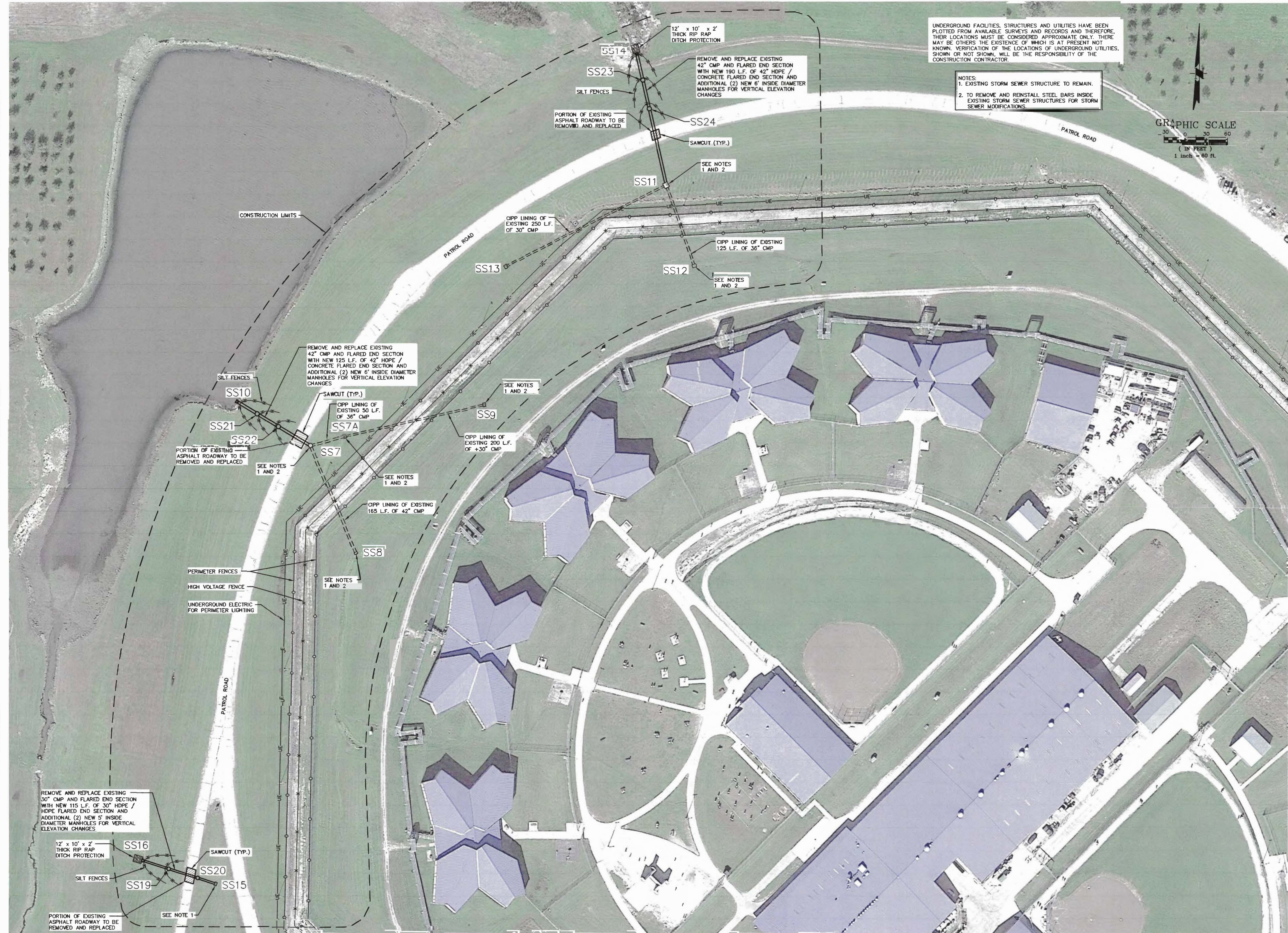

UNDERGROUND FACILITIES, STRUCTURES AND UTILITIES HAVE BEEN PLOTTED FROM AVAILABLE SURVEYS AND RECORDS AND THEREFORE, THEIR LOCATIONS MUST BE CONSIDERED APPROXIMATE ONLY. THERE MAY BE OTHERS THE EXISTENCE OF WHICH IS AT PRESENT NOT KNOWN. VERIFICATION OF THE LOCATIONS OF UNDERGROUND UTILITIES, SHOWN OR NOT SHOWN, WILL BE THE RESPONSIBILITY OF THE CONSTRUCTION CONTRACTOR.

- NOTES:
- EXISTING STORM SEWER STRUCTURE TO REMAIN.
 - TO REMOVE AND REINSTALL STEEL BARS INSIDE EXISTING STORM SEWER STRUCTURES FOR STORM SEWER MODIFICATIONS.

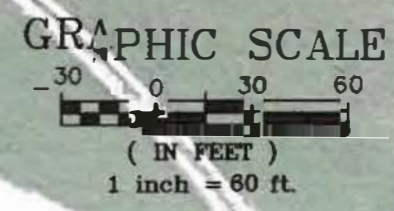

STATE OF MISSOURI
MICHAEL L. PARSON,
GOVERNOR



MAX F. MIDDENDORF
PROFESSIONAL ENGINEER
LICENSE NO. E-26008

OFFICE LOCATIONS
HANNIBAL, MO
JEFFERSON CITY, MO
BRANSON, MO
BOONVILLE, MO
PITTSFIELD, IL



MECO ENGINEERING, INC.
ENR #44-00 1749
MO Engineering Lic. #0008 @ - I/Design Firm #04-00 1749

OFFICE OF ADMINISTRATION
DIVISION OF FACILITIES
MANAGEMENT,
DESIGN AND CONSTRUCTION

DEPARTMENT OF
CORRECTIONS

STORM SEWER LINING

WESTERN MISSOURI
CORRECTIONAL CENTER
CAMERON, MISSOURI

PROJECT # C2223-03
SITE # 7011
ASSET # 9327011049

REVISION: _____
DATE: _____
REVISION: _____
DATE: _____
REVISION: _____
DATE: _____
ISSUE DATE: 09/26/2023

CAD DWG FILE: _____
DRAWN BY: B.F. & R.H.
CHECKED BY: B.MARTIN
DESIGNED BY: B.MARTIN

SHEET TITLE:
NORTHWEST STORM
SEWER SITE PLAN
BASE BID

SHEET NUMBER:

C-103

SHEET 4 OF 8
SEPTEMBER 26, 2023

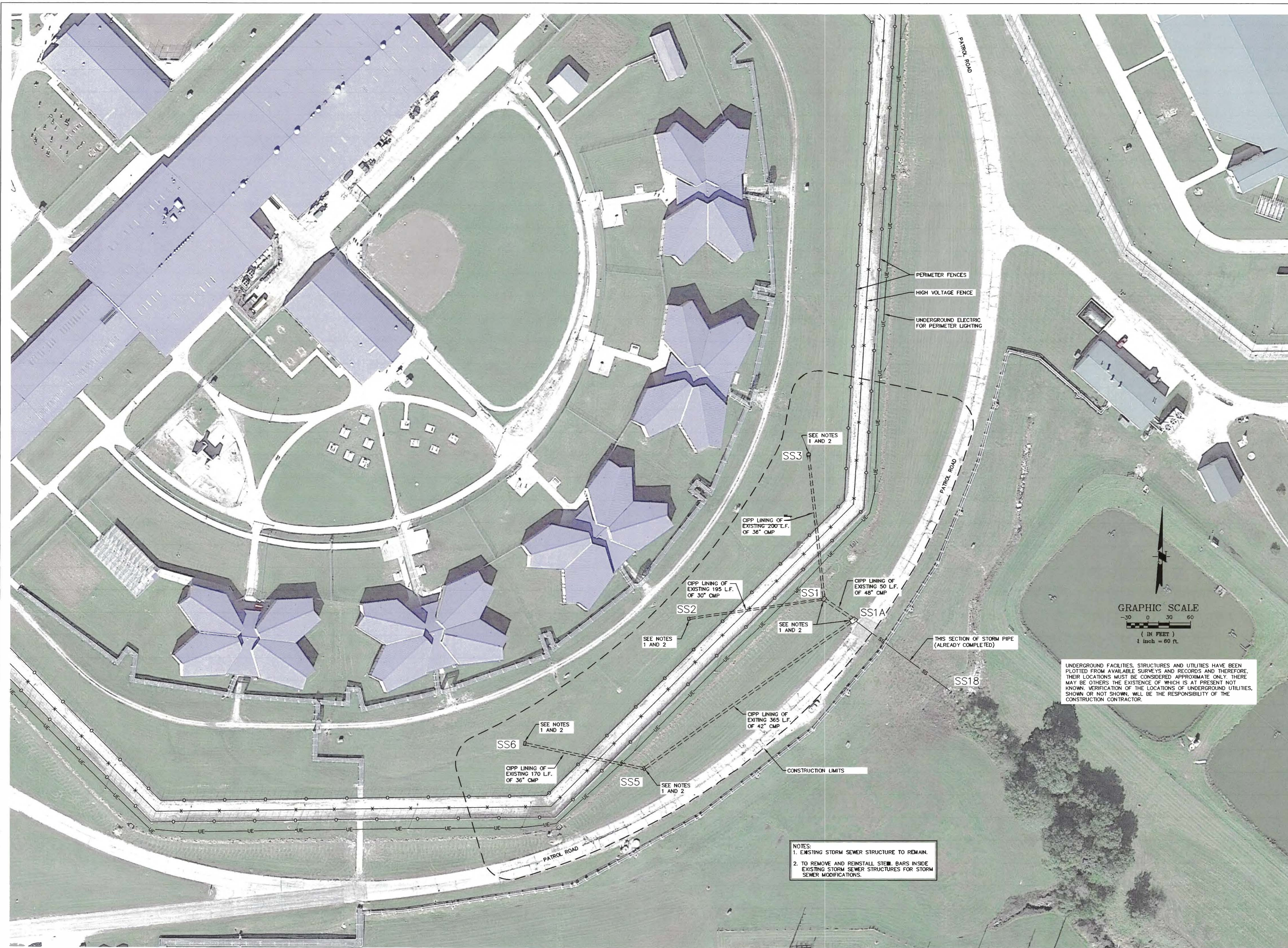

STATE OF MISSOURI
MICHAEL L. PARSON,
GOVERNOR



MAX F. MIDDENDORF
PROFESSIONAL ENGINEER
LICENSE NO. E-26008

OFFICE LOCATIONS
HANNIBAL, MO
JEFFERSON CITY, MO
BRANSON, MO
BOONVILLE, MO
PITTSFIELD, IL

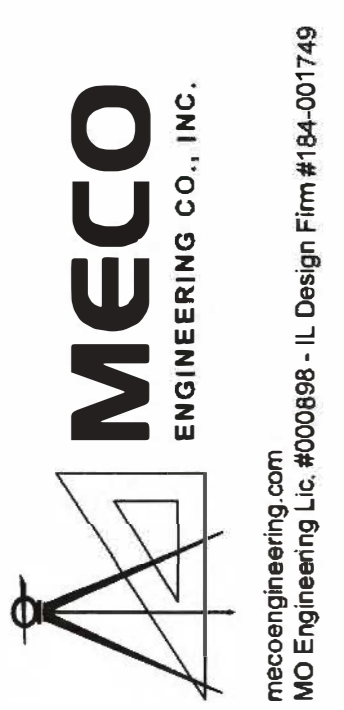

OFFICE OF ADMINISTRATION
DIVISION OF FACILITIES
MANAGEMENT,
DESIGN AND CONSTRUCTION

DEPARTMENT OF
CORRECTIONS

STORM SEWER LINING

WESTERN MISSOURI
CORRECTIONAL CENTER
CAMERON, MISSOURI

PROJECT # C2223-03
SITE # 7011
ASSET # 9327011049

REVISION: _____
DATE: _____
REVISION: _____
DATE: _____
REVISION: _____
DATE: _____
ISSUE DATE: 09/26/2023

CAD DWG FILE: ?
DRAWN BY: B.F. & R.H.
CHECKED BY: B.MARTIN
DESIGNED BY: B.MARTIN

SHEET TITLE:
SOUTHEAST STORM
SEWER SITE PLAN'
ALTERNATE BID #1

SHEET NUMBER:

C-104

SHEET 5 OF 8
SEPTEMBER 26, 2023

UNDERGROUND FACILITIES, STRUCTURES AND UTILITIES HAVE BEEN PLOTTED FROM AVAILABLE SURVEYS AND RECORDS AND THEREFORE, THEIR LOCATIONS MUST BE CONSIDERED APPROXIMATE ONLY. THERE MAY BE OTHERS THE EXISTENCE OF WHICH IS AT PRESENT NOT KNOWN. VERIFICATION OF THE LOCATIONS OF UNDERGROUND UTILITIES, SHOWN OR NOT SHOWN, WILL BE THE RESPONSIBILITY OF THE CONSTRUCTION CONTRACTOR.

NOTES:
1. EXISTING STORM SEWER STRUCTURE TO REMAIN.
2. TO REMOVE AND REINSTALL STEEL BARS INSIDE EXISTING STORM SEWER STRUCTURES FOR STORM SEWER MODIFICATIONS.

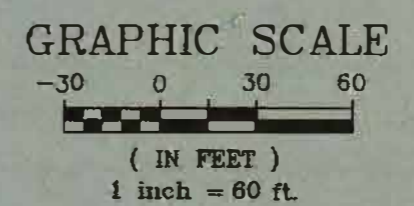

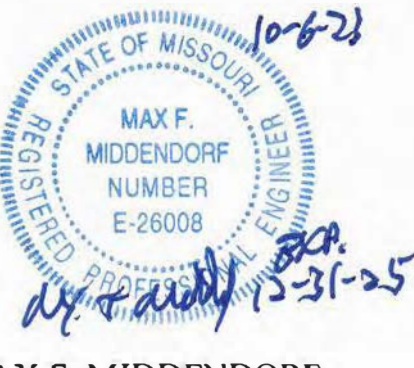

MAX F. MIDDENDORF
PROFESSIONAL ENGINEER
LICENSE NO. E-26008

OFFICE LOCATIONS
HANNIBAL, MO
JEFFERSON CITY, MO
BRANSON, MO
BOONVILLE, MO
PITTSFIELD, IL

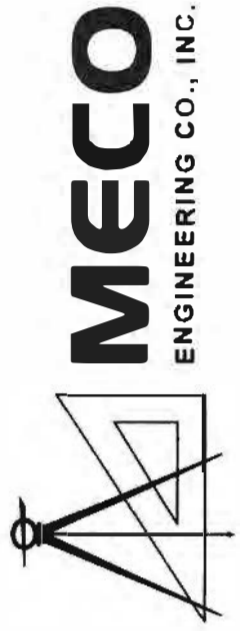

meceoengineering.com
MO Engineering Lic. #000898 - IL Design Firm #184-001749

OFFICE OF ADMINISTRATION
DIVISION OF FACILITIES
MANAGEMENT,
DESIGN AND CONSTRUCTION

DEPARTMENT OF
CORRECTIONS

STORM SEWER LINING

WESTERN MISSOURI
CORRECTIONAL CENTER
CAMERON, MISSOURI

PROJECT # C2223-03
SITE # 7011
ASSET # 9327011049

REVISION:
DATE: _____
REVISION:
DATE: _____
REVISION:
DATE: _____
REVISION:
DATE: _____
ISSUE DATE: 09/26/2023

CAD DWG FILE: ?
DRAWN BY: R.HAYES
CHECKED BY: B.MARTIN
DESIGNED BY: B.MARTIN

SHEET TITLE:
NORTHWEST
STORM SEWER
PROFILES
BASE BID

SHEET NUMBER:

C105

SHEET 6 OF 8 SEPTEMBER
26, 2023

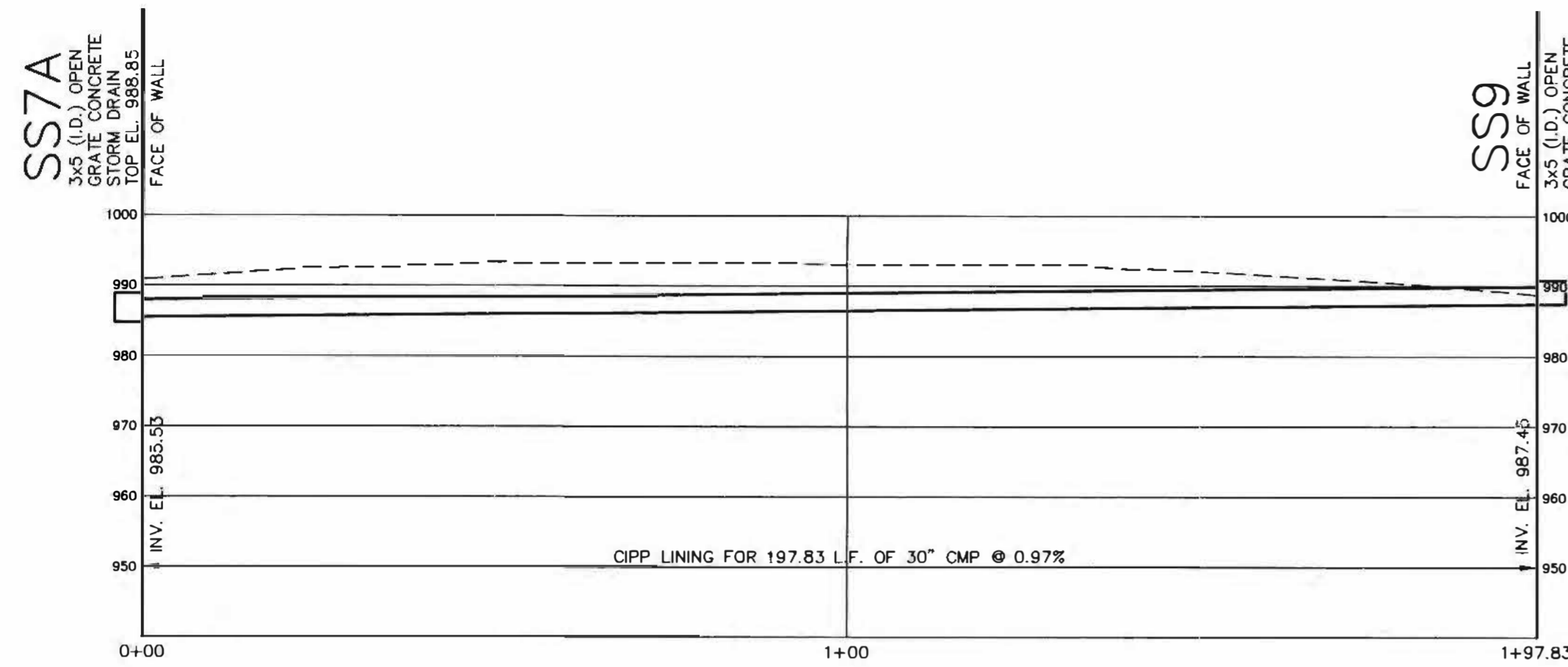

SS7A TO SS9

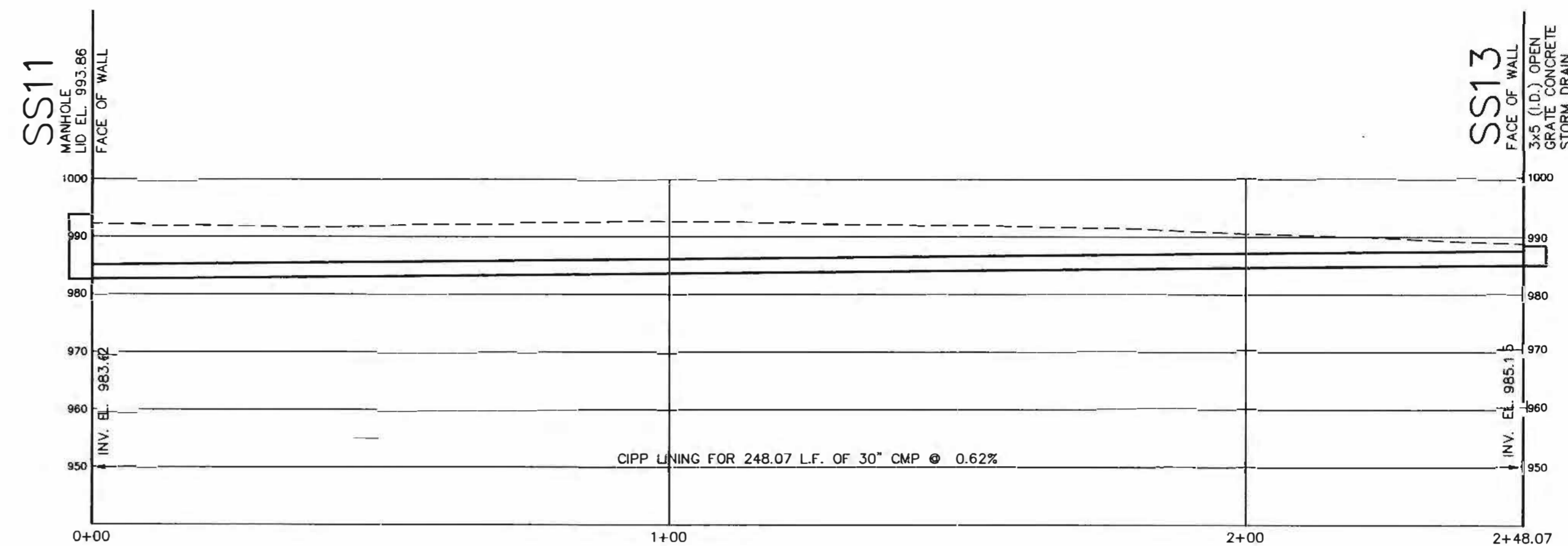

SS11 TO SS13

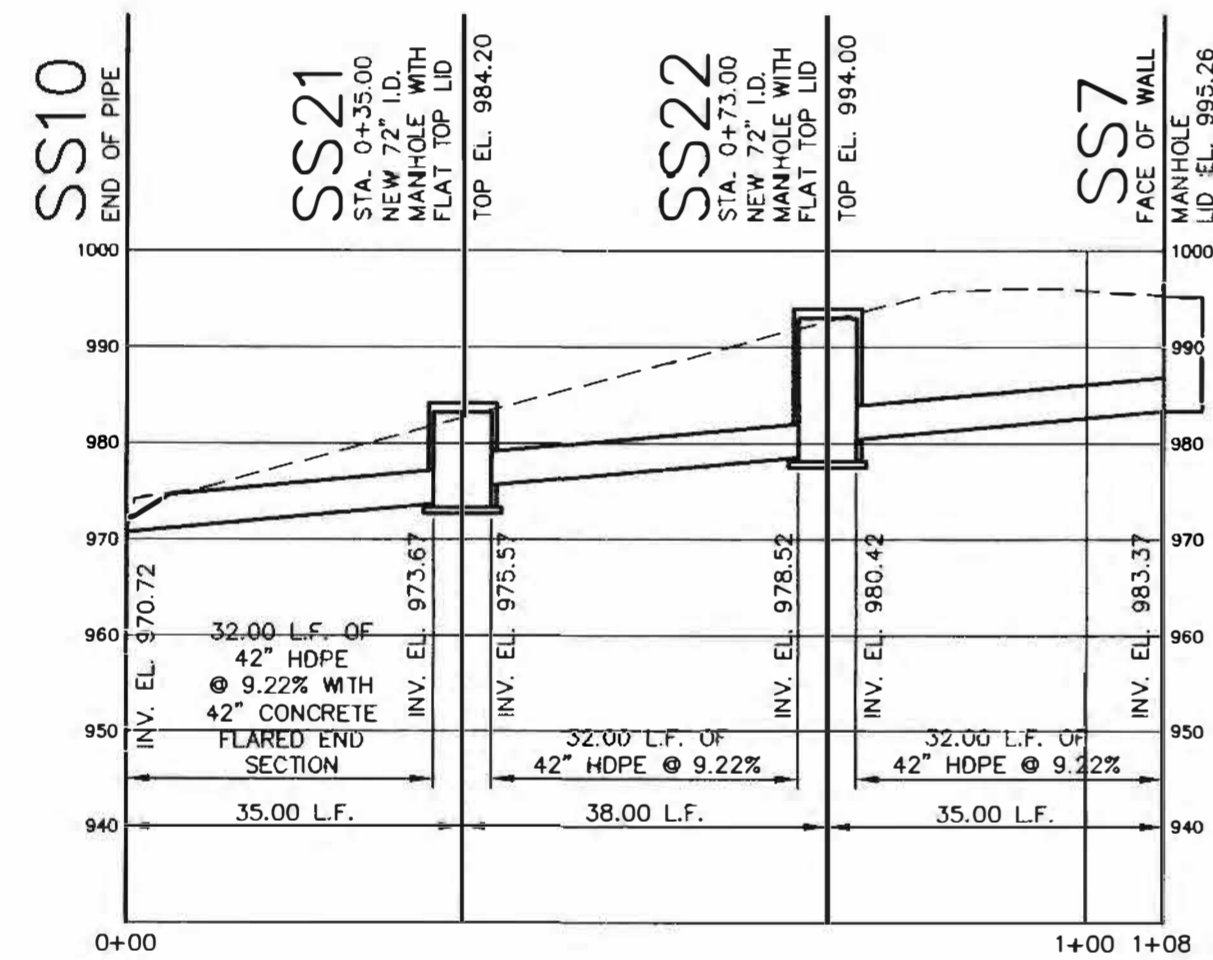

SS10 TO SS7

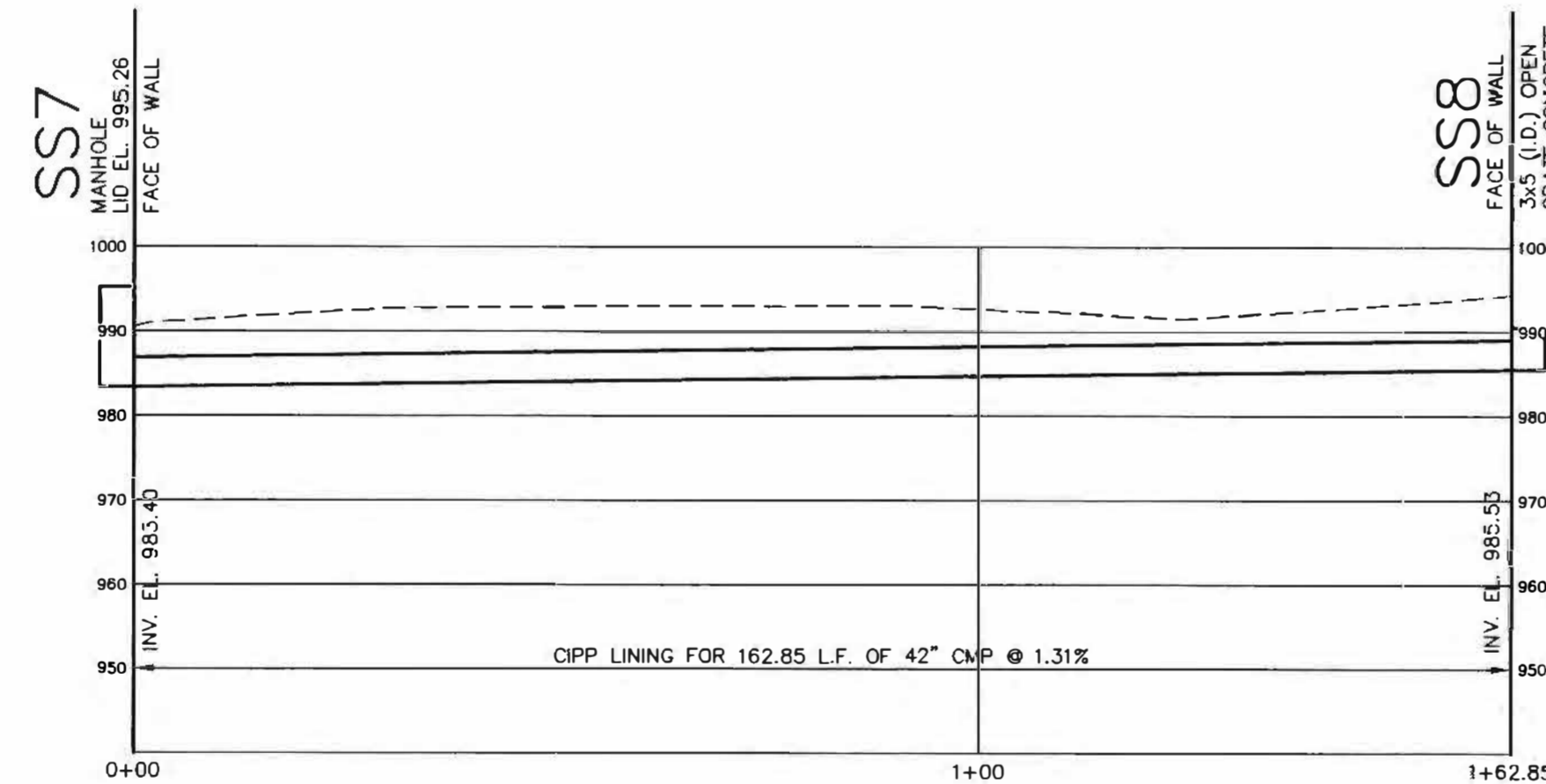

SS7 TO SS8

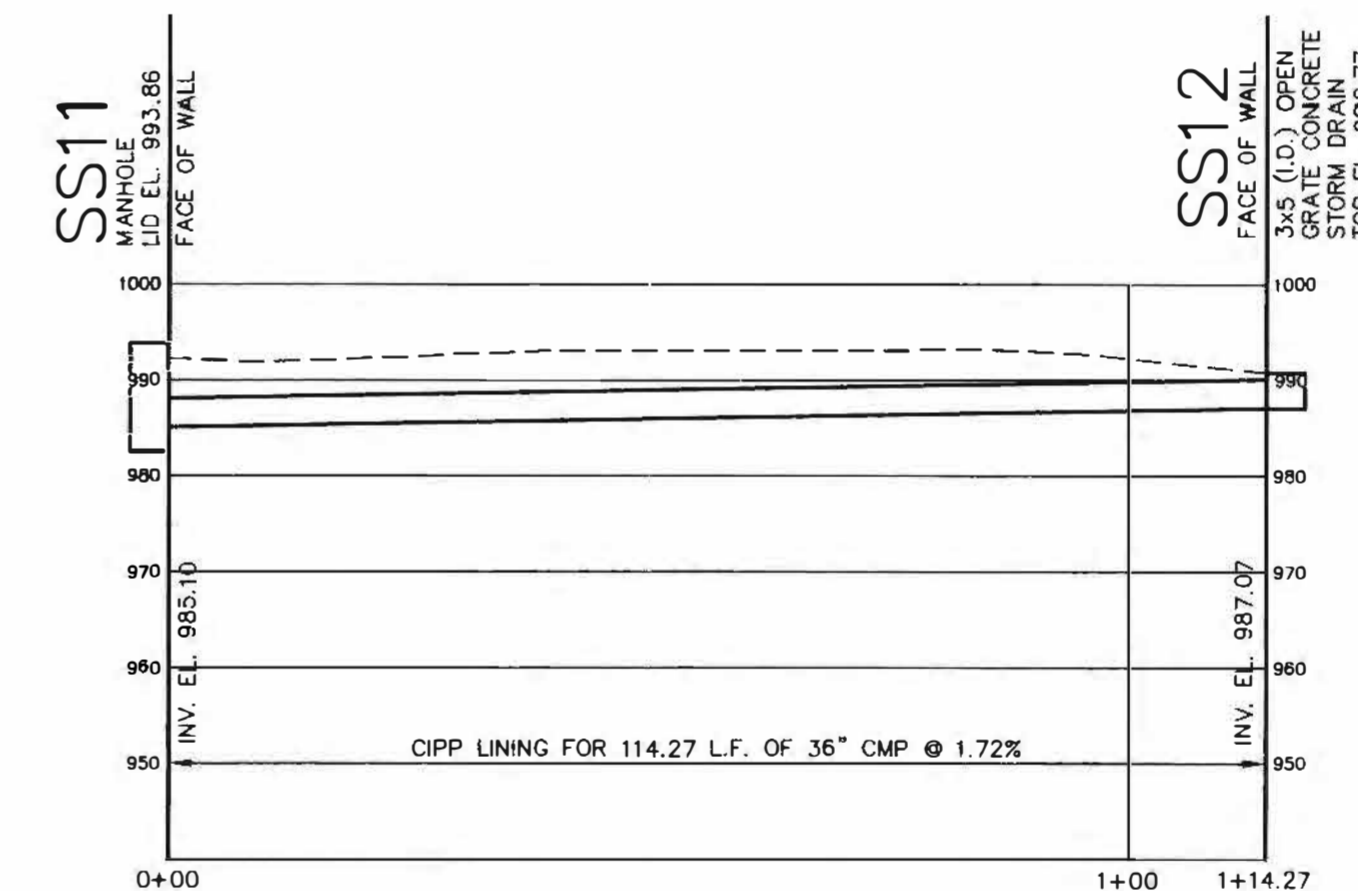

SS11 TO SS12

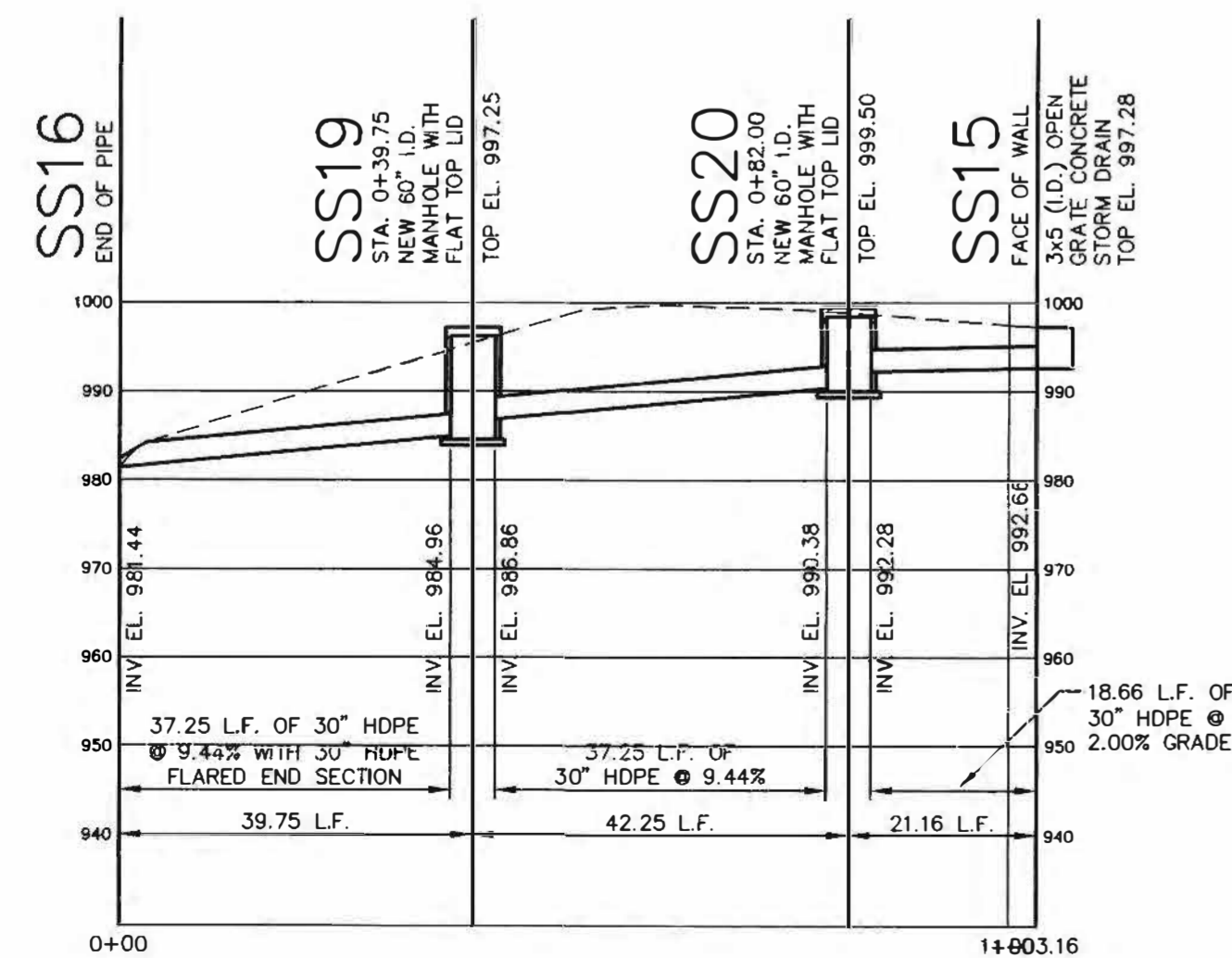

SS16 TO SS15

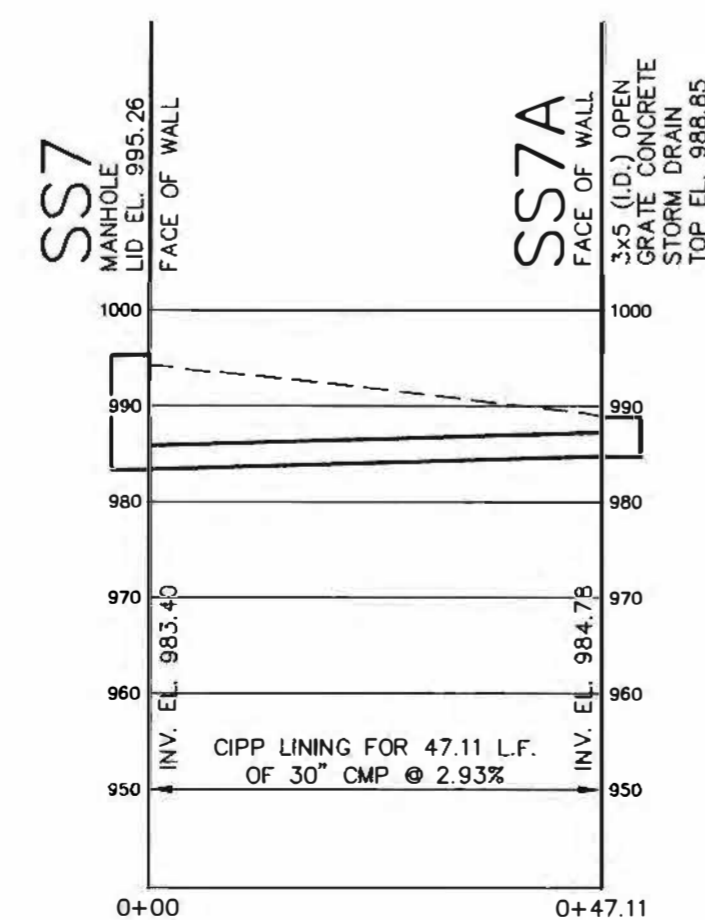

SS7 TO SS7A

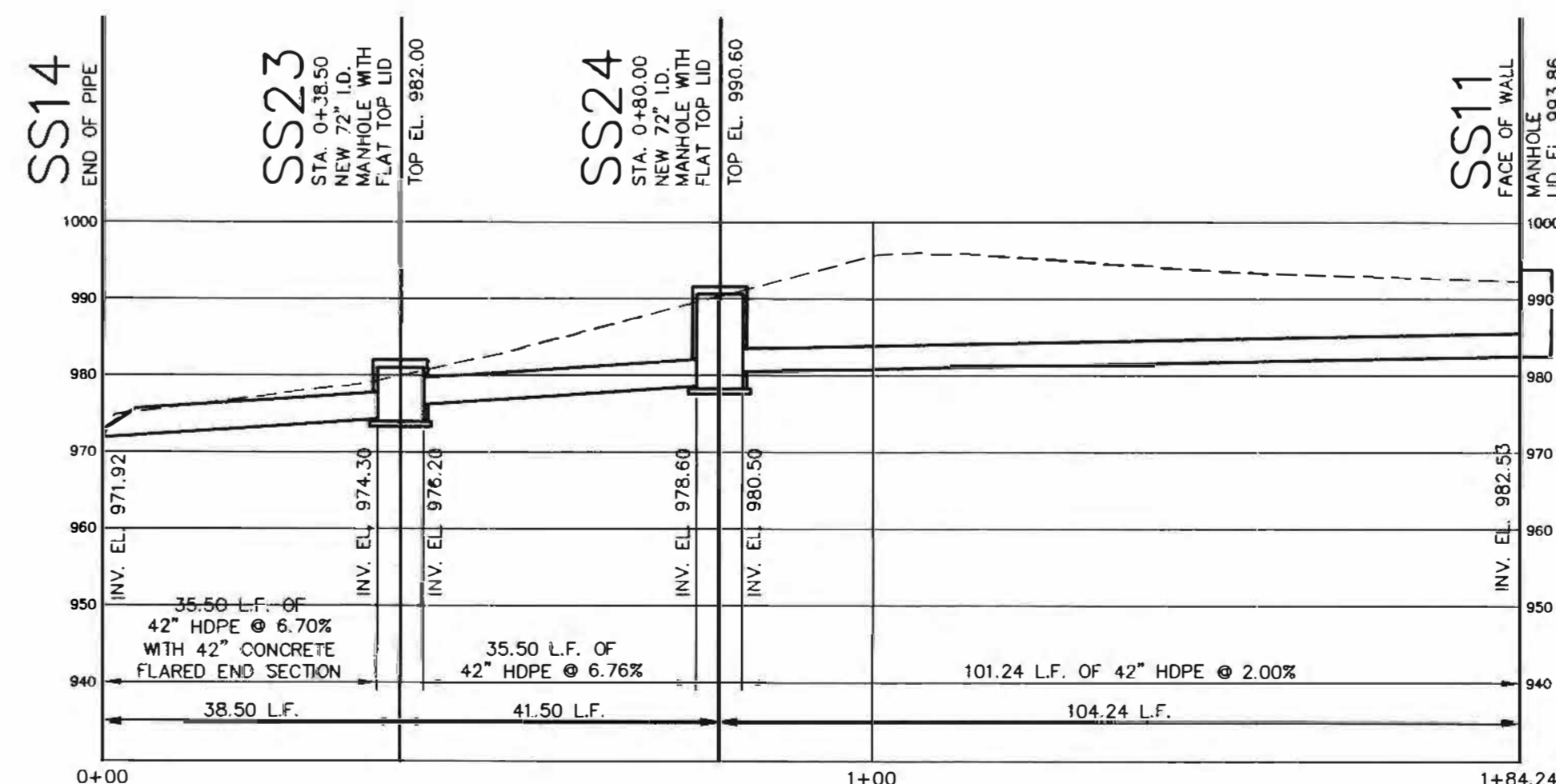

SS14 TO SS11

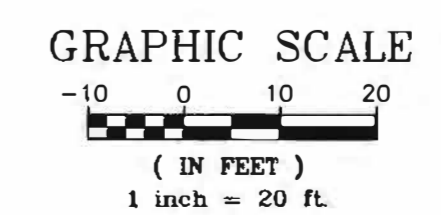

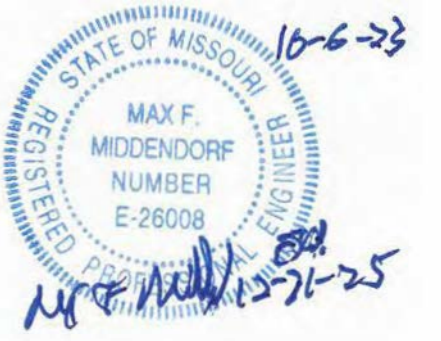

MAX F. MIDDENDORF
PROFESSIONAL ENGINEER
LICENSE NO. E-26008

OFFICE LOCATIONS
HANNIBAL, MO
JEFFERSON CITY, MO
JEFFERSON CITY, MO
BOONVILLE, MO
PITTSFIELD, IL



meceengineering.com
MO Engineering Lic. #000898 - IL Design Firm #184-001749

OFFICE OF ADMINISTRATION
DIVISION OF FACILITIES
MANAGEMENT,
DESIGN AND CONSTRUCTION

DEPARTMENT OF
CORRECTIONS

STORM SEWER LINING

WESTERN MISSOURI
CORRECTIONAL CENTER
CAMERON, MISSOURI

PROJECT # C2223-03
SITE # 7011
ASSET # 9327011049

REVISION: _____
DATE: _____
REVISION: _____
DATE: _____
REVISION: _____
DATE: _____
ISSUE DATE: 09/26/2023

CAD DWG FILE: ?
DRAWN BY: R.HAYES
CHECKED BY: B.MARTIN
DESIGNED BY: B.MARTIN

SHEET TITLE:
SOUTHEAST
STORM SEWER
PROFILES
ALTERNATE BID #1

SHEET NUMBER:

C-106

SHEET 7 OF 8
SEPTEMBER 26, 2023

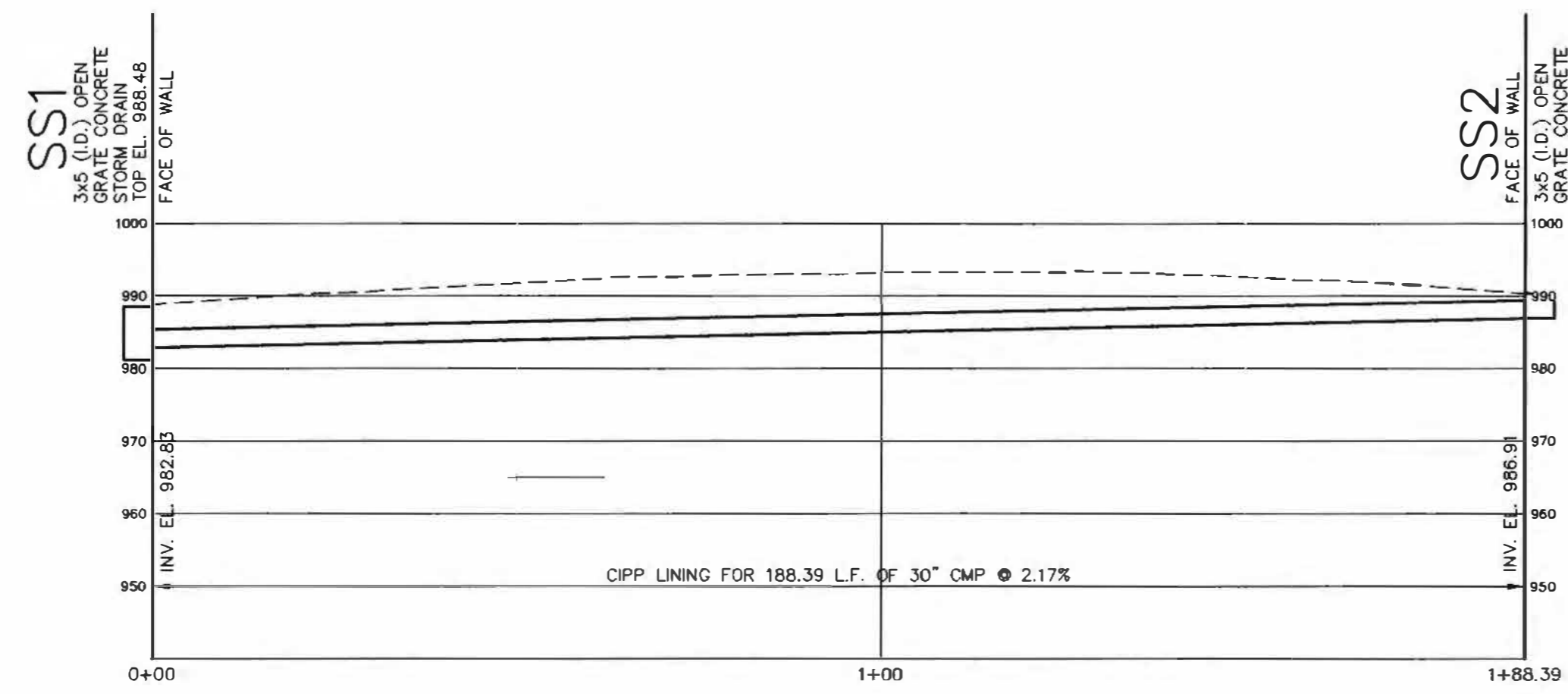

SS1 TO SS2

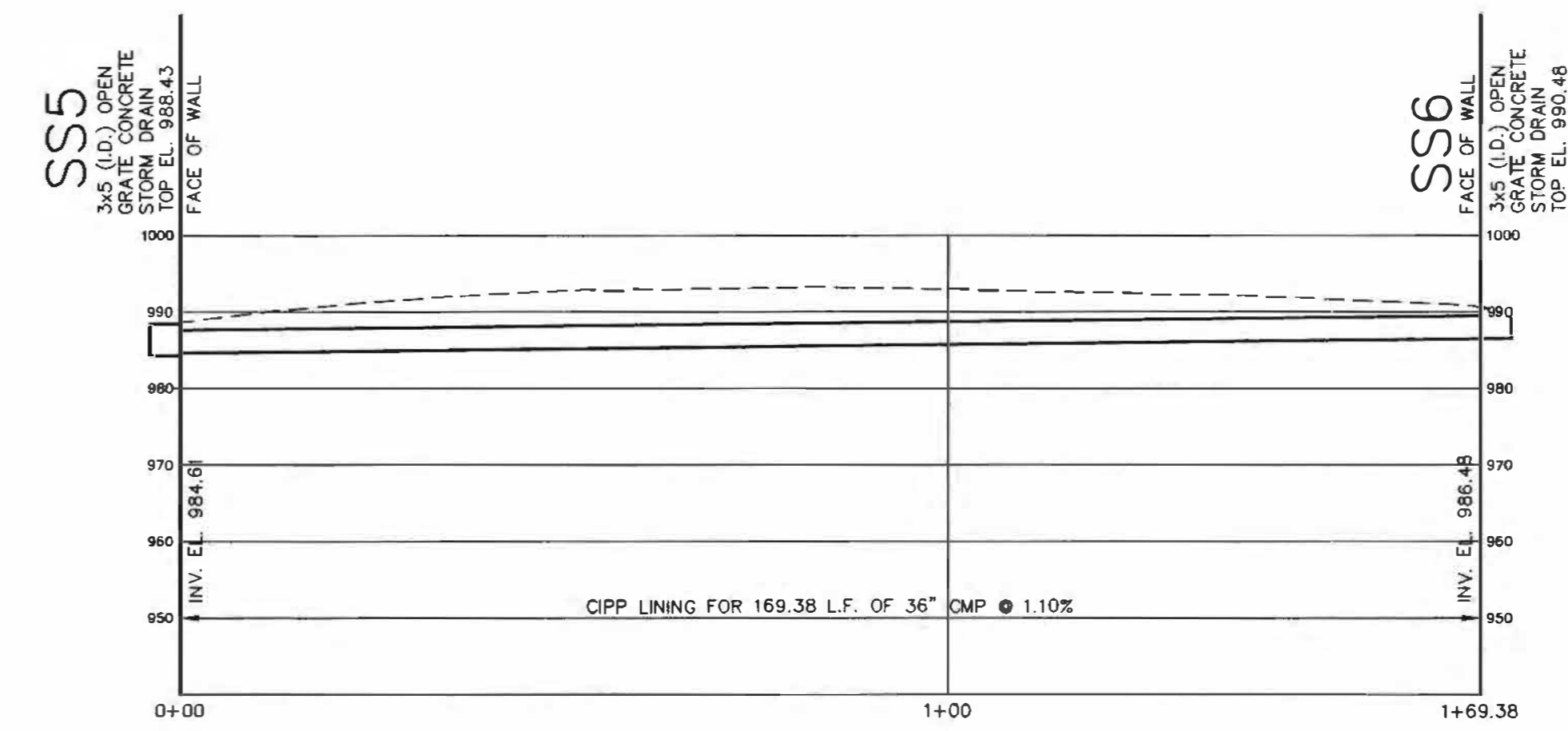

SS5 TO SS6

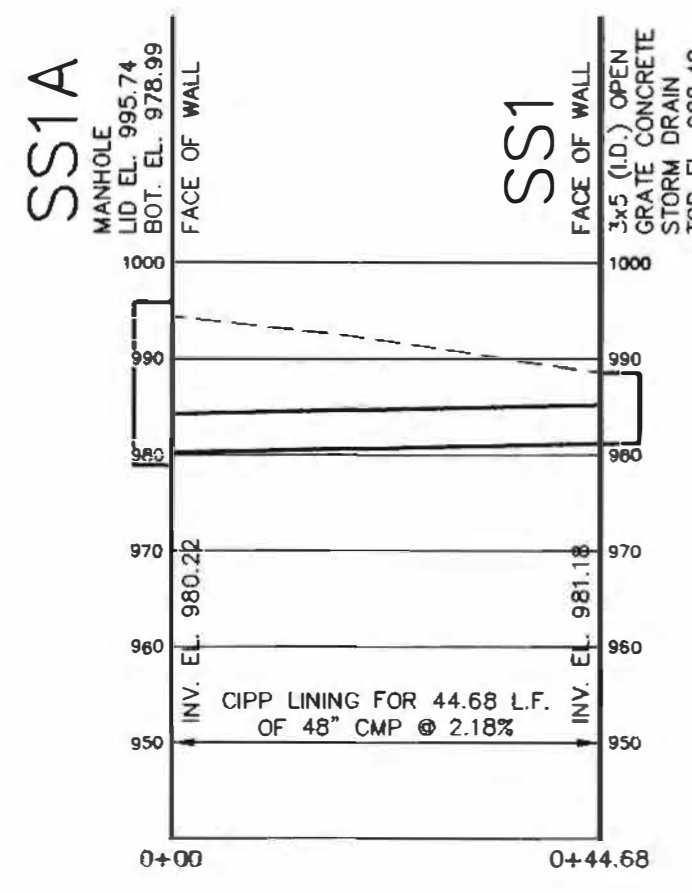

SS1A TO SS1

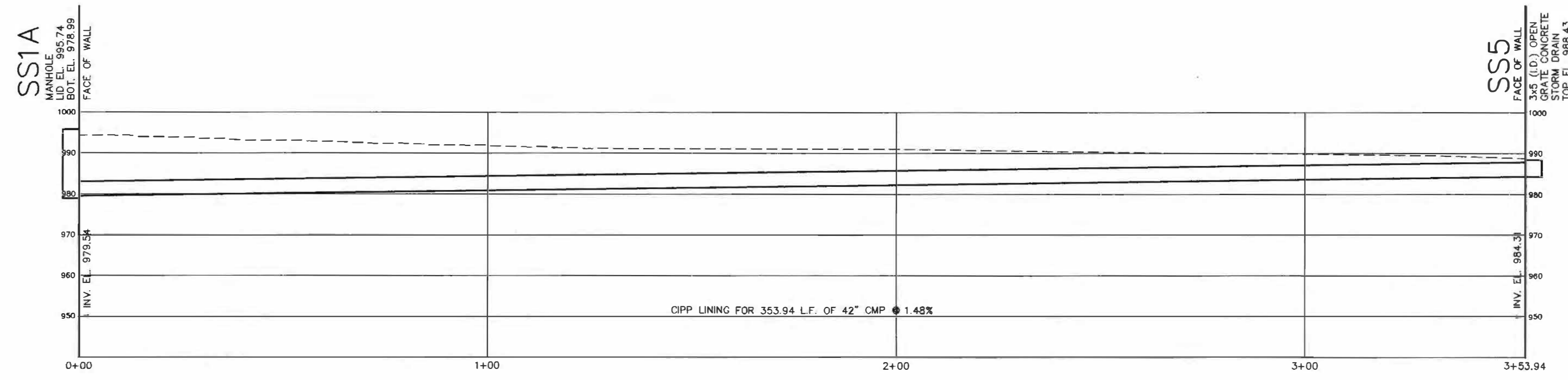

SS1A TO SS5

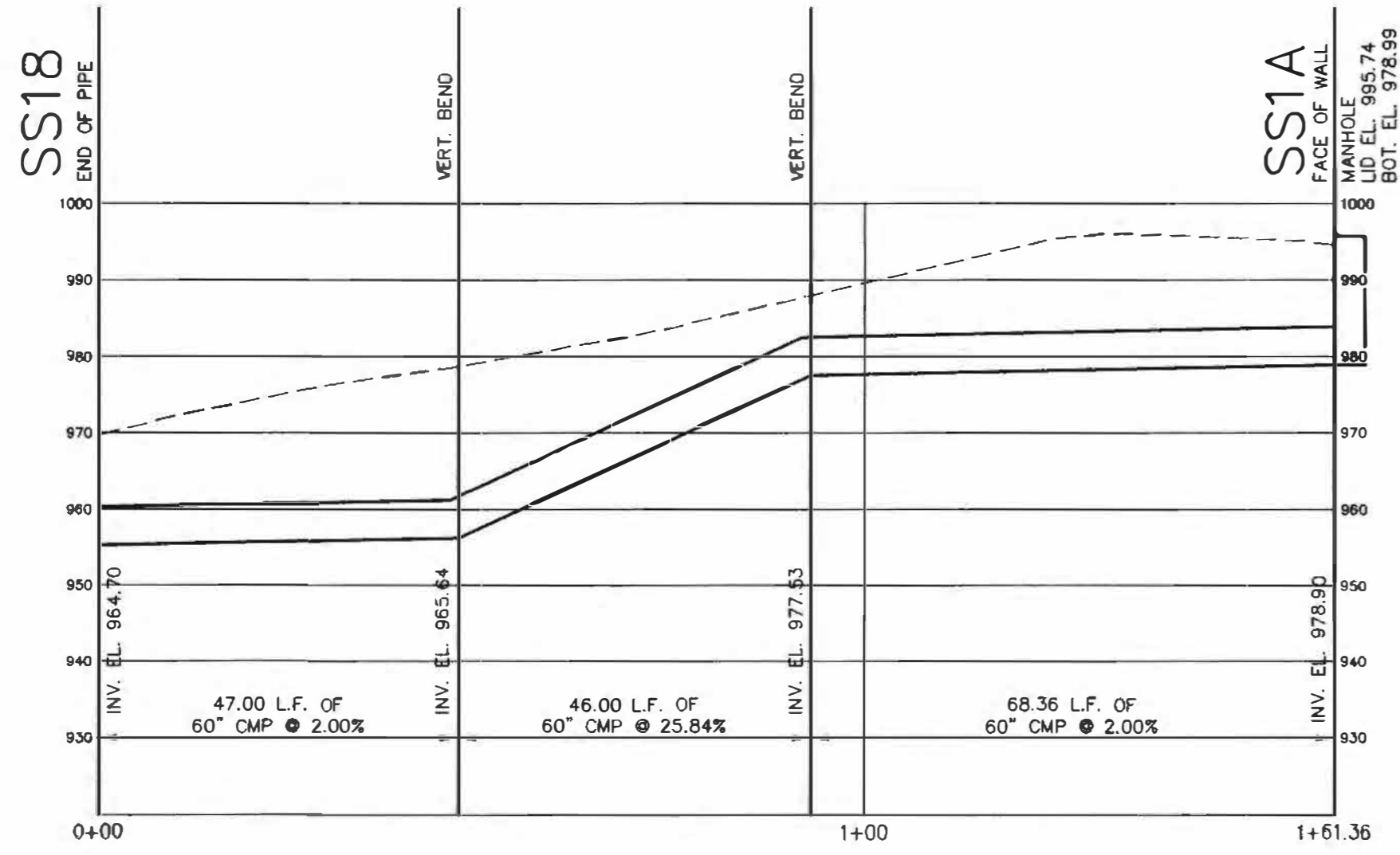

SS18 TO SS1A

THIS SECTION OF STORM PIPE
(ALREADY COMPLETED)

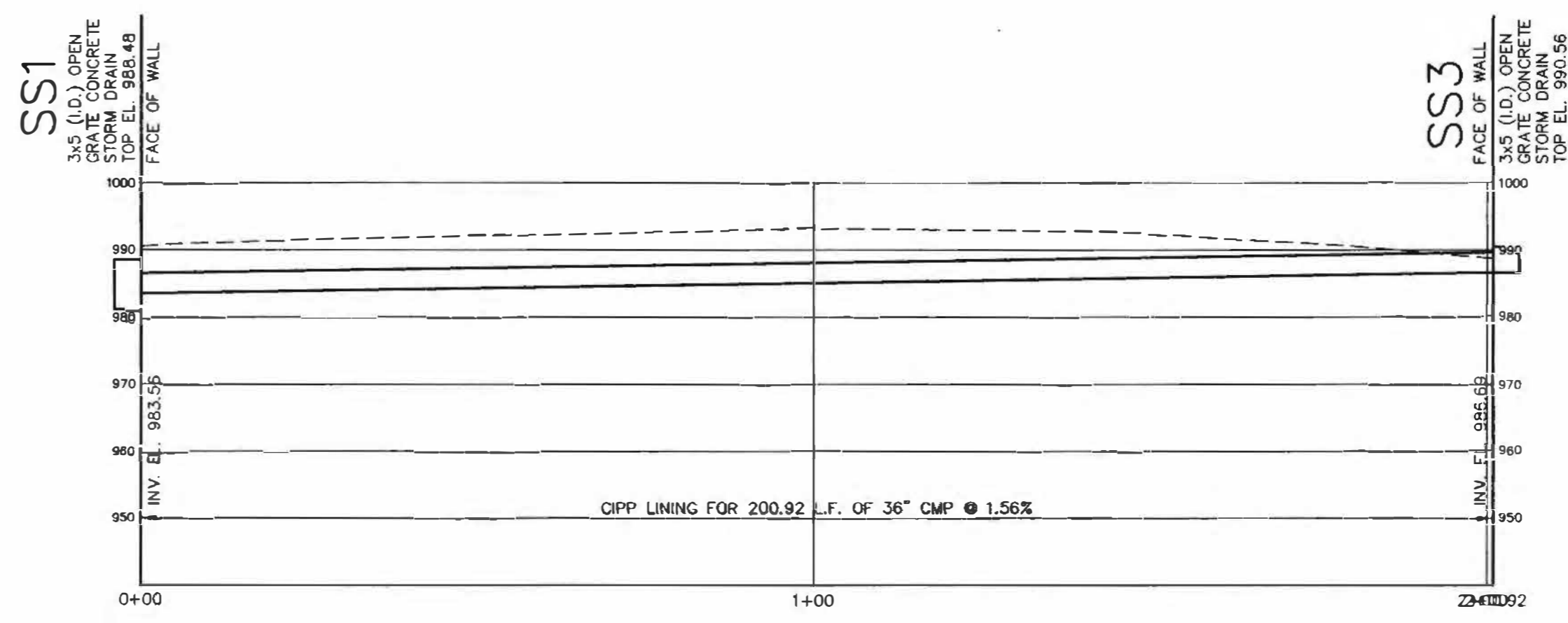

SS1 TO SS3

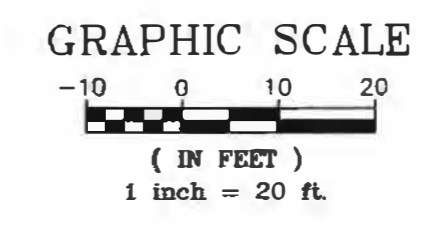

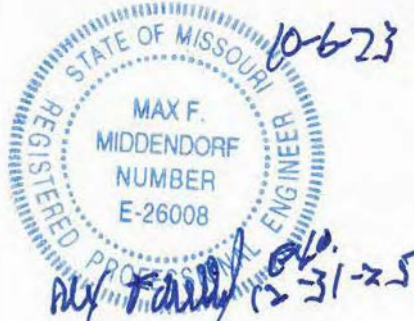

MAX F. MIDDENDORF
PROFESSIONAL ENGINEER
LICENSE NO. E-26008

OFFICE LOCATIONS
HAMBURG, MO.
JEFFERSON, MO.
BRANSON, MO.
BOONVILLE, MO.
PITTSFIELD, IL

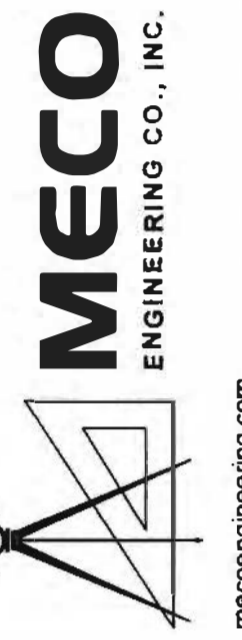

meceengineering.com
MO Engineering Lic. #00889 - IL Design Firm #B4-001749

OFFICE OF ADMINISTRATION
DIVISION OF FACILITIES
MANAGEMENT,
DESIGN AND CONSTRUCTION

DEPARTMENT OF
CORRECTIONS

STORM SEWER LINING

WESTERN MISSOURI
CORRECTIONAL CENTER
CAMERON, MISSOURI

PROJECT # C2223-03
SITE # 7011
ASSET # 9327011049

REVISION: _____
DATE: _____
REVISION: _____
DATE: _____
REVISION: _____
DATE: _____
ISSUE DATE: 09/26/2023

CAD DWG FILE: ?
DRAWN BY: R.HAYES
CHECKED BY: B.MARTIN
DESIGNED BY: B.MARTIN

SHEET TITLE:
TYPICAL DETAILS

SHEET NUMBER:

C501

SHEET 8 OF 8
SEPTEMBER 26, 2023

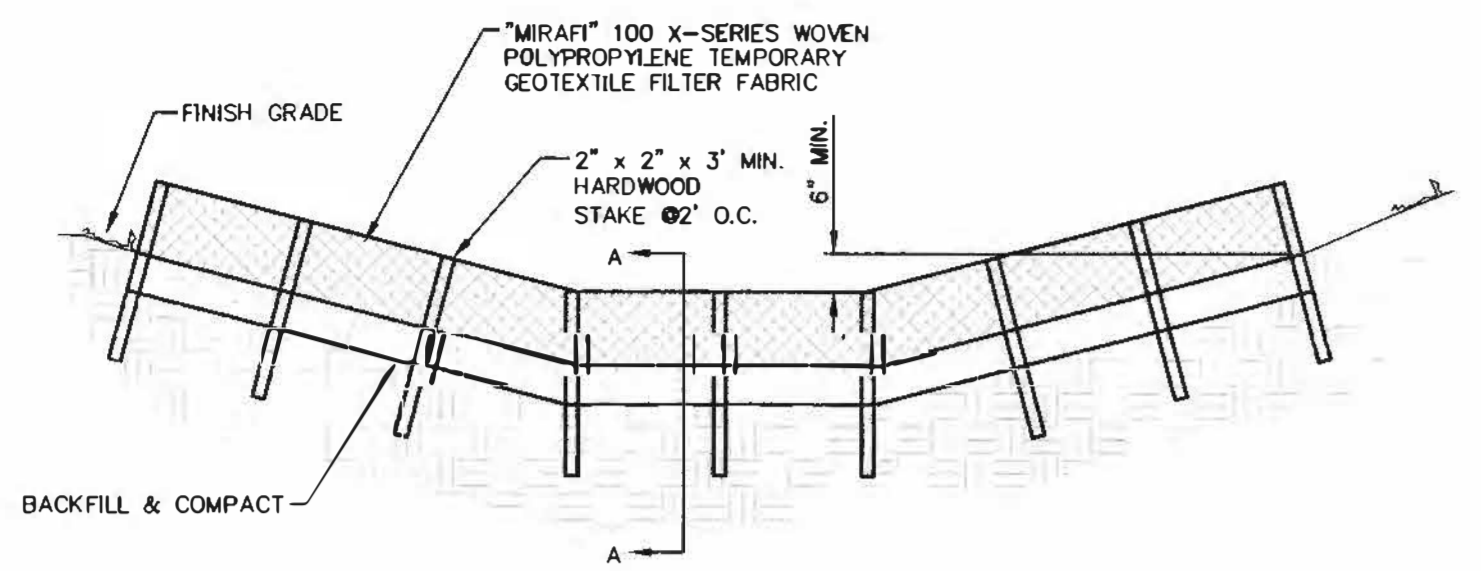

ELEVATION

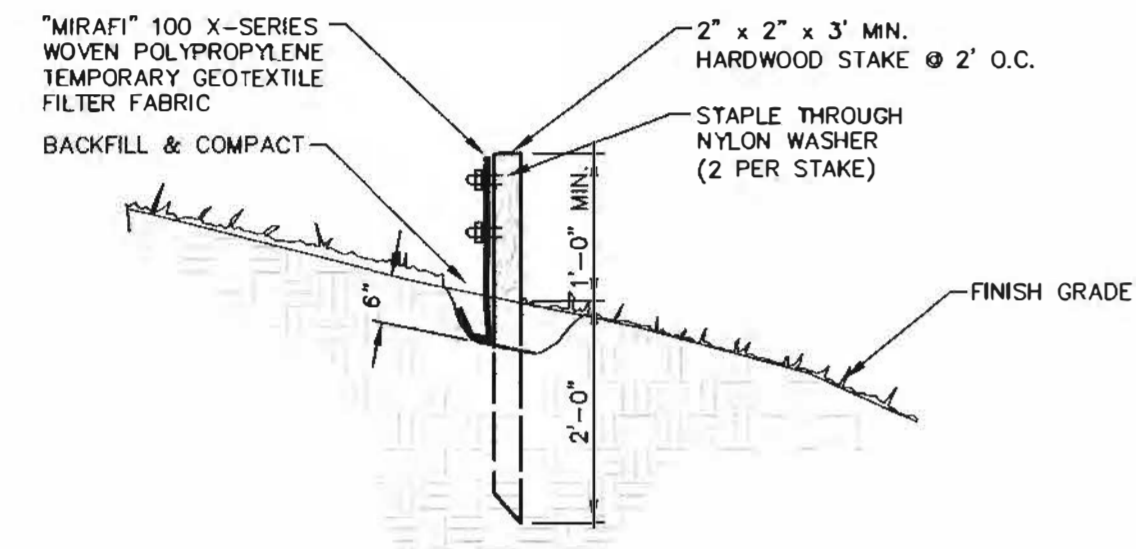

SECTION A-A

ADS FLARED END SECTION SPECIFICATION

Scope
This specification describes 12- through 36-inch (300 to 900mm) ADS Flared End Sections for use in culvert and drainage outlet applications.

Requirements
The ADS Flared End Section shall be high density polyethylene meeting ASTM D3350 minimum cell classification 213320C; contact manufacturer for additional cell classification information. When provided, the metal threaded fastening rod shall be stainless steel.

Installation
Installation shall be in accordance with ADS installation instructions and with those issued by state or local authorities. Contact your local ADS representative or visit www.ads-pipe.com for the latest installation instructions.

Diameter in (mm)	PIPE DIAMETER, in (mm)				
	12 (300)	15 (375)	18 (450)	24 (600)	36 (900)
A	6.5 (165)	6.5 (165)	7.5 (191)	7.5 (191)	7.5 (191)
B	10.0 (254)	10.0 (254)	15.0 (381)	18.0 (457)	25.0 (635)
H	6.5 (165)	6.5 (165)	6.5 (165)	8.6 (218)	8.6 (218)
W	29.0 (737)	29.0 (737)	35.0 (889)	45.0 (1143)	63.0 (1600)

*Product detail may differ slightly from actual product appearance

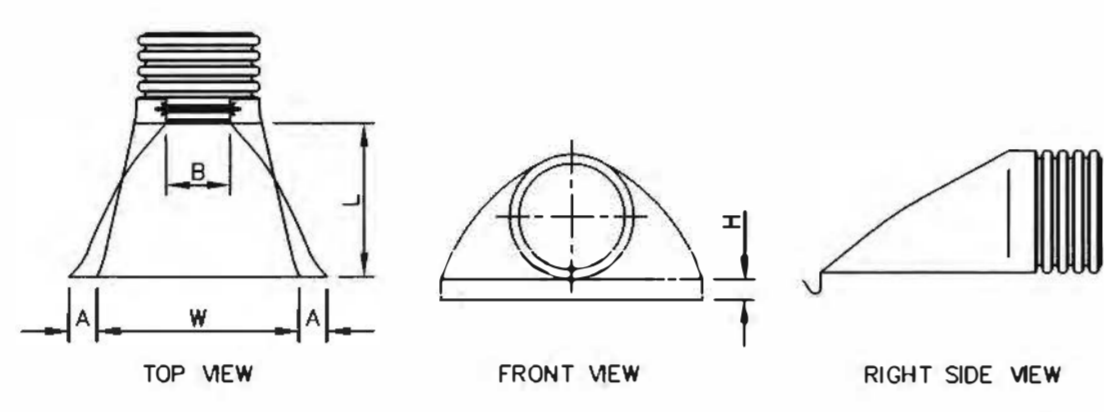

7 HDPE FLARED END SECTIONS
C-501 NO SCALE

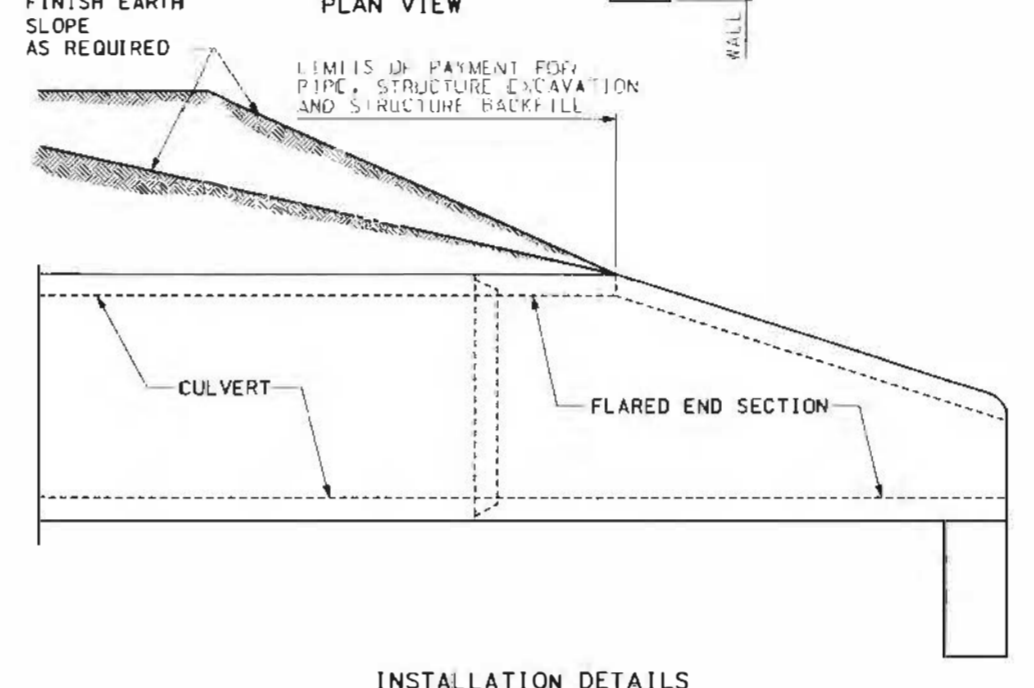
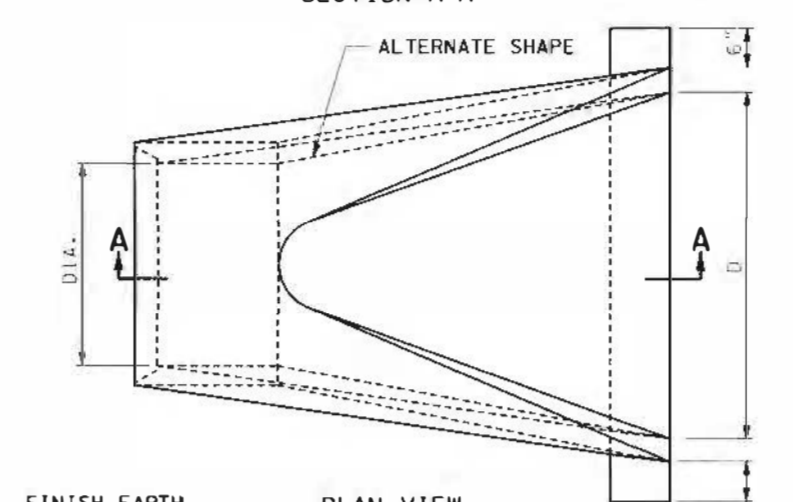
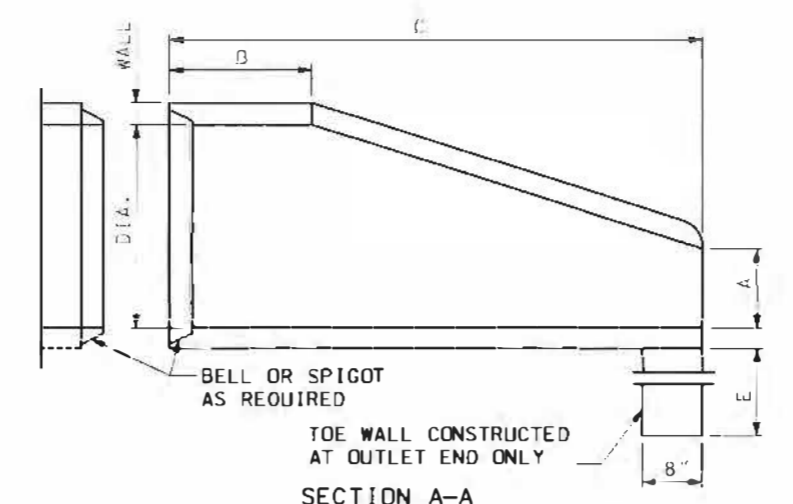

INSTALLATION DETAILS

DIA.	WALL	DIMENSIONS				
		A	B	C	D	E
12"	2"	4"	4'-0"	6'	2'-0"	18"
15"	2 1/2"	6"	3'-10"	6'	2'-6"	18"
18"	2 3/4"	9"	3'-10"	6'	3'-0"	18"
21"	3"	9"	3'-10"	6'	3'-6"	18"
24"	3"	9 1/2"	2'-6"	6'	4'-0"	24"
27"	3 1/2"	10 1/2"	2'-11"	6'	4'-6"	24"
30"	3 3/4"	1'-0"	1'-7"	6'	5'-0"	24"
33"	3 3/4"	1'-2"	1'-7"	6'	5'-6"	24"
36"	4"	1'-3"	2'-10"	8'	6'-0"	24"
42"	4 1/2"	1'-9"	2'-11"	8'	6'-6"	24"
48"	5"	2'-0"	2'-2"	8'	7'-0"	24"
54"	5 1/2"	2'-3"	2'-11"	8'	7'-6"	36"
60"	6"	2'-6"	3'-3"	8'	8'-0"	36"
66"	6 1/2"	2'-0"	1'-9"	8'	8'-6"	36"
72"	7"	2'-0"	2'-9"	10'	9'-0"	36"
78"	7 1/2"	2'-3"	2'-3"	10'	9'-6"	36"
84"	8"	2'-6"	2'-0"	10'	10'-0"	36"

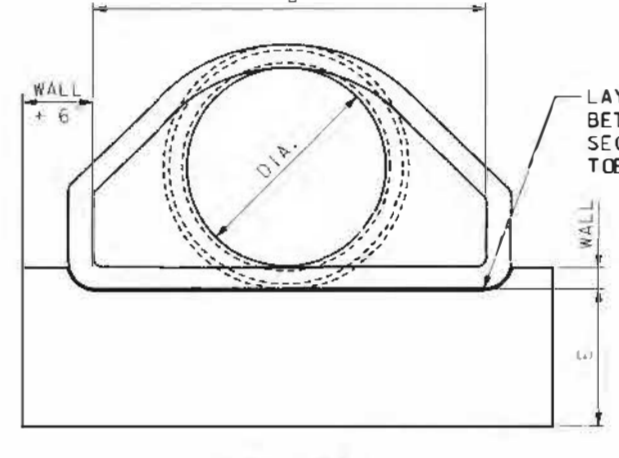

END VIEW

ADJOINING PIPE DIA.	REINFORCEMENT			
	BARREL SECTION REINFORCEMENT		FLARE SECTION REINFORCEMENT (ONE LAYER ONLY IN CENTER OF WALL)	
	CIRCULAR	ELLIPTICAL	CIRCULAR	ELLIPTICAL
12"	0.07		0.048	0.048
15"	0.07		0.054	0.054
18"	0.07	0.07	0.060	0.060
21"	0.07	0.07	0.066	0.066
24"	0.07	0.07	0.072	0.072
27"	0.13		0.11	0.078
30"	0.14		0.12	0.084
33"	0.15		0.13	0.090
36"	0.12	0.09	0.13	0.096
42"	0.15	0.12	0.17	0.108
48"	0.18	0.14	0.20	0.120
54"	0.22	0.16	0.24	0.132
60"	0.25	0.19	0.28	0.144
66"	0.31	0.23	0.34	0.156
72"	0.35	0.21	0.39	0.170
78"	0.40	0.24	0.44	0.185
84"	0.46	0.28	0.51	0.205

GENERAL NOTES:
SLIGHT VARIATIONS IN BOTH SHAPE AND DIMENSIONS FROM THOSE SHOWN MAY BE ACCEPTED IF APPROVED BY THE ENGINEER.
NOT MORE THAN THREE LIFT HOLES MAY BE DRILLED OR CAST IN THE END SECTION FOR HANDLING AND LAYING.
LIFT LUGS OR BARS WILL BE PERMITTED IN PRECAST TOE WALLS.
TOE WALLS MAY BE CAST-IN-PLACE OR PRECAST.
STEEL FIBERS MAY BE USED IN LIEU OF REBAR OR COLD DRAWN STEEL WIRE AS PER SECTION 1032.3.4.

8 CONCRETE FLARED END SECTIONS
C-501 NO SCALE

6 EROSION CONTROL (SILT FENCE)
C-501 NO SCALE

GENERAL NOTES:

- MANHOLE LID TO BE FLUSH WITH FINISHED GRADE UNLESS OTHERWISE SHOWN ON PLANS.
- ALL CONCRETE MANHOLES SHALL HAVE A CAST IN PLACE COMPRESSIVE TYPE GASKET JOINT FOR SEWER PIPE SEALS.
- MANHOLE JOINTS SHALL BE UNIFORM, PROVIDE COMPATIBLE FIT, BE FREE FROM HONEYCOMBS OR CHIPS AND BE SEALED AS SPECIFIED.
- MANHOLE EXTERIOR SHALL BE DAMP PROOFED WITH A SOLVENT BASED ASPHALT NON-FIBERED COATING
- PLUG ALL LIFT HOLES AND COVER OUTSIDE WITH BITUMASTIC SEALER.
- FIELD PIPE OPENINGS SHALL ONLY BE ALLOWED WITH ENGINEER'S APPROVAL.

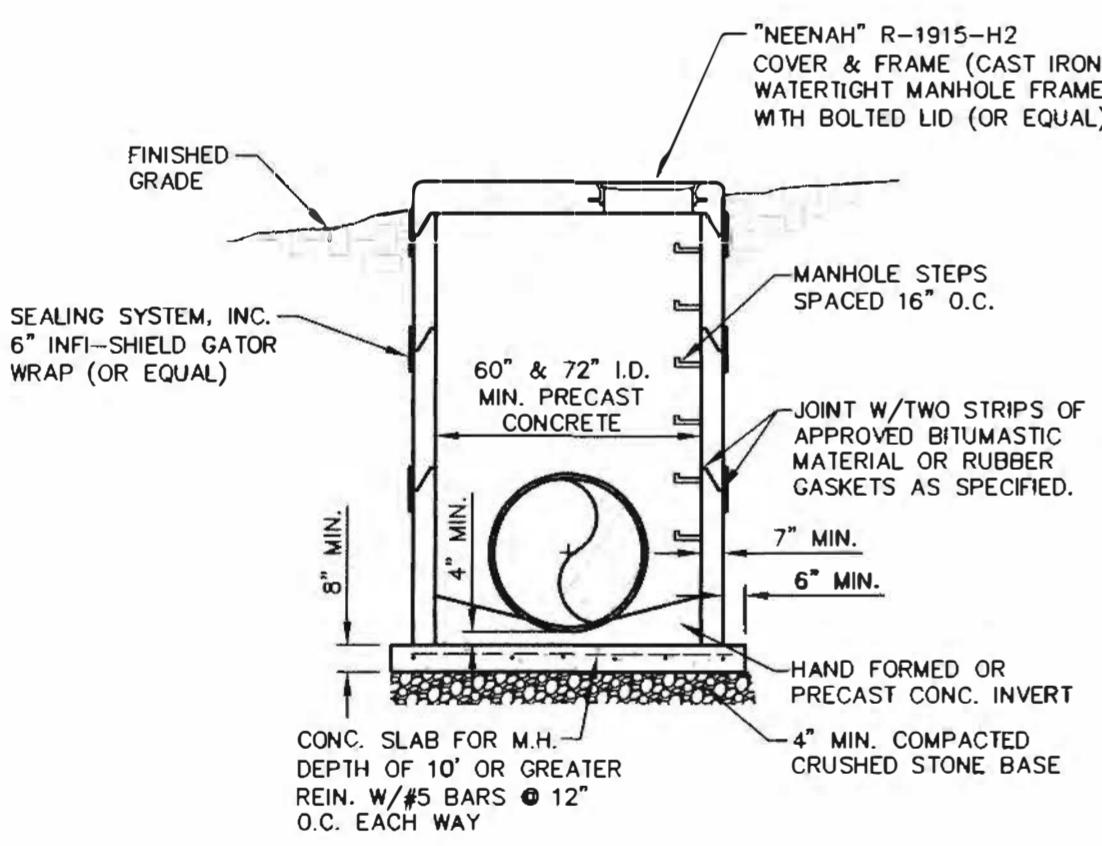

4 STANDARD MANHOLE SECTION
C-501 NO SCALE

5 RIPRAP SPILLWAY SECTION
C-501 NO SCALE

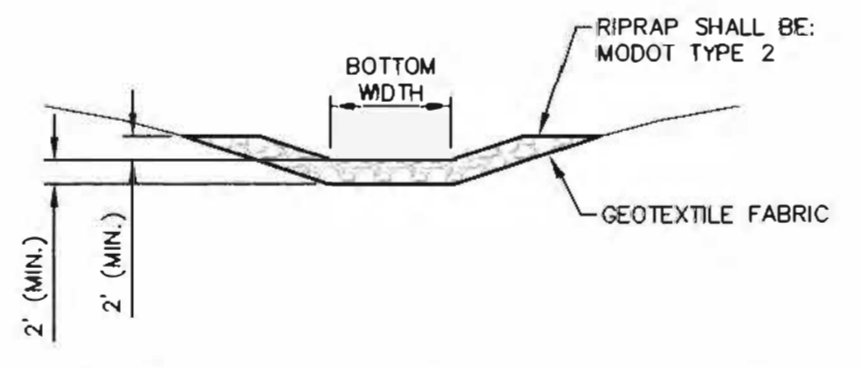

GENERAL NOTES

- MINIMUM TRENCH WIDTH SHALL BE MAINTAINED FROM 6" BELOW PIPE TO 12" ABOVE THE TOP OF PIPE.
- IF PAYMENT IS AUTHORIZED, PAY LINES FOR ROCK REMOVAL SHALL BE BASED UPON 2 TIMES PIPE DIAMETER FOR ALL EXCEPT GRAVITY WHICH SHALL BE BASED ON MAX. TRENCH WIDTH, SEE CHART.
- PIPE BEDDING NOTE BELOW IS MINIMUM STANDARD, HOWEVER ANY MORE STRINGENT REQUIREMENTS SET BY PIPE SUPPLIER SHALL SUPERSEDE REQUIREMENTS SHOWN.
- GRANULAR BEDDING GRADUATION SHALL BE AS FOLLOWS UNLESS REQUIRED BY THE PIPE MANUFACTURER OR APPROVED BY THE ENGINEER.
- FLOWABLE FILL MIX SHALL BE AS FOLLOWS UNLESS OTHERWISE APPROVED BY THE ENGINEER.
- UNSUITABLE BACKFILL MATERIAL SHALL BE DISPOSED OF BY CONTRACTOR AT HIS EXPENSE AND SUITABLE REPLACEMENT MATERIAL PROVIDED AT NO ADDITIONAL COST TO OWNER.
- ALL TRENCHES SHALL MEET O.S.H.A. REQUIREMENTS.
- ROADWAY RESURFACING SHALL BE REPLACED AS SHOWN IN ACCORDANCE WITH PROJECT SPECIFICATIONS OR CURRENT REQUIREMENTS OF THE CONTROLLING AUTHORITY, WHICH EVER IS MORE STRINGENT AS DEFINED BY THE ENGINEER.
- PAVEMENT REPLACEMENT TO CONSIST OF:
ASPHALT MATERIAL: HOT MIX ASPHALT THICKNESS: MATCH EXISTING, BUT NOT LESS THAN 4" COMPACTED IN PLACE
NOTE: DELETE C.S. BASE FOR FLOWABLE FILL TACK COAT TOP OF FLOWABLE FILL OR PRIME CRUSHED STONE BASE AT A RATE OF 0.25 GALLON / SQUARE YARD.
CONCRETE MATERIAL: PORTLAND CEMENT CONCRETE 4,000 PSI @ 28 DAYS DOWEL W/#4@24" @ 24" O.C.
THICKNESS: MATCH EXISTING (NOT LESS THAN 6")
NOTE: DELETE C.S. BASE FOR FLOWABLE FILL
- UNLESS OTHERWISE NOTED ON THE PLANS, SDR 35 PVC PIPE SHALL NOT BE INSTALLED AT DEPTHS GREATER THAN 14 FEET AND SDR 26 PVC PIPE SHALL NOT BE INSTALLED AT DEPTHS GREATER 24 FEET.

SEIVE SIZE	PERCENT PASSING
1/2"	100
3/8"	80-100
#4	5-80
#10	0-5

MATERIAL	QUANTITY/QU. YD
CEMENT	70 POUNDS
FLY ASH	300 POUNDS
FINE AGGREGATE	2600 POUNDS
WATER	50 GALLON

PIPE DIA.	MIN. TRENCH WIDTH @ 12" ABOVE PIPE	MAX. TRENCH WIDTH FOR PAYMENT
LESS THAN 8"	PIPE DIA +1'-0"	PIPE DIA +2'-0"
8"	1'-8"	2'-8"
10"	1'-10"	2'-10"
12"	2'-0"	3'-0"
15"	2'-3"	3'-3"
18"	2'-6"	3'-6"
21"	2'-9"	3'-9"
24"	3'-0"	4'-0"
27"	3'-3"	4'-3"
30"	3'-6"	4'-6"
36"	4'-0"	5'-0"
42"	4'-6"	5'-6"

TRENCH WIDTH CHART

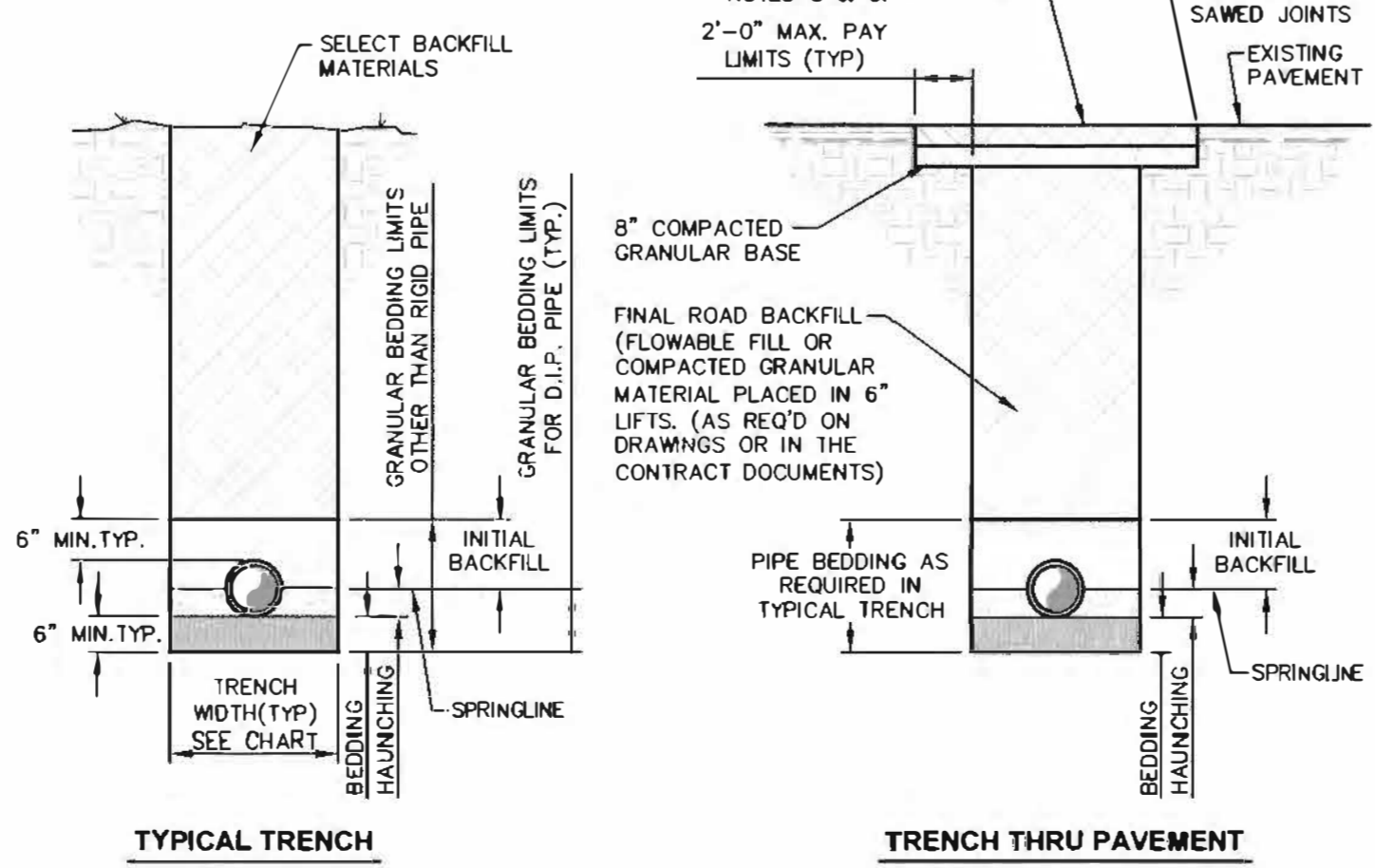

2 STORM SEWER TRENCH DETAILS
C-501 NO SCALE

1 ACCESS ROAD SECTION (ASPHALT)
C-501 NO SCALE

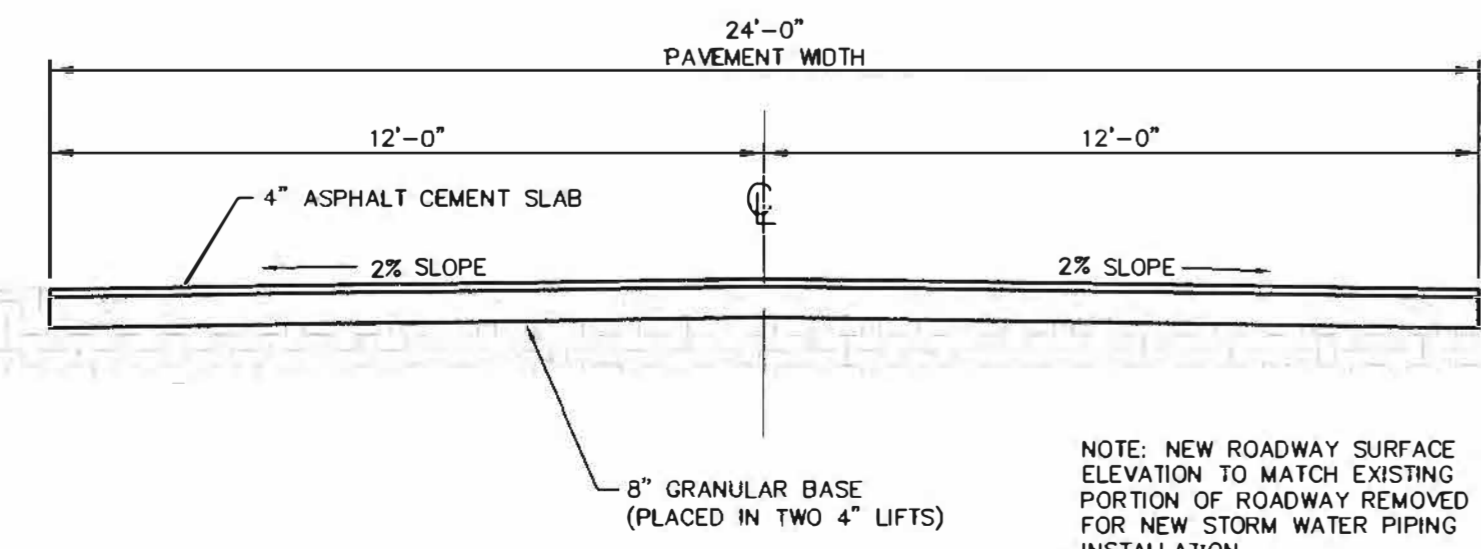

NOTE: NEW ROADWAY SURFACE ELEVATION TO MATCH EXISTING PORTION OF ROADWAY REMOVED FOR NEW STORM WATER PIPING INSTALLATION.

3 STORM SEWER TRENCH NOTES
C-501 NO SCALE