

REPLACE RETAINING WALLS STATE SCHOOL BUILDING MISSISSIPPI VALLEY STATE SCHOOL HANNIBAL , MISSOURI

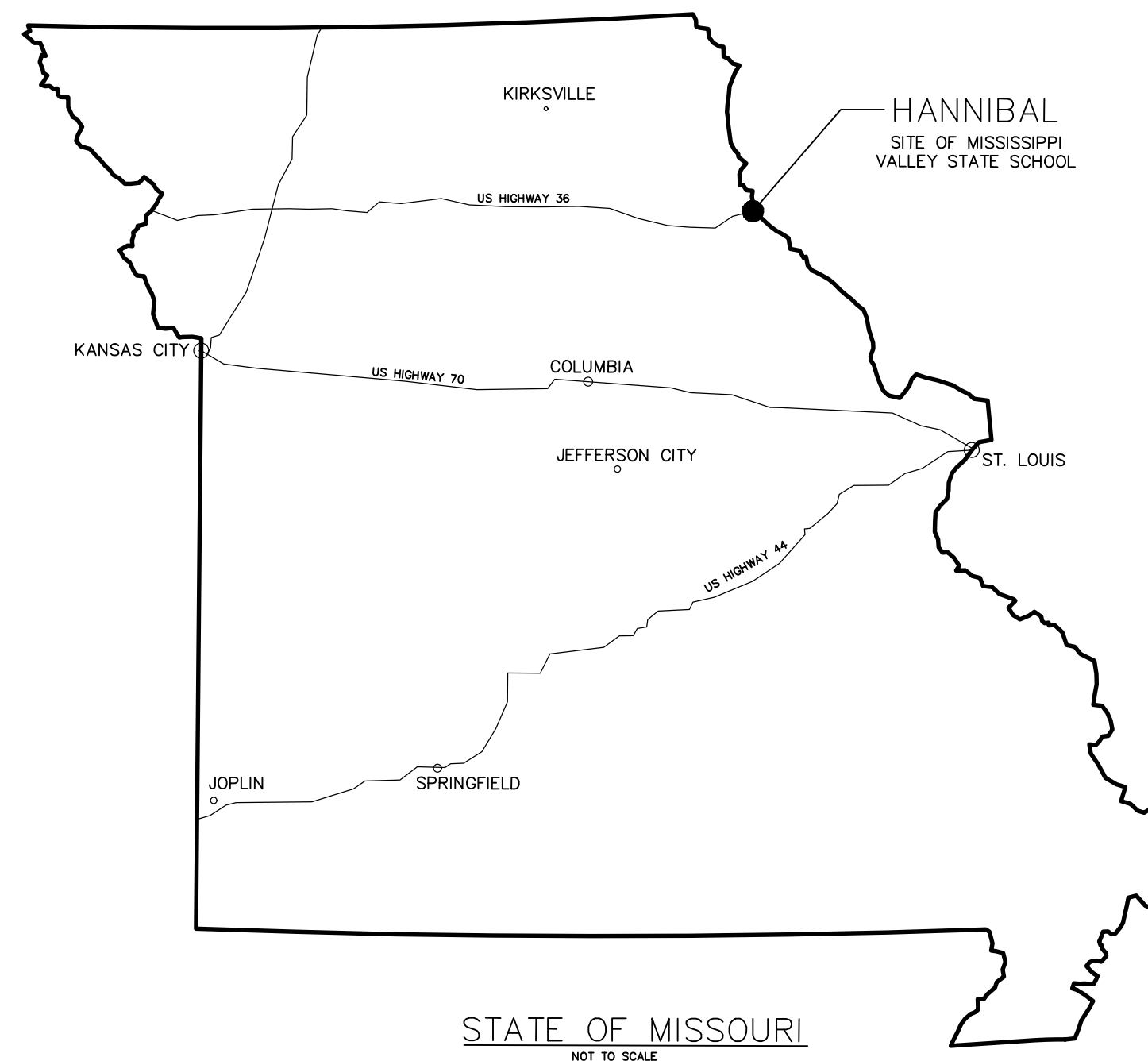

OWNER: STATE OF MISSOURI
MIKE KEHOE,
GOVERNOR

DEPARTMENT OF
ELEMENTARY AND SECONDARY EDUCATION

PROJECT
MANAGEMENT: OFFICE OF ADMINISTRATION
DIVISION OF FACILITIES MANAGEMENT,
DESIGN AND CONSTRUCTION

DESIGNER: STATE OF MISSOURI - OFFICE OF ADMINISTRATION
DIVISION OF FACILITIES MANAGEMENT DESIGN
AND CONSTRUCTION: 301 W. HIGH STREET,
JEFFERSON CITY, MO. 65102

PROJECT NUMBER: E2401-01

SITE NUMBER: 2039
ASSET NUMBER: 5012039004

SHEET NUMBER:

G-001

1 OF 9 SHEETS
03/15/2025

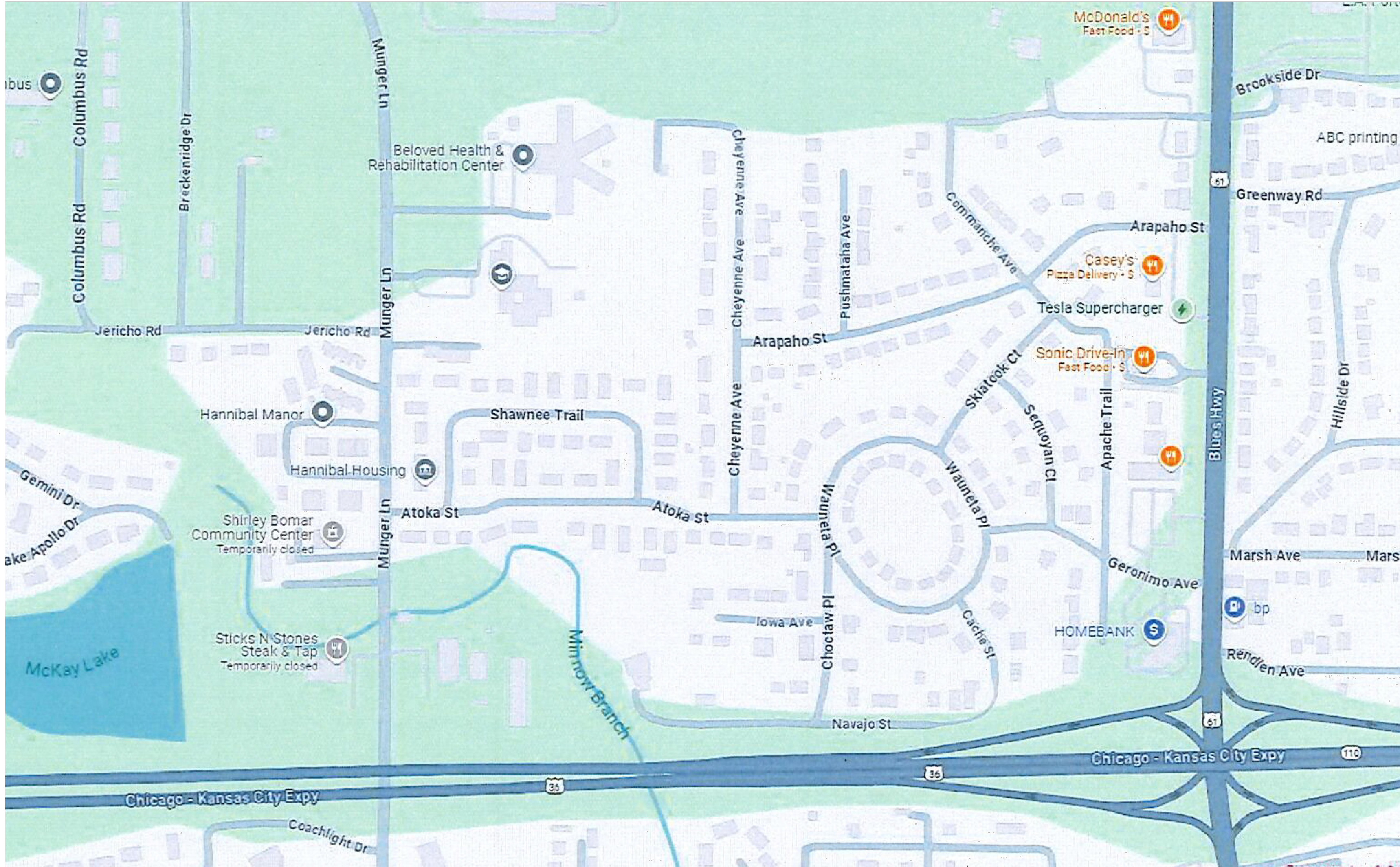

1 PARTIAL SITE MAP of HANNIBAL, MO
G-002 NOT TO SCALE

SCOPE OF WORK:

THE PROJECT CONSISTS OF FURNISHING ALL MATERIALS, LABOR, AND SERVICES NECESSARY TO REMOVE ALL PORTIONS OF THE EXISTING RAILROAD TIE (TIMBER) RETAINING WALLS AND THEIR SUBSEQUENT REPLACEMENT WITH A CONCRETE SEGMENTAL RETAINING WALL (SRW) BLOCK SYSTEMS IN THE AREAS AT THE NORTH AND SOUTH SIDES OF THE SCHOOL BUILDING KNOWN AS THE MISSISSIPPI VALLEY STATE SCHOOL, HANNIBAL, MISSOURI AS PER THESE DRAWINGS AND SPECIFICATIONS.

SPECIFICALLY, THE WORK CONSISTS OF THE DEMOLITION AND REMOVAL OF VARIOUS TERRACED PORTIONS OF RAILROAD TIMBER WALLS AND THEIR REPLACEMENT WITH SINGLE-WYTHE, SOIL REINFORCED, CONCRETE BLOCK SEGMENTAL RETAINING WALLS. THESE REPLACEMENT WALLS WILL REQUIRE THE CUTTING AND REMOVAL OF SEVERAL LARGE TREES INCLUDING THEIR STUMPS AND ANY LARGE ROOTS THAT WILL INTERFERE WITH THE NEW RETAINING WALLS, THE REMOVAL AND REPLACEMENT OF SELECT SIDEWALKS AND THE INSTALLATION OF CHAIN LINK FENCES ON THE TOP OF THE NEW WALLS. INCIDENTAL SITE WORK INCLUDES EXCAVATION, GRADING, SEEDING AND LANDSCAPING. SEE COMPLETE SET OF DRAWINGS AND SPECIFICATIONS FOR ALL WORK REQUIRED ON THIS PROJECT.

- GENERAL NOTES:
- 1 DRIVEWAYS AND PARKING LAYOUTS AND DIMENSIONS AS SHOWN ON THESE PLANS ARE DERIVED FROM THE ORIGINAL TOPOGRAPHICAL SITE PLAN. ALL DIMENSIONS ARE SUBJECT TO ERROR. BIDDERS SHOULD VERIFY ANY DIMENSIONS, GRADES OR OTHER CONDITIONS NECESSARY TO CALCULATE AN ACCURATE BID PROPOSAL.
 - 2 CONTRACTOR SHALL ENGAGE A PRIVATE UTILITY LOCATING SERVICE IN AREAS WHERE EXCAVATION OR EXISTING RETAINING WALL REMOVAL IS REQUIRED AND MAY CONFLICT WITH UNDERGROUND UTILITIES.
 - 3 THIS PROJECT WILL REQUIRE COORDINATION WITH THE OWNER. CONTRACTOR SHALL SCHEDULE WORK SO THAT DRIVEWAYS, PARKING & VEHICULAR ACCESS CAN BE KEPT OPEN AT ALL TIMES.
 - 4 CONSTRUCTION AREAS SHALL BE MAINTAINED BY THE CONTRACTOR IN A CONDITION THAT WILL PREVENT TRACKING OR FLOW OF SEDIMENT ONTO PUBLIC RIGHT-OF-WAYS AND STREETS. AREAS DAMAGED OR SOILED BY CONSTRUCTION ACTIVITIES SHALL BE CONTRACTOR'S RESPONSIBILITY TO CORRECT.
 - 5 THE CONTRACTOR SHALL BE RESPONSIBLE FOR ALL BARRICADES AND TEMPORARY SIGNAGE REQUIRED DURING CONSTRUCTION FOR SAFETY AND APPROPRIATE TRAFFIC CONTROL.
 - 6 EXISTING UTILITIES AS SHOWN ARE APPROXIMATE LOCATIONS ONLY. IT SHALL BE THE RESPONSIBILITY OF THE CONTRACTOR TO VERIFY THE LOCATIONS OF ALL EXISTING PUBLIC AND PRIVATE UTILITIES PRIOR TO THE START OF CONSTRUCTION WORK. ANY DAMAGE TO EXISTING STRUCTURES, UTILITIES, FENCES, AND/OR INCIDENTALS NOT DESIGNATED FOR REMOVAL SHALL BE REPAIRED AT THE CONTRACTOR'S EXPENSE. THE CONTRACTOR SHALL ENGAGE A PRIVATE AND PUBLIC UTILITY LOCATE SERVICE IN AREAS WHERE GRADING WILL TAKE PLACE. MISSOURI ONE CALL DOES NOT LOCATE ON THIS ENTIRE PROPERTY AS IT IS CONSIDERED PRIVATE PROPERTY, THERE COULD BE PRIVATE UTILITIES THAT ARE NOT SHOWN. CONTACT WITH THE OWNER'S ON-SITE REPRESENTATIVE MAY BE HELPFUL ALSO.

- DEMOLITION NOTES:
- 1 A SEPARATE DEMOLITION PLAN HAS NOT BEEN DEVELOPED FOR THIS PROJECT AS NEW SEGMENTAL RETAINING WALL ARE ESSENTIALLY TO BE LOCATED IN A SIMILAR FOOTPRINT AS THE EXISTING RAILROAD TIE RETAINING WALLS AND SHOWING BOTH WOULD CONFUSE THE LINES BETWEEN NEW AND EXISTING WALLS.
 - 2 CONTRACTOR SHALL REMOVE ALL SEGMENTS OF THE EXISTING RAILROAD TIE RETAINING WALLS AS THEY OCCUR ABOVE OR BELOW GRADES INCLUDING ALL TIMBERS, PIECES, FASTENERS, CLINGING SOILS AND ACCESSORIES ASSOCIATED WITH THESE WALLS. EXISTING WALLS SHALL BE DECONSTRUCTED, LIKE PIECES SEPARATED OUT, LOADED ON TRUCKS AND PROPERLY DISPOSE OF OFF-SITE.
 - 3 EXISTING TREES AND SHRUBS THAT ARE DESIGNATED TO BE REMOVED SHALL BE CUT DOWN, SAWN INTO MANAGEABLE SECTIONS INCLUDING ALL BRANCHES, TRUNKS AND VEGETATION AND HAULED OFF TO BE DISPOSED OF PROPERLY. ALL STUMPS SHALL BE GROUND OFF TO AT LEAST 6" BELOW FINISHED GRADES. EXISTING ROOTS ENCOUNTERED IN THE EXCAVATIONS FOR NEW RETAINING WALL BASE SHALL BE REMOVED AND DISPOSED OF WITH OTHER PORTIONS OF THE TREES.
 - 4 ALL DEMOLISHED MATERIALS SHALL BE REMOVED FROM SITE DAILY AND DISPOSED OF LEGALLY. ON-SITE BURNING IS NOT PERMITTED.

- SEGMENTAL RETAINING WALLS (SRW) NOTES:
- 1 THE DESIGN AND CONSTRUCTION OF THESE SEGMENTAL RETAINING WALLS SHALL BE DONE IN STRICT ACCORDANCE WITH THE DELEGATED-DESIGN STANDARDS AS INDICATED IN THE SECTION 32.3223 - SEGMENTAL RETAINING WALLS AND PER THESE DRAWINGS. SRW DESIGNS ARE NOT TO EXCEED 8 FEET OF EXPOSED WALL HEIGHT AND ARE TO BE DESIGNED WITH NO SURCHARGE.
 - 2 THE SOUTH SRW IS INTENDED TO HAVE A CONSISTENT TOP OF WALL ELEVATION OF 656.25 FEET AND A STEPPED LEVELING PAD THAT VARIES FROM A MINIMUM DEPTH OF 653.5 FEET AND A MAXIMUM DEPTH OF 645.5 FEET. (SEE SOUTH SRW ELEVATION)
 - 3 THE NORTH SRW IS INTENDED TO HAVE A CONSISTENT LEVELING PAD ELEVATION OF 654.5 FEET AND A STEPPED TOP OF ELEVATION THAT VARIES FROM A MAXIMUM HEIGHT OF 658.58 FEET AND MINIMUM HEIGHT OF 656.25 FEET. (SEE NORTH SRW ELEVATION)
 - 4 BACKFILLING AND GRADING AROUND THE RETAINING WALLS SHALL OCCUR AS WALLS ARE CONSTRUCTED IN ACCORDANCE WITH BLOCK MANUFACTURERS INSTRUCTIONS. FINAL GRADING SHALL BE ACCOMPLISHED AS PER SPOT ELEVATIONS AND NEW CONTOURS INDICATED ON THE SITE PLANS.
 - 5 AFTER ALL FINAL GRADING IS COMPLETE, DISTURBED SOILS SHALL BE HYDROSEEDDED IN ACCORDANCE WITH THE SPECIFICATIONS.

DRAWING INDEX		
ORDER	SHEET #	DESCRIPTION
GENERAL:		
1	G-001	TITLE SHEET
2	G-002	MAP, NOTES & DRAWING INDEX
ARCHITECTURAL:		
3	A-101	GENERAL SITE PLAN
4	A-201	SOUTH SRW PLAN & ELEVATIONS
5	A-202	NORTH SRW PLAN & ELEVATIONS
6	A-301	SOUTH SRW WALL SECTIONS
7	A-302	NORTH SRW WALL SECTIONS
8	A-501	FENCE DETAILS
9	A-502	MISCELLANEOUS DETAILS
NOTE:		SRW is an abbreviation for SEGMENTAL RETAINING WALL

STATE OF MISSOURI
MIKE KEHOE,
GOVERNOR



Brad M. Schaefer - Architect
MO# A-2009027294

BID DOCUMENTS

OFFICE OF ADMINISTRATION
DIVISION OF FACILITIES
MANAGEMENT,
DESIGN AND CONSTRUCTION

DEPARTMENT OF
Elementary and Secondary
Education

REPLACE RETAINING WALLS
STATE SCHOOL BUILDING

Mississippi Valley State School
312 Munger Lane
Hannibal, Missouri

PROJECT # E2401-01
SITE # 2039
ASSET # 5012039004

REVISION: _____
DATE: _____
REVISION: _____
DATE: _____
REVISION: _____
DATE: _____
ISSUE DATE: 03/15/2025

CAD DWG FILE:BS
DRAWN BY: TEH
CHECKED BY: BS
DESIGNED BY: TEH

SHEET TITLE:
MAP, NOTES &
DRAWING INDEX

SHEET NUMBER:

G-002

2 OF 9 SHEETS
03/15/2025

SCOPE OF WORK:

THE PROJECT CONSISTS OF FURNISHING ALL MATERIALS, LABOR, AND SERVICES NECESSARY TO REMOVE ALL PORTIONS OF THE EXISTING RAILROAD TIE (TIMBER) RETAINING WALLS AND THEIR SUBSEQUENT REPLACEMENT WITH A CONCRETE SEGMENTAL RETAINING WALL (SRW) BLOCK SYSTEMS IN THE AREAS AT THE NORTH AND SOUTH SIDES OF THE SCHOOL BUILDING KNOWN AS THE MISSISSIPPI VALLEY STATE SCHOOL, HANNIBAL, MISSOURI AS PER THESE DRAWINGS AND SPECIFICATIONS.

SPECIFICALLY, THE WORK CONSISTS OF THE DEMOLITION AND REMOVAL OF VARIOUS TERRACED PORTIONS OF RAILROAD TIMBER WALLS AND THEIR REPLACEMENT WITH TWO SINGLE-WYTHE, SOIL REINFORCED, CONCRETE BLOCK SEGMENTAL RETAINING WALLS. THESE REPLACEMENT WALLS WILL REQUIRE THE CUTTING AND REMOVAL OF SEVERAL LARGE TREES INCLUDING THEIR STUMPS AND ANY LARGE ROOTS THAT WILL INTERFERE WITH THE NEW RETAINING WALLS, THE REMOVAL AND REPLACEMENT OF SIDEWALKS AND THE INSTALLATION OF CHAIN LINK FENCES AT THE TOP OF THE NEW WALLS. INCIDENTAL SITE WORK INCLUDES EXCAVATION, GRADING, SEEDING, SODDING AND LANDSCAPING. SEE COMPLETE SET OF DRAWINGS AND SPECIFICATIONS FOR ALL WORK REQUIRED ON THIS PROJECT.

DEMOLITION NOTES:

- 1 A SEPARATE DEMOLITION PLAN HAS NOT BEEN DEVELOPED FOR THIS PROJECT AS NEW SEGMENTAL RETAINING WALL ARE ESSENTIALLY TO BE LOCATED IN A SIMILAR FOOTPRINT AS THE EXISTING RAILROAD TIE RETAINING WALLS AND SHOWING BOTH WOULD CONFUSE THE LINES BETWEEN NEW AND EXISTING WALLS.
- 2 CONTRACTOR SHALL REMOVE ALL SEGMENTS OF THE EXISTING RAILROAD TIE RETAINING WALLS AS THEY OCCUR ABOVE OR BELOW GRADES INCLUDING ALL TIMBERS, PIECES, FASTENERS, CLINGING SOILS AND ACCESSORIES ASSOCIATED WITH THESE WALLS. EXISTING WALLS SHALL BE DECONSTRUCTED, LIKE PIECES SEPARATED OUT, LOADED ON TRUCKS AND PROPERLY DISPOSE OF OFF-SITE.
- 3 EXISTING TREES AND SHRUBS THAT ARE DESIGNATED TO BE REMOVED SHALL BE CUT DOWN, SAWN INTO MANAGEABLE SECTIONS INCLUDING ALL BRANCHES, TRUNKS AND VEGETATION AND HAULED OFF TO BE DISPOSED OF PROPERLY. ALL STUMPS SHALL BE GROUND OFF TO AT LEAST 6" BELOW FINISHED GRADES. EXISTING ROOTS ENCOUNTERED IN THE EXCAVATIONS FOR NEW RETAINING WALL BASE SHALL BE REMOVED AND DISPOSED OF WITH OTHER PORTIONS OF THE TREES.
- 4 ALL DEMOLISHED MATERIALS SHALL BE REMOVED FROM SITE DAILY AND DISPOSED OF LEGALLY. ON-SITE BURNING IS NOT PERMITTED.

SEGMENTAL RETAINING WALLS (SRW) NOTES:

- 1 THE DESIGN AND CONSTRUCTION OF THESE SEGMENTAL RETAINING WALLS SHALL BE DONE IN STRICT ACCORDANCE WITH THE DELEGATED-DESIGN STANDARDS AS INDICATED IN THE SECTION 323223 - SEGMENTAL RETAINING WALLS AND PER THESE DRAWINGS. SRW DESIGNS ARE NOT TO EXCEED 8 FEET OF EXPOSED WALL HEIGHT AND ARE TO BE DESIGNED WITH NO SURCHARGE.
- 2 THE SOUTH SRW IS INTENDED TO HAVE A CONSISTENT TOP OF WALL ELEVATION OF 656.25 FEET AND A STEPPED LEVELING PAD THAT VARIES FROM A MINIMUM DEPTH OF 653.5 FEET AND A MAXIMUM DEPTH OF 645.5 FEET. (SEE SOUTH SRW ELEVATION)
- 3 THE NORTH SRW IS INTENDED TO HAVE A CONSISTENT LEVELING PAD ELEVATION OF 654.5 FEET AND A STEPPED TOP OF ELEVATION THAT VARIES FROM A MAXIMUM HEIGHT OF 658.58 FEET AND MINIMUM HEIGHT OF 656.25 FEET. (SEE NORTH SRW ELEVATION)
- 4 BACKFILLING AND GRADING AROUND THE RETAINING WALLS SHALL OCCUR AS WALLS ARE CONSTRUCTED IN ACCORDANCE WITH BLOCK MANUFACTURERS INSTRUCTIONS. FINAL GRADING SHALL BE ACCOMPLISHED AS PER SPOT ELEVATIONS AND NEW CONTOURS INDICATED ON THE SITE PLANS.
- 5 AFTER ALL FINAL GRADING IS COMPLETE, DISTURBED SOILS SHALL BE HYDROSEEDDED IN ACCORDANCE WITH THE SPECIFICATIONS.

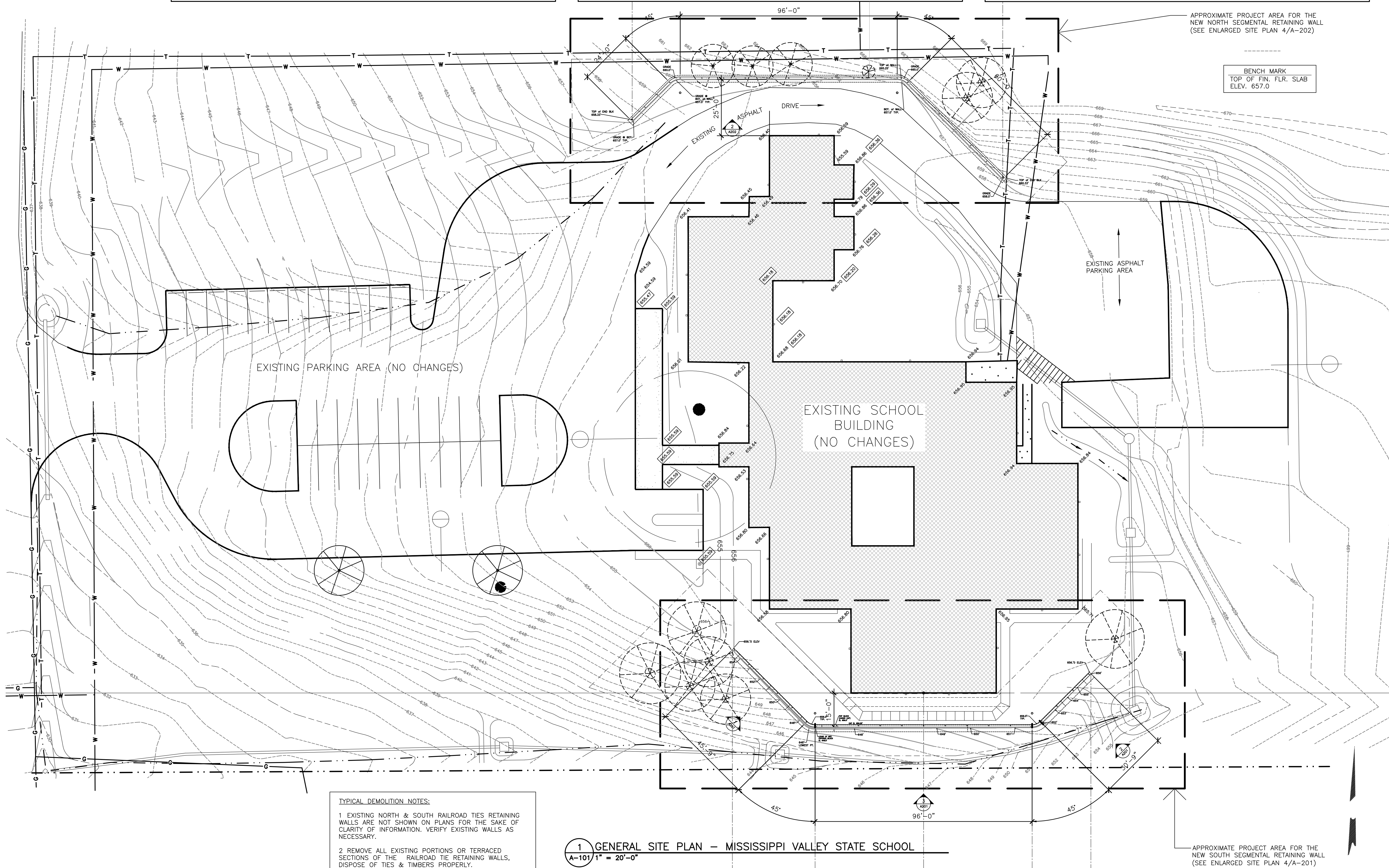

TYPICAL DEMOLITION NOTES:

- 1 EXISTING NORTH & SOUTH RAILROAD TIES RETAINING WALLS ARE NOT SHOWN ON PLANS FOR THE SAKE OF CLARITY OF INFORMATION. VERIFY EXISTING WALLS AS NECESSARY.
- 2 REMOVE ALL EXISTING PORTIONS OR TERRACED SECTIONS OF THE RAILROAD TIE RETAINING WALLS, DISPOSE OF TIES & TIMBERS PROPERLY.

1 GENERAL SITE PLAN - MISSISSIPPI VALLEY STATE SCHOOL
A-101 1" = 20'-0"

STATE OF MISSOURI
MIKE KEHOE,
GOVERNOR



Brad M. Schaefer - Architect
MO# A-2009027294

BID
DOCUMENTS

OFFICE OF ADMINISTRATION
DIVISION OF FACILITIES
MANAGEMENT,
DESIGN AND CONSTRUCTION

DEPARTMENT OF
Elementary and Secondary
Education

REPLACE RETAINING WALLS
STATE SCHOOL BUILDING

Mississippi Valley State School
312 Munger Lane
Hannibal, Missouri

PROJECT # E2401-01
SITE # 2039
ASSET # 5012039004

REVISION:
DATE:
REVISION:
DATE:
REVISION:
DATE:
ISSUE DATE: 03/15/2025

CAD DWG FILE:BS
DRAWN BY: TEH
CHECKED BY: BS
DESIGNED BY: TEH

SHEET TITLE:
GENERAL
SITE PLAN

SHEET NUMBER:

A-101

3 OF 9 SHEETS
03/15/2025



Brad M. Schaefer - Architect
MO# A-2009027294

BID DOCUMENTS

OFFICE OF ADMINISTRATION
DIVISION OF FACILITIES
MANAGEMENT,
DESIGN AND CONSTRUCTION

DEPARTMENT OF
Elementary and Secondary
Education

REPLACE RETAINING WALLS
STATE SCHOOL BUILDING

Mississippi Valley State School
312 Munger Lane
Hannibal, Missouri

PROJECT # E2401-01
SITE # 2039
ASSET # 5012039004

REVISION:
DATE: _____
REVISION: _____
DATE: _____
REVISION: _____
DATE: _____
ISSUE DATE: 03/15/2025

CAD DWG FILE: BS
DRAWN BY: TEH
CHECKED BY: BS
DESIGNED BY: TEH

SHEET TITLE:
SOUTH SRW
PLAN & ELEVATION

SHEET NUMBER:

A-201

4 OF 9 SHEETS
03/15/2025

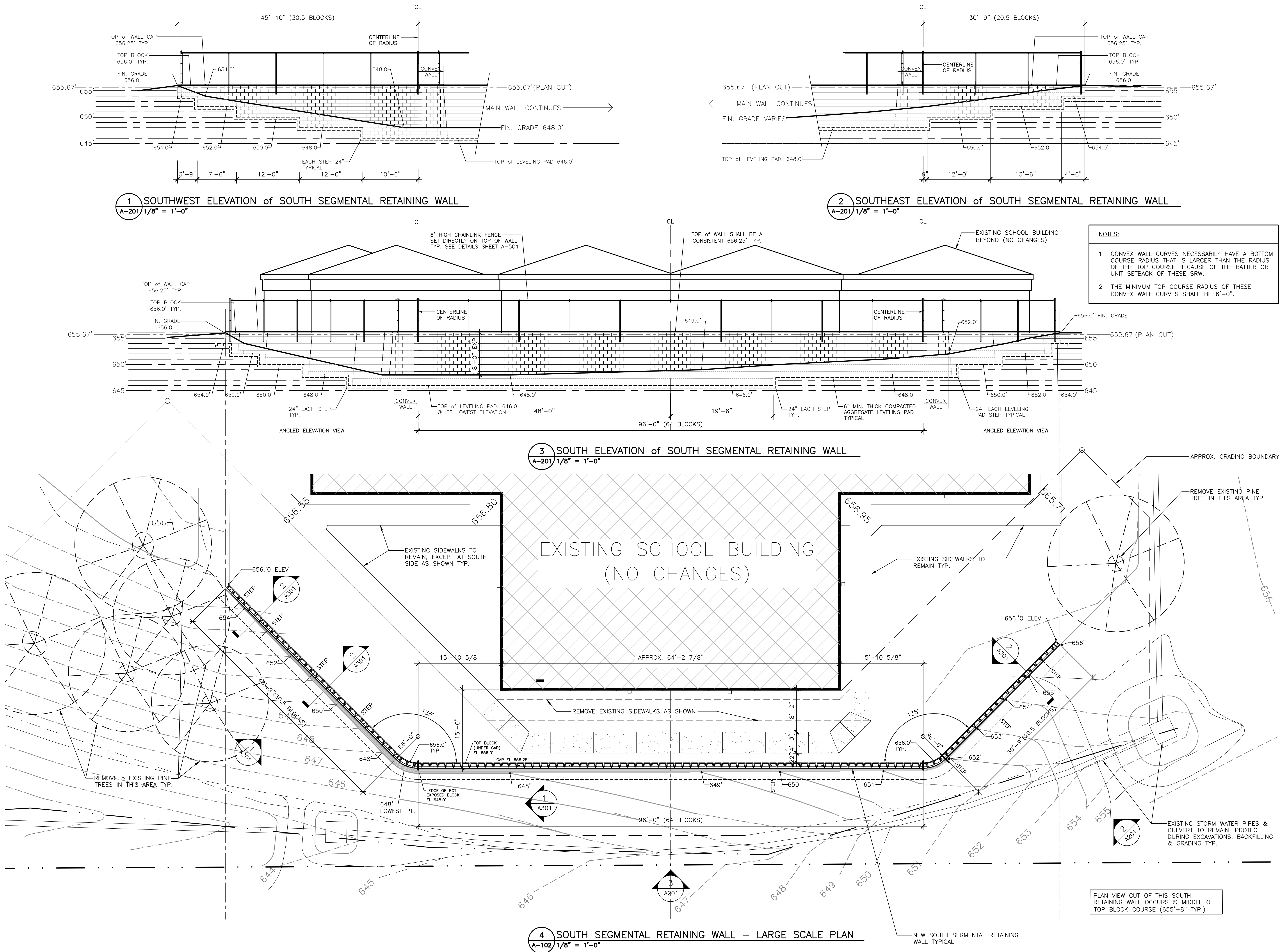



- [illegible]

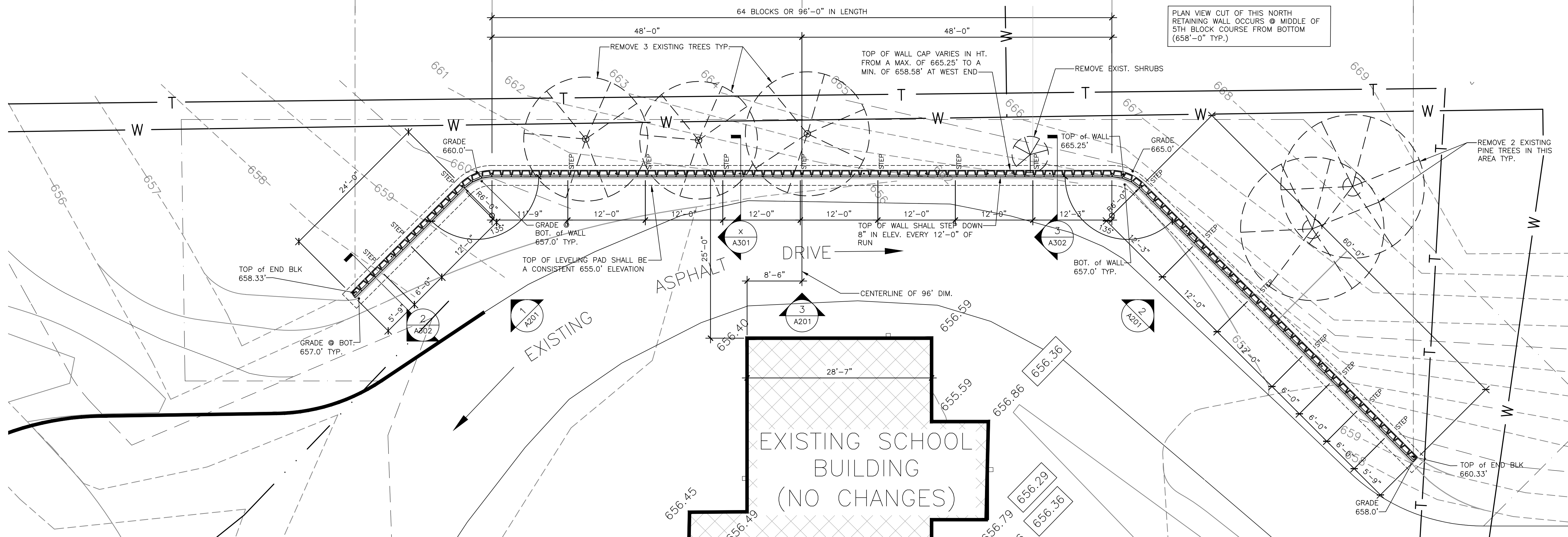

4 NORTH SEGMENTAL RETAINING WALL - LARGE SCALE PLAN
A-202 1/8" = 1'-0"

6 OF 9 SHEETS
03/15/2025



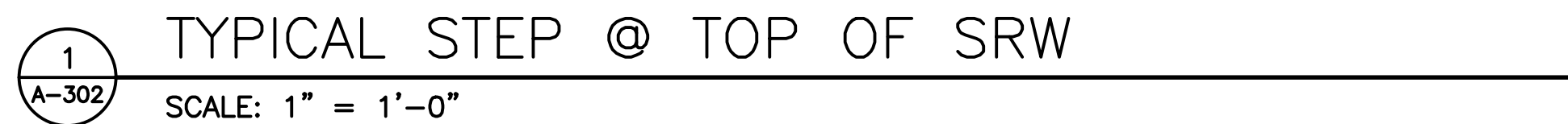

BID DOCUMENTS

7 OF 9 SHEETS
03/15/2025

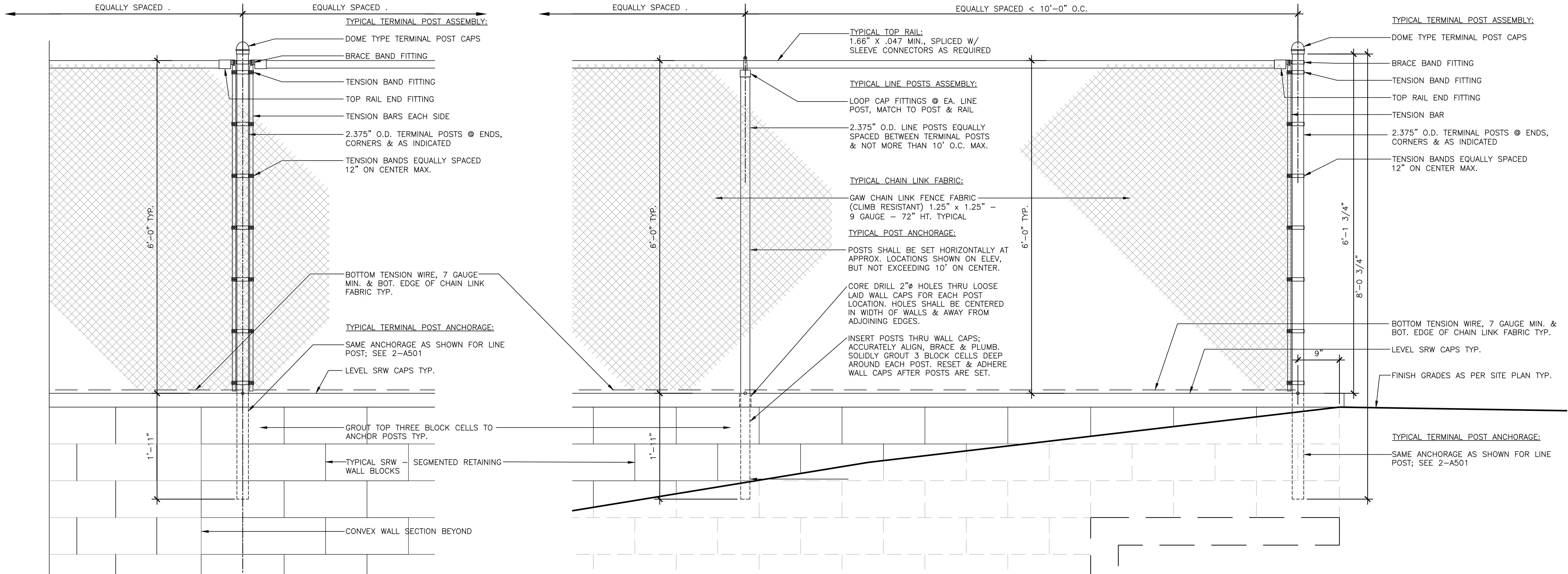

1 TYPICAL CORNER POSTS - LEVEL TOP
A-501 1" = 1'-0"

2 TYPICAL LINE POSTS - LEVEL TOP
A-501 1" = 1'-0"

3 TYPICAL END POSTS - LEVEL TOP
A-501 1" = 1'-0"

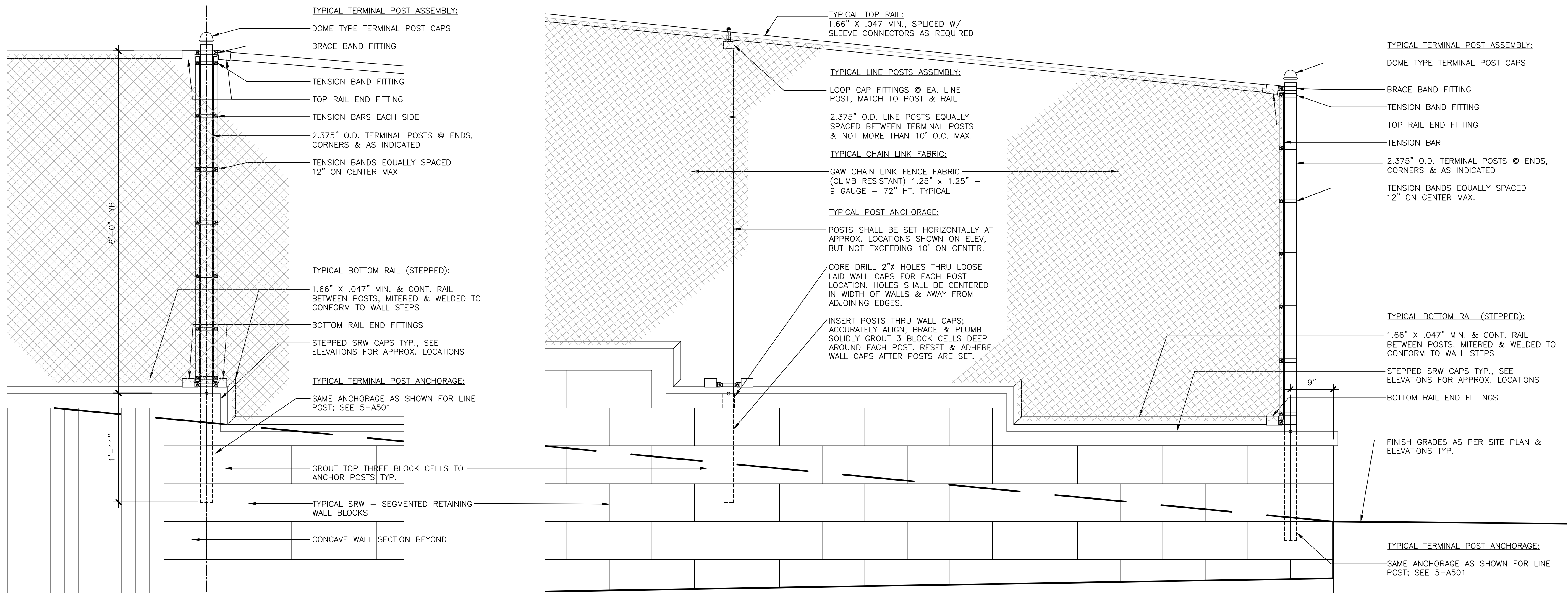

4 TYPICAL CORNER POSTS - STEPPED TOP
A-501 1" = 1'-0"

5 TYPICAL LINE POSTS - STEPPED TOP
A-501 1" = 1'-0"

5 TYPICAL END POSTS - STEPPED TOP
A-501 1" = 1'-0"

STATE OF MISSOURI
MIKE KEHOE,
GOVERNOR



Brad M. Schaefer - Architect
MO# A-2009027294

BID DOCUMENTS

OFFICE OF ADMINISTRATION
DIVISION OF FACILITIES
MANAGEMENT,
DESIGN AND CONSTRUCTION

DEPARTMENT OF
Elementary and Secondary
Education

REPLACE RETAINING WALLS
STATE SCHOOL BUILDING

Mississippi Valley State School
312 Munger Lane
Hannibal, Missouri

PROJECT # E2401-01
SITE # 2039
ASSET # 5012039004

REVISION:
DATE:
REVISION:
DATE:
REVISION:
DATE:
ISSUE DATE: 03/15/2025

CAD DWG FILE: BS
DRAWN BY: TEH
CHECKED BY: BS
DESIGNED BY: TEH

SHEET TITLE:
FENCE DETAILS

SHEET NUMBER:

A-501

8 OF 9 SHEETS
03/15/2025

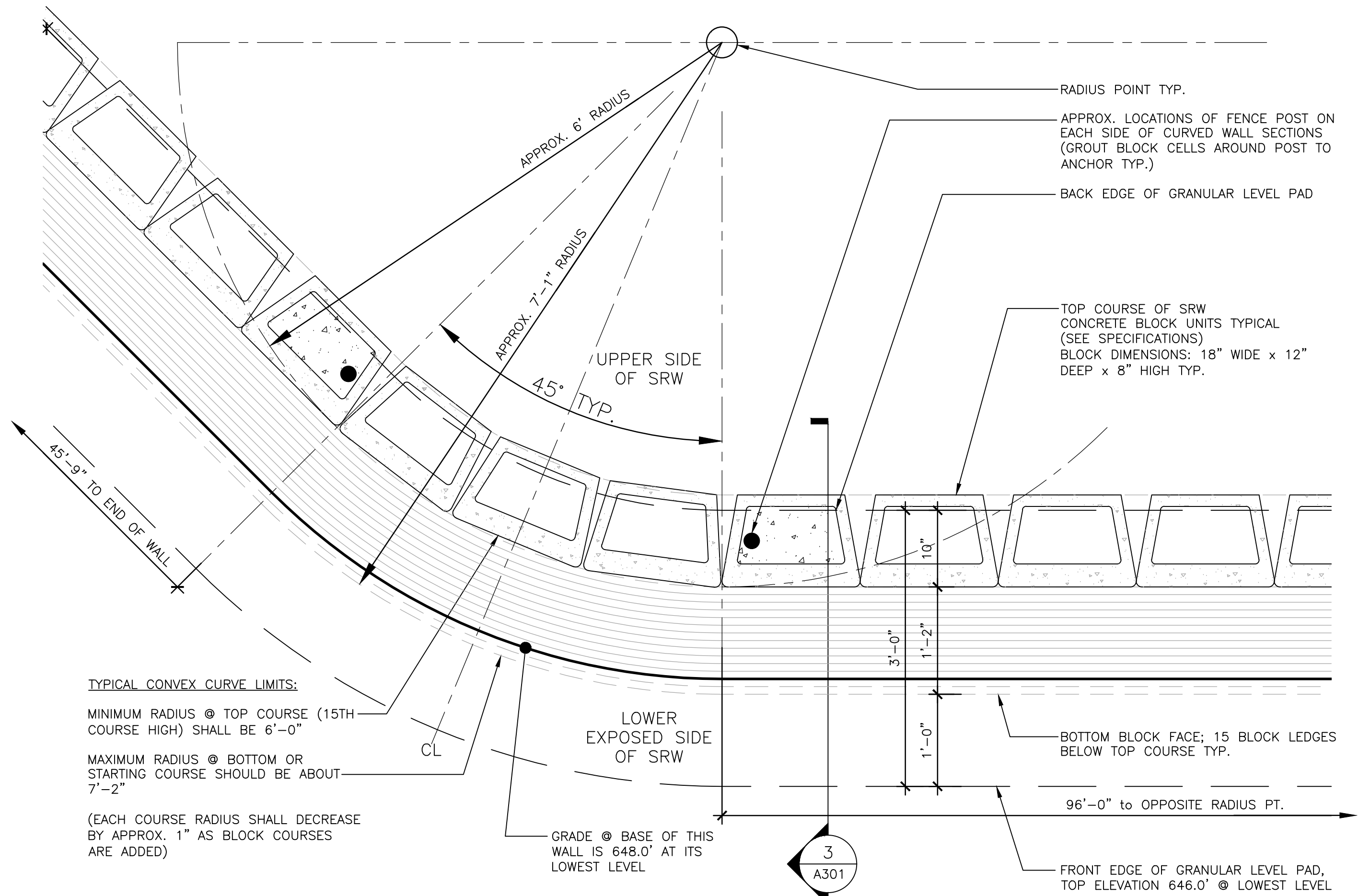

1 CONVEX WALL PLAN - CUT @ TOP BLOCK COURSE
A-502/1" = 1'-0"

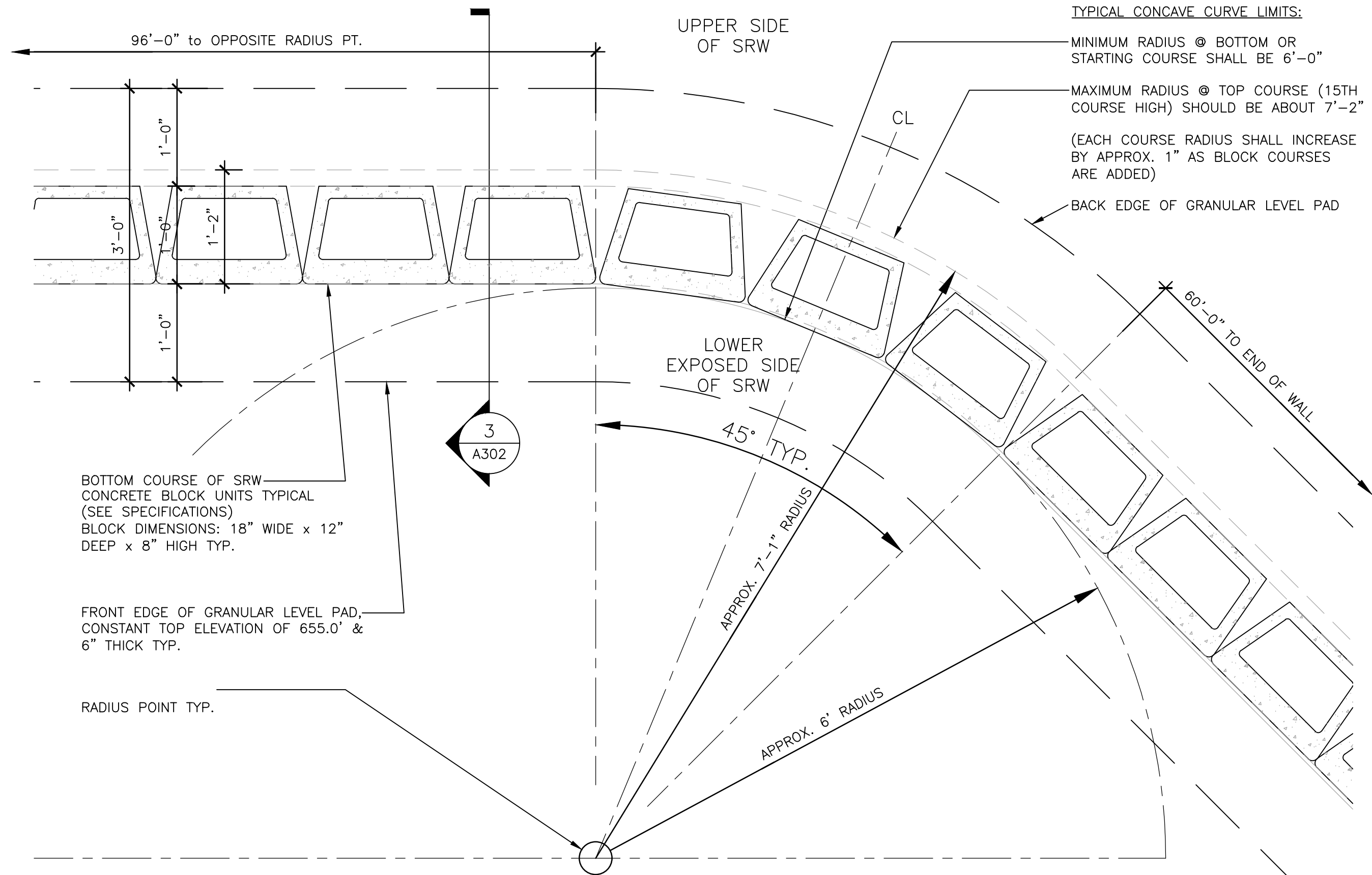

2 CONCAVE WALL PLAN - CUT @ BOTTOM BLOCK COURSE
A-502/1" = 1'-0"

STATE OF MISSOURI
MIKE KEHOE,
GOVERNOR



Brad M. Schaefer - Architect
MO# A-2009027294

BID DOCUMENTS

OFFICE OF ADMINISTRATION
DIVISION OF FACILITIES
MANAGEMENT,
DESIGN AND CONSTRUCTION

DEPARTMENT OF
Elementary and Secondary
Education

REPLACE RETAINING WALLS
STATE SCHOOL BUILDING

Mississippi Valley State School
312 Munger Lane
Hannibal, Missouri

PROJECT # E2401-01
SITE # 2039
ASSET # 5012039004

REVISION: _____
DATE: _____
REVISION: _____
DATE: _____
REVISION: _____
DATE: _____

ISSUE DATE: 03/15/2025

CAD DWG FILE: BS _____
DRAWN BY: TEH _____
CHECKED BY: BS _____
DESIGNED BY: TEH _____

SHEET TITLE:
MISCELLANEOUS
DETAILS

SHEET NUMBER:

A-502

9 OF 9 SHEETS
03/15/2025