

ADDENDUM NO. 2

TO: PLANS AND SPECIFICATIONS FOR STATE OF MISSOURI

Replace Fire Alarm Panels and Devices, Administration Building
Hawthorn Children's Psychiatric Hospital
St Louis, Missouri
Project No.: M2414-01

Bid Opening Date: 1:30 PM, April 24, 2025 (NOT CHANGED)

Bidders are hereby informed that the construction Plans and/or Specifications are modified as follows:

SPECIFICATION CHANGES:

1. SECTION 011000 - SUMMARY OF WORK

a. REVISE the following to Part 1, Paragraph 1.2.:

D. The Work consists of removal **and disposal** of the existing fire alarm...

DRAWING CHANGES:

1. Drawing C-101 - ADMINISTRATION BUILDING SITE PLAN

a. ADD Project Phasing:

1. Add note to the sheet describing symbol for project.
2. Add project phasing designations to the sheet.

b. See attached revised sheet for revisions.

2. Drawing G-002 - GENERAL NOTES, ABBREVIATIONS, AND CODES

a. ADD ASHRAE / APIC Required Infection Control Precautions:

	<u>During Construction Project</u>	<u>Upon Completion of Project</u>
CLASS II	<ol style="list-style-type: none">1. Provide active means to prevent airborne dust from dispersing into atmosphere.2. Water mist work surfaces to control dust while cutting.3. Seal unused doors with duct tape.4. Block off and seal air vents.5. Place dust mat at entrance and exit of work area6. Remove or isolate HVAC system in areas where work is being performed.	<ol style="list-style-type: none">1. Wipe work surfaces with disinfectant.2. Contain construction waste before transport in tightly covered containers.3. Wet mop and/or vacuum with HEPA filtered vacuum before leaving work area.4. Remove isolation of HVAC system in areas where work is being performed.

- Plastic Barrier to be placed during drywall cutting in all areas. Barriers need to be from floor to ceiling and taped to the floor.

- When placing panels or removing debris, the hallways need to be cleared of employees. Doors to supply areas are to remain closed.
 - Walk off mats to be used at entrance of all construction areas.
- b. ADD note: All fasteners used for installation of devices are to be tamper proof:
Torx Products
1908 Production Court Louisville, KY 40299
Sales@torxproducts.com
Phone - 800-684-9832 ext. 2
Fax - 502-491-3327
- c. ADD note: Provide wall blocking and fastening at all fire alarm panels, per manufacturer's instructions.
- d. ADD note: Comply with NFPA 99 - 2012
Comply with NFPA 101 - 2012

GENERAL COMMENTS:

1. **Submitted bidder question:** The plans show wire guards for the smokes in the housing areas but not the heats or notification. Are wire guards required? If so on which fire alarm devices?
Response: Yes, wire guards are required on all devices.
2. **Submitted bidder question:** Specifications calls for stainless steel trimmed notification. Is this required? That is not something that is available.
Response: No, stainless steel trim is not required.
3. All fasteners used for installation of devices are to be tamper proof:
Torx Products
1908 Production Court Louisville, KY 40299
Sales@torxproducts.com
Phone - 800-684-9832 ext. 2
Fax - 502-491-3327
4. Please contact Mandy Roberson: 573-522-0074, Mandy.Roberson@oa.mo.gov for questions regarding bidding procedures, MBE/WBE/SDVE Goals, and other submittal requirements.
5. Changes to, or clarification of, the Bid Documents are only made as issued in the Addenda.
6. All correspondence with respect to this project must include the State of Missouri project number as indicated above.
7. Current Plan Holders list is available online at: <https://www.oafmdcplanroom.com/projects/2827/plan-holders/m2414-01-replace-fire-alarm-panels-devices-admin-bldg-hawthorn-childrens-psychiatric-hospital>.
8. Prospective Bidders contact American Document Solutions, 1400 Forum Blvd., Suite 7A, Columbia, Missouri 65203, 573-446-7768 to order official plans and specifications.
9. **All bids shall be submitted without additional terms and conditions, modification, or reservation on the bid form with each space properly filled. Bids not on these forms will be rejected. Failure to do so will result in rejection of the bid.**
MBE/WBE/SDVE participation requirements can be found in DIVISION 00.
MBE/WBE/SDVE Goals: MBE 10%, WBE 10%, and SDVE 3%. NOTE: Only MBE/WBE firms certified by the State of Missouri Office of Equal Opportunity as of the date of bid opening, or SDVE(s) meeting the requirements of Section 34.074,

RSMo and 1 CSR 30-5.010, can be used to satisfy the MBE/WBE/SDVE participation goals for this project. No other certifications from other Missouri certifying agencies will be accepted. If a bidder is unable to meet a participation goal, a Good Faith Effort Determination Form must be completed. Failure to complete this process will result in rejection of the bid.

ATTACHMENTS:

1. Drawing C-101 - ADMINISTRATION BUILDING SITE PLAN.

April 17, 2025

END ADDENDUM NO. 2

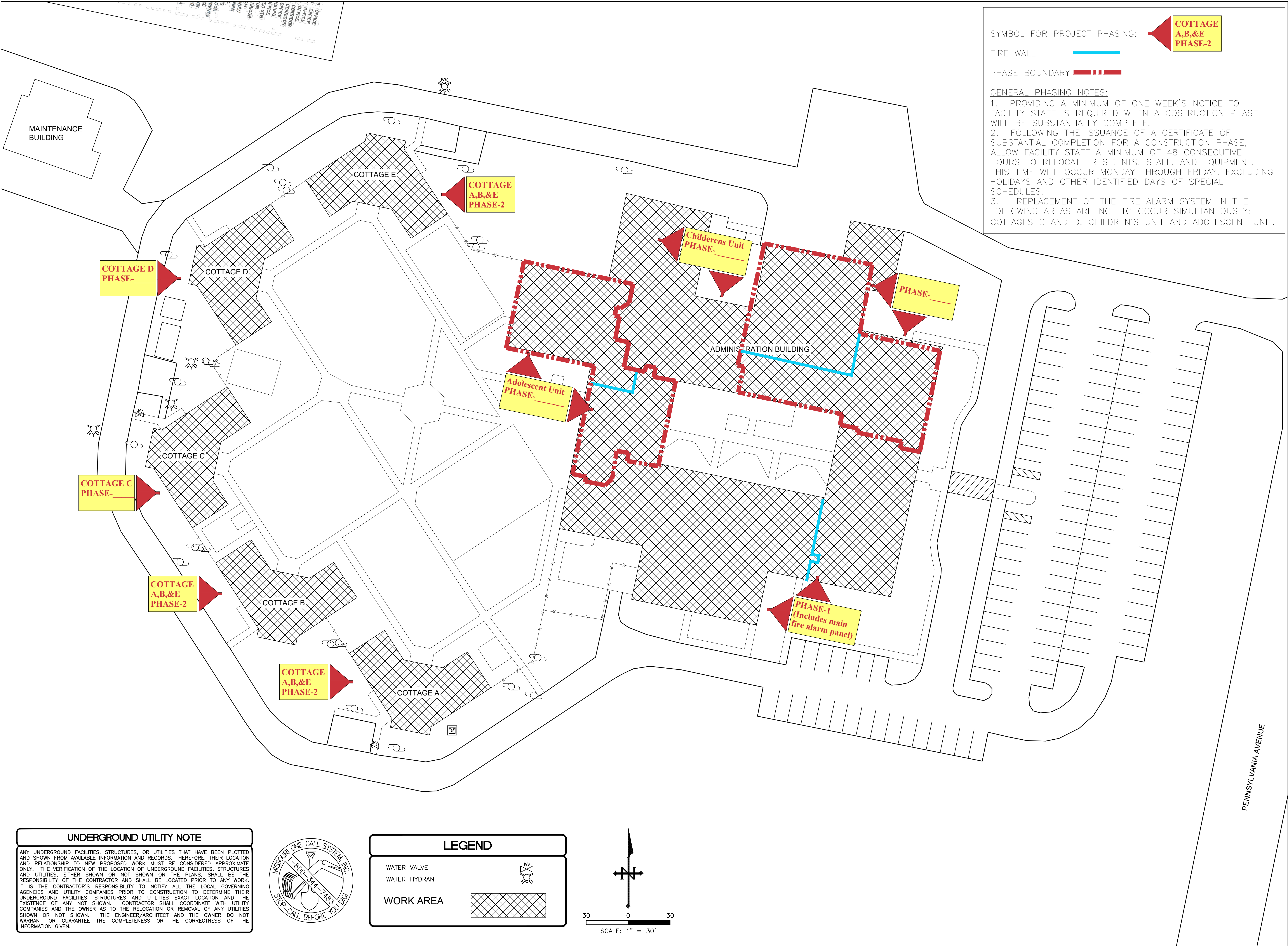

SIGNATURE
DATE
LICENSE EXPIRES

PROFESSIONAL SEAL



Hurst-Rosche, Inc.
PROFESSIONAL DESIGN NUMBER: 000372
3675 W. Outer Road, Suite 205
Arnold, MO 63010
636.333.3351 t
www.hurst-rosche.com
HILLSBORO, IL
EAST ST. LOUIS, IL
MARION, IL
SPRINGFIELD, IL
NASHVILLE, TN

OFFICE OF ADMINISTRATION
DIVISION OF FACILITIES
MANAGEMENT,
DESIGN AND CONSTRUCTION

DEPARTMENT OF
MENTAL HEALTH
REPLACE FIRE ALARM PANELS
AND DEVICES,
ADMINISTRATION BUILDING
HAWTHORN CHILDREN'S
PSYCHIATRIC HOSPITAL
1901 PENNSYLVANIA AVENUE
ST. LOUIS, MISSOURI 63133

PROJECT # M2414-01
SITE # 7390
ASSET # 6517390002

REVISION: ADDENDUM-2
DATE: 4/17/2025
REVISION:
DATE:
REVISION:
DATE:
ISSUE DATE: JAN. 10, 2025

CAD DWG FILE: C-101.DWG
DRAWN BY: AJD/JSM
CHECKED BY: JCZ
DESIGNED BY: JCZ

SHEET TITLE:
ADMINISTRATION
BUILDING
SITE PLAN

SHEET NUMBER:

C-101

03 OF 08 SHEETS
JAN. 10, 2025