

# REPLACE ROOF SYSTEM KANSAS CITY DOLIR OFFICE BUILDING KANSAS CITY , MISSOURI

---

OWNER: STATE OF MISSOURI  
MICHAEL L. PARSON,  
GOVERNOR  
  
DEPARTMENT OF  
LABOR AND INDUSTRIAL  
RELATIONS

PROJECT  
MANAGEMENT: OFFICE OF ADMINISTRATION  
DIVISION OF FACILITIES MANAGEMENT,  
DESIGN AND CONSTRUCTION

DESIGNER: STATE OF MISSOURI - OFFICE OF ADMINISTRATION  
DIVISION OF FACILITIES MANAGEMENT,  
DESIGN AND CONSTRUCTION  
301 W. HIGH STREET  
JEFFERSON CITY, MO 65102

PROJECT NUMBER: O2325-01

ASSET NUMBER: 3101018001

SHEET NUMBER:

**G-001**

1 OF 7 SHEETS  
8/16/2023

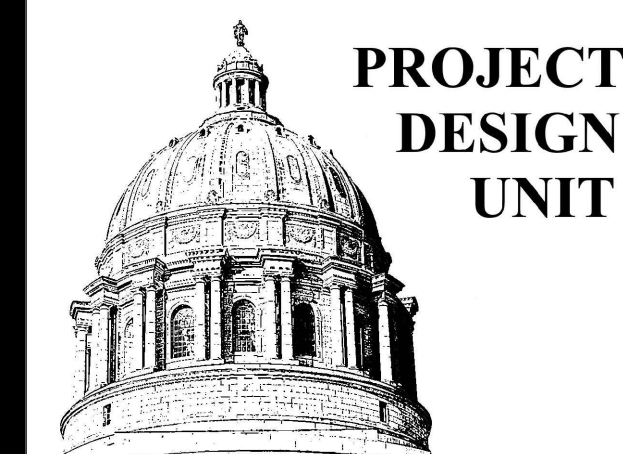

**CONSTRUCTION DOCUMENTS**

OFFICE OF ADMINISTRATION  
DIVISION OF FACILITIES  
MANAGEMENT,  
DESIGN AND CONSTRUCTION

DEPARTMENT OF  
LABOR AND  
INDUSTRIAL RELATIONS

REPLACE ROOF  
SYSTEM

KANSAS CITY  
DOLIR OFFICE BUILDING  
1410 GENESSEE  
KANSAS CITY, MISSOURI

PROJECT # O2325-01

ASSET# 3101018001

REVISION: \_\_\_\_\_  
DATE: \_\_\_\_\_  
REVISION: \_\_\_\_\_  
DATE: \_\_\_\_\_  
REVISION: \_\_\_\_\_  
DATE: \_\_\_\_\_

ISSUE DATE: \_\_\_\_\_

CAD DWG FILE:RTG \_\_\_\_\_  
DRAWN BY: \_\_\_\_\_  
CHECKED BY: \_\_\_\_\_  
DESIGNED BY: LJB

SHEET TITLE:  
**GENERAL  
INFORMATION**

SHEET NUMBER:

**G-101**

2 OF 7 SHEETS  
8/16/2023

**GENERAL NOTES**

PROTECT EXISTING WORK TO REMAIN. PERFORM CUTTING TO ACCOMPLISH REMOVALS NEATLY AND AS SPECIFIED FOR CUTTING NEW WORK. REPAIR ADJACENT CONSTRUCTION AND FINISH DAMAGED DURING REMOVAL WORK. PATCH AS SPECIFIED FOR PATCHING NEW WORK.

THE PREMISES WILL BE OCCUPIED AT ALL TIMES DURING THE CONSTRUCTION SCHEDULE. THE CONTRACTOR SHALL COORDINATE WITH THE OWNER REGARDING ALL INTERRUPTIONS OF UTILITIES, TEMPORARY EXITS, DELIVERIES, AND ALL OTHER JOB REQUIREMENTS. SEE SECTION 012100 FOR ALLOWANCES FOR FACILITY INTERRUPTIONS.

REMOVE AND REINSTALL EXISTING LIGHTNING PROTECTION COMPONENTS TO MATCH EXISTING CONDITIONS. REPLACE ANY DAMAGED COMPONENTS AS REQUIRED TO ENSURE SYSTEM IS FUNCTIONAL CONTRACTOR TO OBTAIN A UL MASTER LABEL.

**SHEET INDEX**

**GENERAL**

G-100 COVER SHEET  
G-101 GENERAL INFORMATION

**ARCHITECTURAL**

D-100 ROOF DEMOLITION PLAN  
A-100 ROOF PLAN A  
A-101 ROOF PLAN B  
A-102 ROOF PLAN C  
A-500 ROOF DETAILS

**PROJECT INFORMATION**

OWNER: STATE OF MISSOURI  
MICHAEL L. PARSON  
GOVERNOR  
DESIGNER: OA-FMDC  
PROJECT MANAGEMENT: OA-FMDC

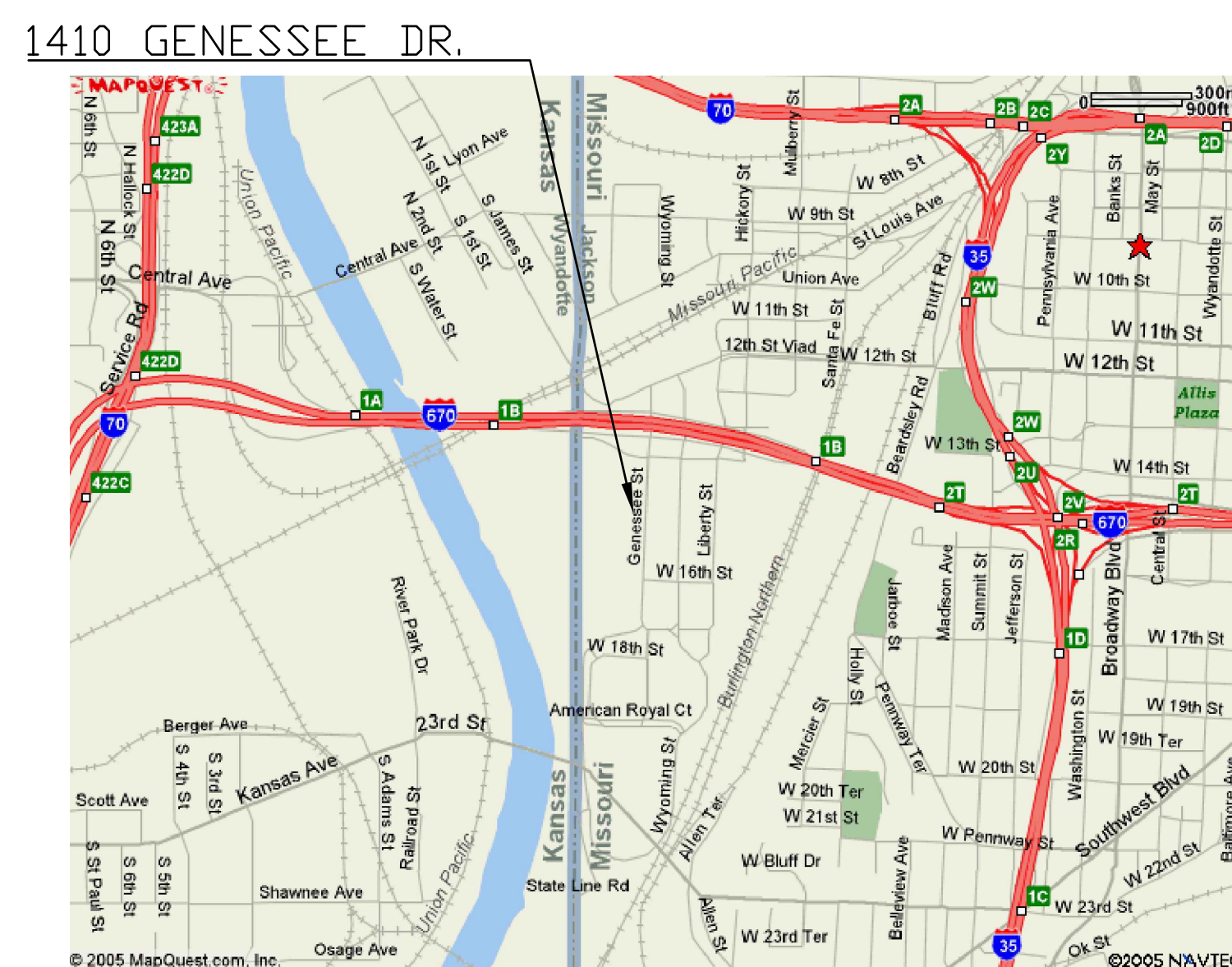

**2 VICINITY MAP**  
SCALE: NTS

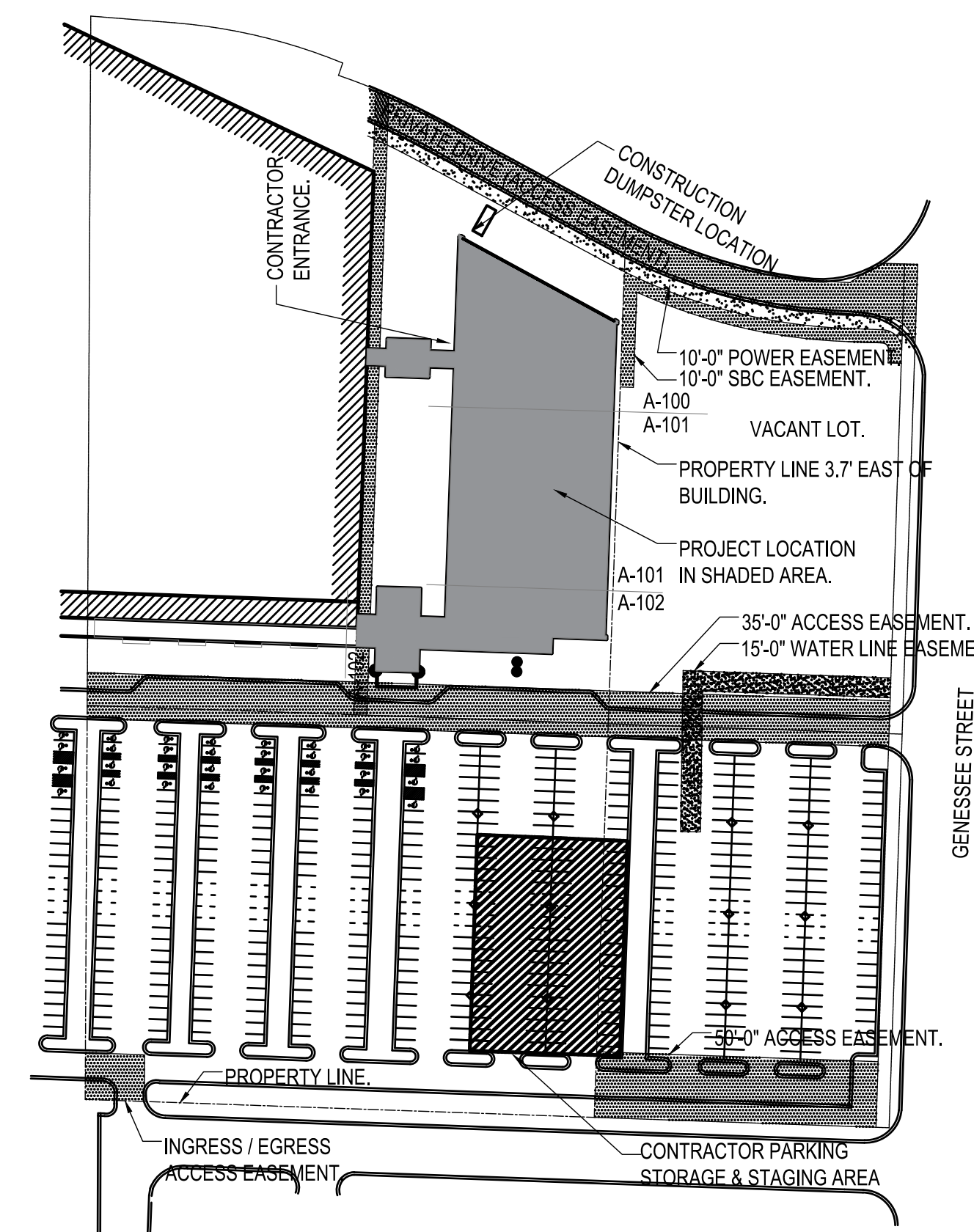

**1 SITE/STAGING PLAN**  
SCALE: NTS





CONSTRUCTION  
DOCUMENTS

OFFICE OF ADMINISTRATION  
DIVISION OF FACILITIES  
MANAGEMENT,  
DESIGN AND CONSTRUCTION

DEPARTMENT OF  
LABOR AND  
INDUSTRIAL RELATIONS

REPLACE ROOF  
SYSTEM

KANSAS CITY  
DOLIR OFFICE BUILDING  
1410 GENESSEE  
KANSAS CITY, MISSOURI

PROJECT # O2325-01

ASSET# 3101018001

REVISION: \_\_\_\_\_  
DATE: \_\_\_\_\_  
REVISION: \_\_\_\_\_  
DATE: \_\_\_\_\_  
REVISION: \_\_\_\_\_  
DATE: \_\_\_\_\_

ISSUE DATE: \_\_\_\_\_

CAD DWG FILE:RTG \_\_\_\_\_  
DRAWN BY: \_\_\_\_\_  
CHECKED BY: \_\_\_\_\_  
DESIGNED BY: LJB \_\_\_\_\_

SHEET TITLE:  
ROOF DEMOLITION  
PLAN

SHEET NUMBER:

D-100

3 OF 7 SHEETS  
8/16/2023

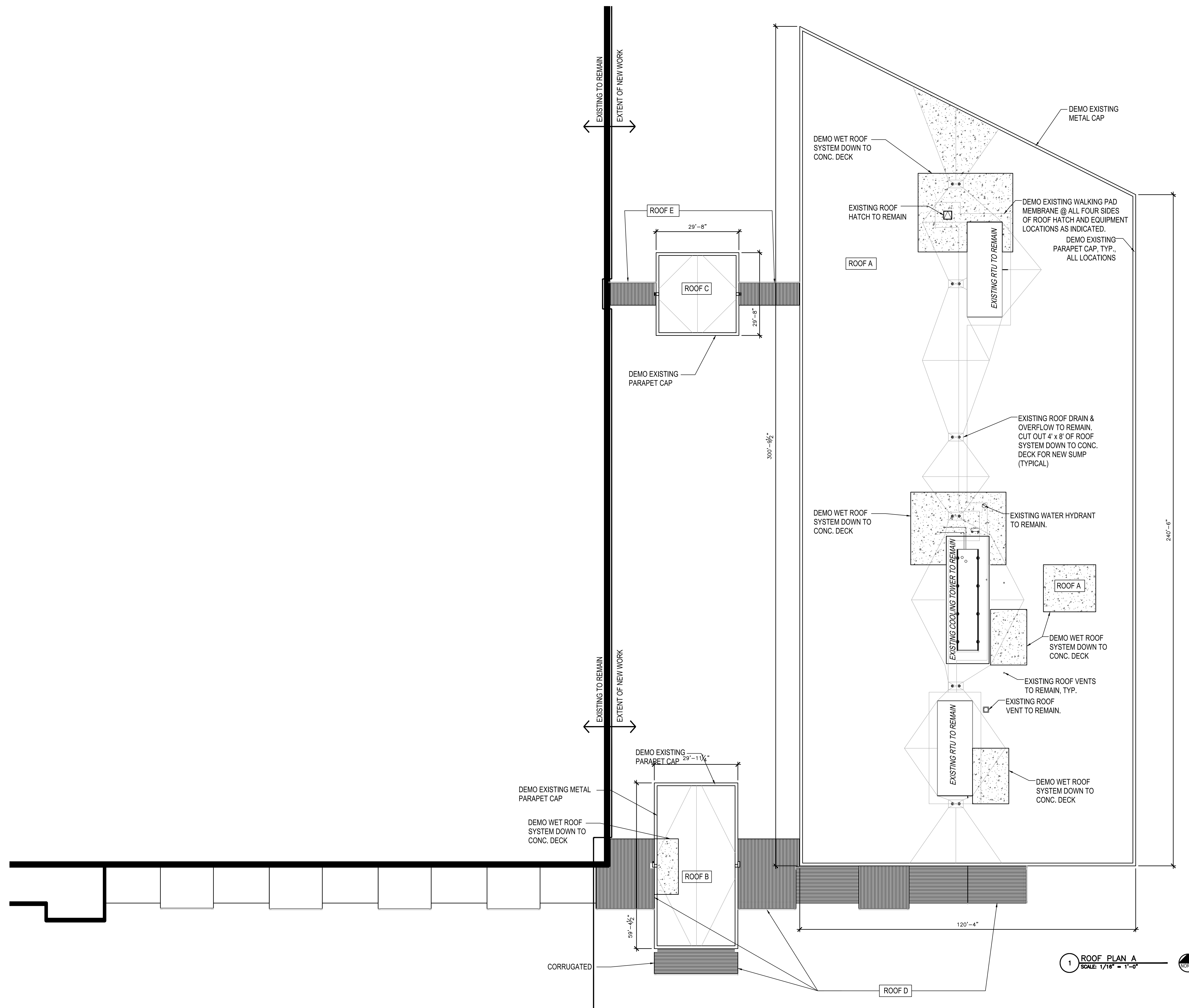



CONSTRUCTION  
DOCUMENTS

OFFICE OF ADMINISTRATION  
DIVISION OF FACILITIES  
MANAGEMENT,  
DESIGN AND CONSTRUCTION

DEPARTMENT OF  
LABOR AND  
INDUSTRIAL RELATIONS

REPLACE ROOF  
SYSTEM

KANSAS CITY  
DOLIR OFFICE BUILDING  
1410 GENESSEE  
KANSAS CITY, MISSOURI

PROJECT # O2325-01

ASSET# 3101018001

REVISION: \_\_\_\_\_  
DATE: \_\_\_\_\_  
REVISION: \_\_\_\_\_  
DATE: \_\_\_\_\_  
REVISION: \_\_\_\_\_  
DATE: \_\_\_\_\_  
ISSUE DATE: \_\_\_\_\_

CAD DWG FILE:RTG \_\_\_\_\_  
DRAWN BY: \_\_\_\_\_  
CHECKED BY: \_\_\_\_\_  
DESIGNED BY: LJB \_\_\_\_\_

SHEET TITLE:  
ROOF PLAN A

SHEET NUMBER:

A-100

4 OF 7 SHEETS  
8/16/2023

GENERAL NOTES:

- EXISTING LOW SLOPE ROOF SYSTEM CONTAINS ASPHALT BUILT-UP ROOFING OVER 1/2" FIBER BOARD OVER 2 1/2" ISO INSULATION BOARD OVER ASPHALT VAPOR BARRIER OVER CONCRETE DECK. EXISTING CONCRETE DECK CONTAINS 1/4" PER FOOT SLOPE. ALL ROOFING MATERIALS TESTED NEGATIVE FOR ASBESTOS
- REMOVE WET ROOFING MATERIALS DOWN TO THE CONCRETE DECK AS SHOWN ON THE ROOF DEMOLITION PLAN AND AS IDENTIFIED DURING DEMOLITION PROCESS. INSTALL NEW INSULATION & COVERBOARD FLUSH WITH TOP OF ADJACENT ROOFING. 500 SQUARE YARDS OF WET ROOFING REPLACEMENT IS INCLUDED IN THE BASE BID.
- CONTRACTOR SHALL FIELD VERIFY ALL DIMENSIONS AND EXISTING CONDITIONS.
- REMOVE ALL TRASH AND DEBRIS FROM THE SITE ON A DAILY BASIS. COORDINATE DUMPSTER/DUMP TRUCK LOCATION AND ACCESS WITH THE OWNER.
- USE MANUFACTURER'S STANDARD DETAILS FOR FLASHING AROUND PLUMBING VENTS, VENT STACKS, ELECTRICAL CONDUITS, ECT., WHETHER SPECIFICALLY SHOWN OR NOT.
- CONTRACTOR IS RESPONSIBLE FOR WATER TIGHTENING THE ROOF AT THE END OF EACH DAY REGARDLESS OF THE WEATHER FORECAST.
- REMOVE & REINSTALL EXISTING LIGHTNING SYSTEM COMPONENTS.

KEYED NOTES:

- INSTALL NEW FLEECE-BACK ROOF MEMBRANE OVER ENTIRE LOW SLOPE ROOF AREAS.
- REPLACE ALL #12 SCREWS ON CORRUGATED METAL ROOFS WITH NEW #14 GASKETED ZINC COATED SCREWS.
- INSTALL LIQUID FLASHING ON CORRUGATED ROOF WHERE ROOF TIES INTO THE CONCRETE WALL. SEE DETAIL 1/A-500.
- EXISTING ROOF DRAIN TO REMAIN. PROVIDE 4' x 8' SUMP AROUND DRAIN AND FLASH PER ROOF MANUFACTURER. SEE DETAIL 5/A-500. INSTALL NEW CAST IRON STRAINERS.
- EXISTING ROOF HATCH TO REMAIN. FLASH PER MANUFACTURER. INSTALL NEW SAFETY HANDRAIL FASTENING TO THE HATCH. SEE DETAIL 7/A-500.
- INSTALL 32" WIDE TPO WALKWAY PAD.
- INSTALL TAPERED INSULATION AS NEEDED TO MAINTAIN SLOPE OF EXISTING CRICKETS WHEN REPLACING WET ROOFING.

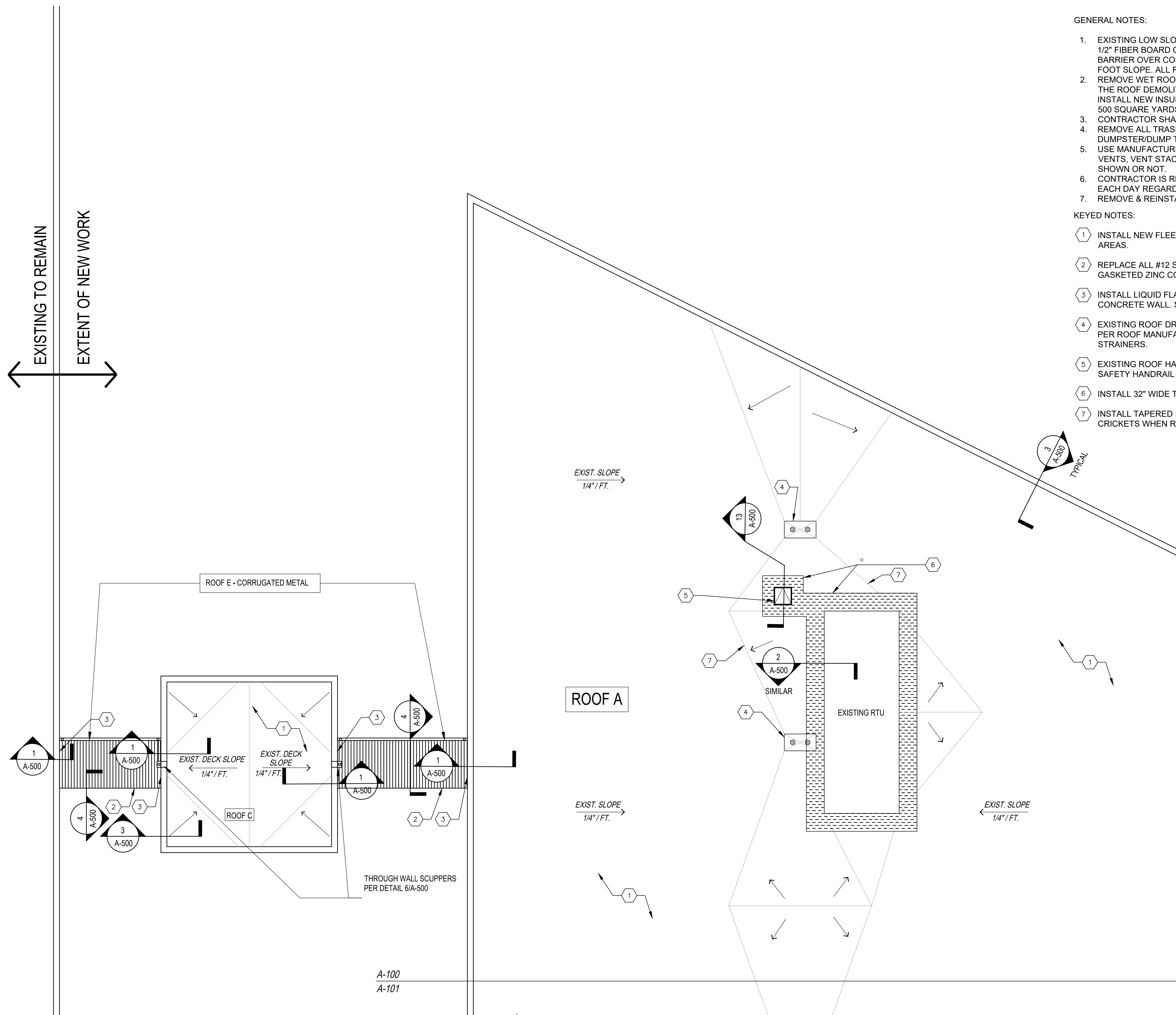

1 ROOF PLAN A  
SCALE: 1/8" = 1'-0"





CONSTRUCTION  
DOCUMENTS

OFFICE OF ADMINISTRATION  
DIVISION OF FACILITIES  
MANAGEMENT,  
DESIGN AND CONSTRUCTION

DEPARTMENT OF  
LABOR AND  
INDUSTRIAL RELATIONS

REPLACE ROOF  
SYSTEM

KANSAS CITY  
DOLIR OFFICE BUILDING  
1410 GENESSEE  
KANSAS CITY, MISSOURI

PROJECT # O2325-01

ASSET# 3101018001

REVISION: \_\_\_\_\_  
DATE: \_\_\_\_\_  
REVISION: \_\_\_\_\_  
DATE: \_\_\_\_\_  
REVISION: \_\_\_\_\_  
DATE: \_\_\_\_\_

ISSUE DATE: \_\_\_\_\_

CAD DWG FILE: RTG \_\_\_\_\_  
DRAWN BY: \_\_\_\_\_  
CHECKED BY: \_\_\_\_\_  
DESIGNED BY: LJB \_\_\_\_\_

SHEET TITLE:  
ROOF PLAN B

SHEET NUMBER:

A-101

5 OF 7 SHEETS  
8/16/2023

GENERAL NOTES:

- EXISTING LOW SLOPE ROOF SYSTEM CONTAINS ASPHALT BUILT-UP ROOFING OVER 1/2" FIBER BOARD OVER 2 1/2" ISO INSULATION BOARD OVER ASPHALT VAPOR BARRIER OVER CONCRETE DECK. EXISTING CONCRETE DECK CONTAINS 1/4" PER FOOT SLOPE. ALL ROOFING MATERIALS TESTED NEGATIVE FOR ASBESTOS
- REMOVE WET ROOFING MATERIALS DOWN TO THE CONCRETE DECK AS SHOWN ON THE ROOF DEMOLITION PLAN AND AS IDENTIFIED DURING DEMOLITION PROCESS. INSTALL NEW INSULATION & COVERBOARD FLUSH WITH TOP OF ADJACENT ROOFING. 5,000 SQUARE FEET OF WET ROOFING REPLACEMENT IS INCLUDED IN THE BASE BID.
- CONTRACTOR SHALL FIELD VERIFY ALL DIMENSIONS AND EXISTING CONDITIONS.
- REMOVE ALL TRASH AND DEBRIS FROM THE SITE ON A DAILY BASIS. COORDINATE DUMPSTER/DUMP TRUCK LOCATION AND ACCESS WITH THE OWNER.
- USE MANUFACTURER'S STANDARD DETAILS FOR FLASHING AROUND PLUMBING VENTS, VENT STACKS, ELECTRICAL CONDUITS, ECT., WHETHER SPECIFICALLY SHOWN OR NOT.
- CONTRACTOR IS RESPONSIBLE FOR WATER TIGHTENING THE ROOF AT THE END OF EACH DAY REGARDLESS OF THE WEATHER FORECAST.
- REMOVE & REINSTALL EXISTING LIGHTNING SYSTEM COMPONENTS.

A-100  
A-101

KEYED NOTES:

- INSTALL NEW FLEECE-BACK ROOF MEMBRANE OVER ENTIRE LOW SLOPE ROOF AREAS.
- EXISTING ROOF DRAIN TO REMAIN. PROVIDE 4' x 8' SUMP AROUND DRAIN AND FLASH PER ROOF MANUFACTURER. SEE DETAIL 5/A-500. INSTALL NEW CAST IRON STRAINERS.
- INSTALL 32" WIDE TPO WALKWAY PAD.
- INSTALL TAPERED INSULATION AS NEEDED TO MAINTAIN SLOPE OF EXISTING CRICKETS WHEN REPLACING WET ROOFING
- FLASH ROOF CURB PER MANUFACTURER

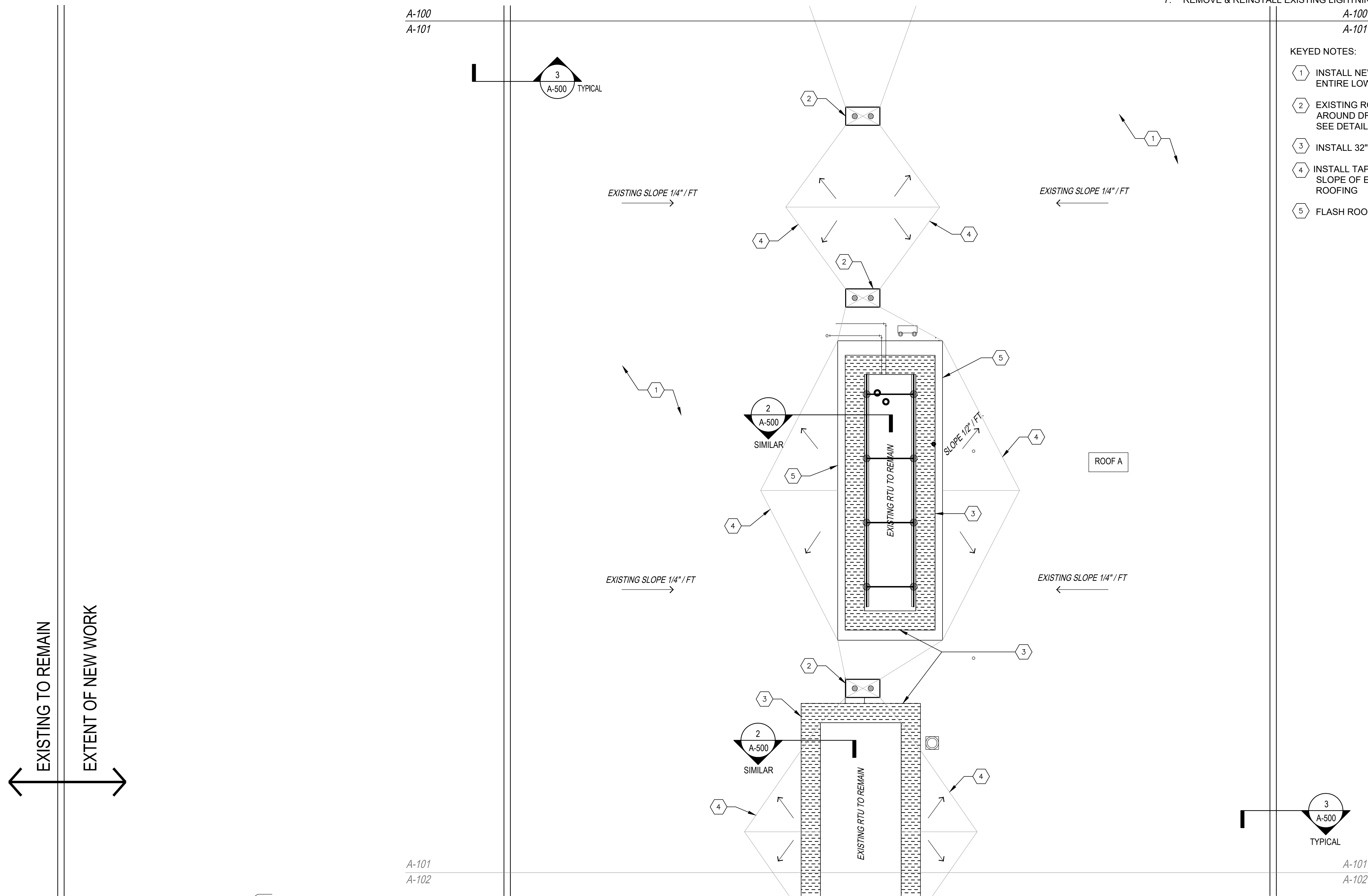

1 ROOF PLAN B  
SCALE: 1/8" = 1'-0"

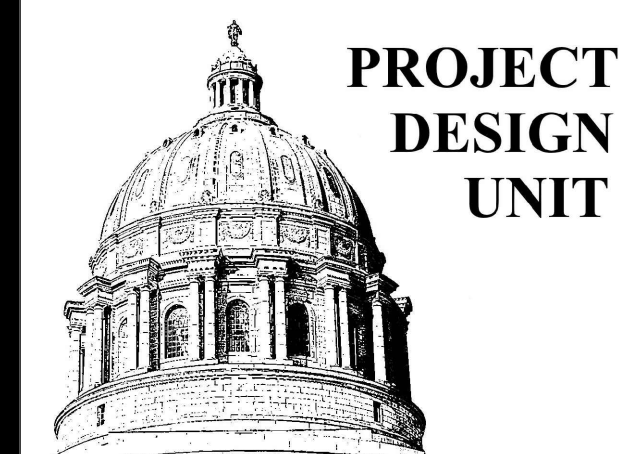

CONSTRUCTION  
DOCUMENTS

OFFICE OF ADMINISTRATION  
DIVISION OF FACILITIES  
MANAGEMENT,  
DESIGN AND CONSTRUCTION

DEPARTMENT OF  
LABOR AND  
INDUSTRIAL RELATIONS

REPLACE ROOF  
SYSTEM

KANSAS CITY  
DOLIR OFFICE BUILDING  
1410 GENESSEE  
KANSAS CITY, MISSOURI

PROJECT # O2325-01

ASSET# 3101018001

REVISION: \_\_\_\_\_  
DATE: \_\_\_\_\_  
REVISION: \_\_\_\_\_  
DATE: \_\_\_\_\_  
REVISION: \_\_\_\_\_  
DATE: \_\_\_\_\_  
ISSUE DATE: \_\_\_\_\_

CAD DWG FILE:RTG  
DRAWN BY: \_\_\_\_\_  
CHECKED BY: \_\_\_\_\_  
DESIGNED BY: LJB

SHEET TITLE:  
ROOF PLAN C

SHEET NUMBER:

A-102

6 OF 7 SHEETS  
8/16/2023

KEYED NOTES:

- 1 INSTALL NEW FLEECE-BACK ROOF MEMBRANE OVER ENTIRE LOW SLOPE ROOF AREAS.
- 2 REPLACE ALL #12 SCREWS ON CORRUGATED METAL ROOFS WITH NEW #14 GASKETED ZINC COATED SCREWS.
- 3 INSTALL LIQUID FLASHING ON CORRUGATED ROOF WHERE ROOF TIES INTO THE CONCRETE WALL. SEE DETAIL 1/A-500.
- 4 EXISTING ROOF DRAIN TO REMAIN. PROVIDE 4' x 8' SUMP AROUND DRAIN AND FLASH PER ROOF MANUFACTURER. SEE DETAIL 5/A-500. INSTALL NEW CAST IRON STRAINERS.
- 5 INSTALL 32" WIDE TPO WALKWAY PAD.
- 6 INSTALL TAPERED INSULATION AS NEEDED TO MAINTAIN SLOPE OF EXISTING CRICKETS WHEN REPLACING WET ROOFING.
- 7 INSTALL ROOF TO ROOF ACCESS LADDER PER OSHA REQUIREMENTS. SEE DETAIL 8/A500.

GENERAL NOTES:

1. EXISTING LOW SLOPE ROOF SYSTEM CONTAINS ASPHALT BUILT-UP ROOFING OVER 1/2" FIBER BOARD OVER 2 1/2" ISO INSULATION BOARD OVER ASPHALT VAPOR BARRIER OVER CONCRETE DECK. EXISTING CONCRETE DECK CONTAINS 1/4" PER FOOT SLOPE. ALL ROOFING MATERIALS TESTED NEGATIVE FOR ASBESTOS
2. REMOVE WET ROOFING MATERIALS DOWN TO THE CONCRETE DECK AS SHOWN ON THE ROOF DEMOLITION PLAN AND AS IDENTIFIED DURING DEMOLITION PROCESS
3. INSTALL NEW INSULATION & COVERBOARD FLUSH WITH TOP OF ADJACENT ROOFING
4. 5,000 SQUARE FEET OF WET ROOFING REPLACEMENT IS INCLUDED IN THE BASE BID. CONTRACTOR SHALL FIELD VERIFY ALL DIMENSIONS AND EXISTING CONDITIONS.
5. REMOVE ALL TRASH AND DEBRIS FROM THE SITE ON A DAILY BASIS. COORDINATE DUMPSTER/DUMP TRUCK LOCATION AND ACCESS WITH THE OWNER.
6. USE MANUFACTURER'S STANDARD DETAILS FOR FLASHING AROUND PLUMBING VENTS, VENT STACKS, ELECTRICAL CONDUITS, ECT., WHETHER SPECIFICALLY SHOWN OR NOT.
7. CONTRACTOR IS RESPONSIBLE FOR WATER TIGHTENING THE ROOF AT THE END OF EACH DAY REGARDLESS OF THE WEATHER FORECAST.
8. REMOVE & REINSTALL EXISTING LIGHTNING SYSTEM COMPONENTS.

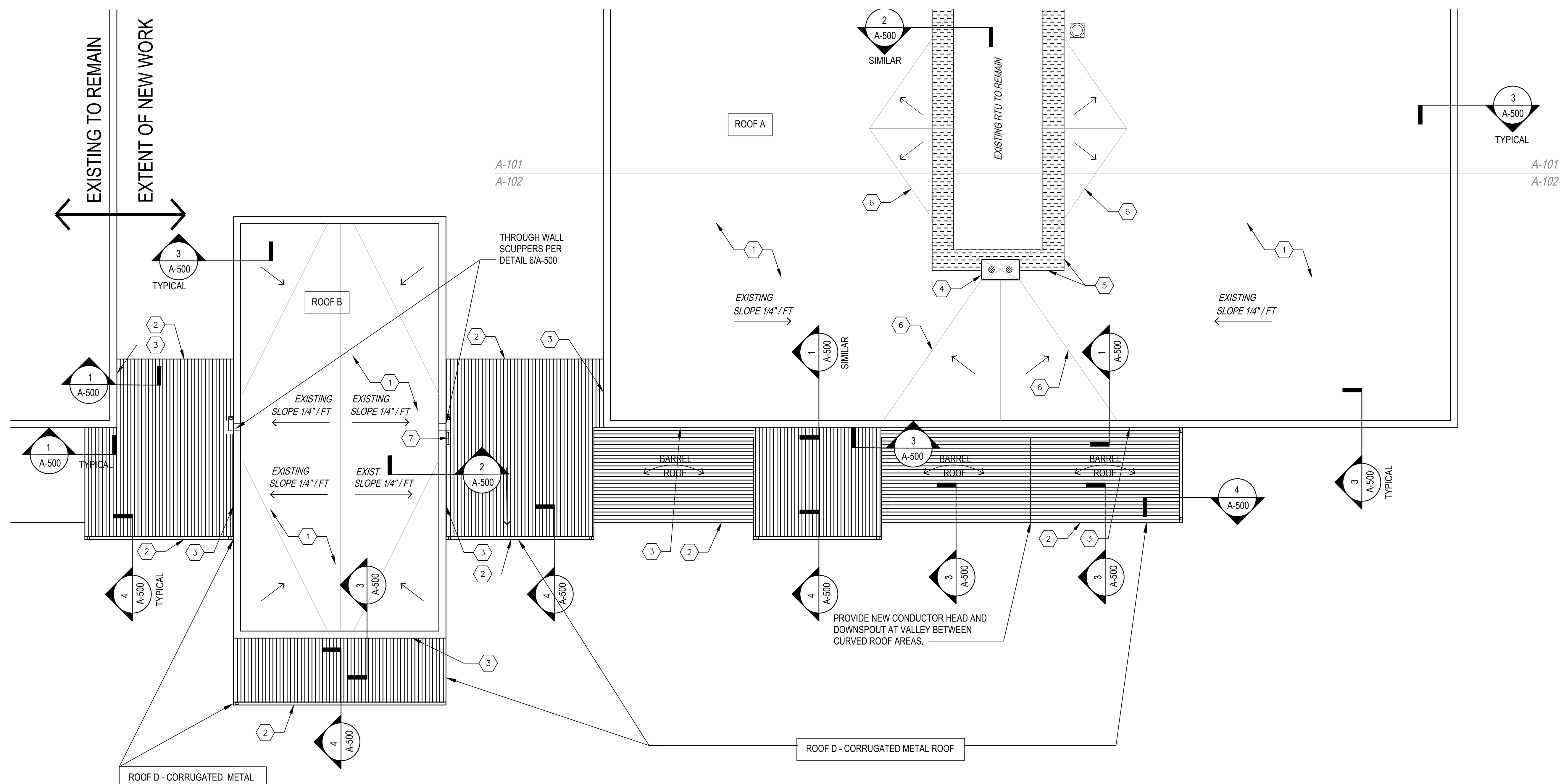

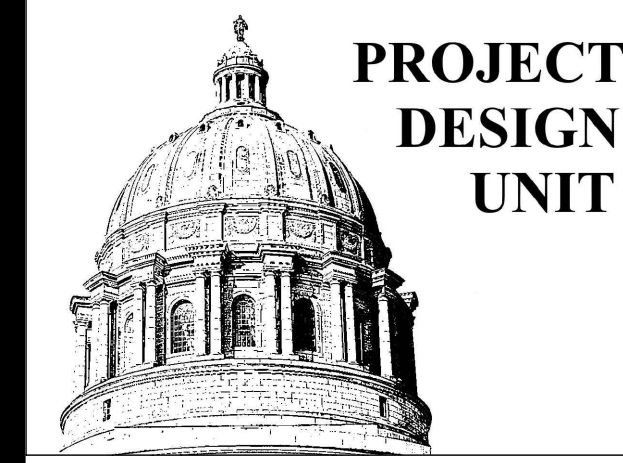

PROJECT  
DESIGN  
UNIT

**CONSTRUCTION  
DOCUMENTS**

OFFICE OF ADMINISTRATION  
DIVISION OF FACILITIES  
MANAGEMENT,  
DESIGN AND CONSTRUCTION

DEPARTMENT OF  
LABOR AND  
INDUSTRIAL RELATIONS

REPLACE ROOF  
SYSTEM

KANSAS CITY  
DOLIR OFFICE BUILDING  
1410 GENESSEE  
KANSAS CITY, MISSOURI

PROJECT # O2325-01

ASSET# 3101018001

REVISION: \_\_\_\_\_  
DATE: \_\_\_\_\_  
REVISION: \_\_\_\_\_  
DATE: \_\_\_\_\_  
REVISION: \_\_\_\_\_  
DATE: \_\_\_\_\_  
ISSUE DATE: \_\_\_\_\_

CAD DWG FILE:RTG  
DRAWN BY: \_\_\_\_\_  
CHECKED BY: \_\_\_\_\_  
DESIGNED BY: LJB

SHEET TITLE:  
**ROOF  
DETAILS**

SHEET NUMBER:

**A-500**

7 OF 7 SHEETS  
8/16/2023

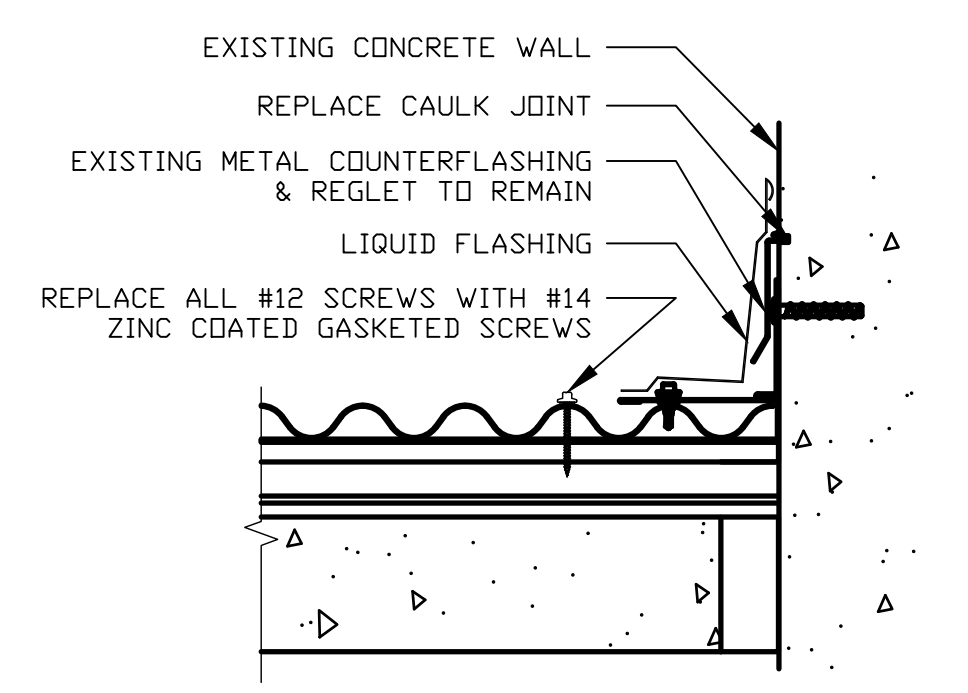

1 SIDEWALL DETAIL  
SCALE: NOT TO SCALE

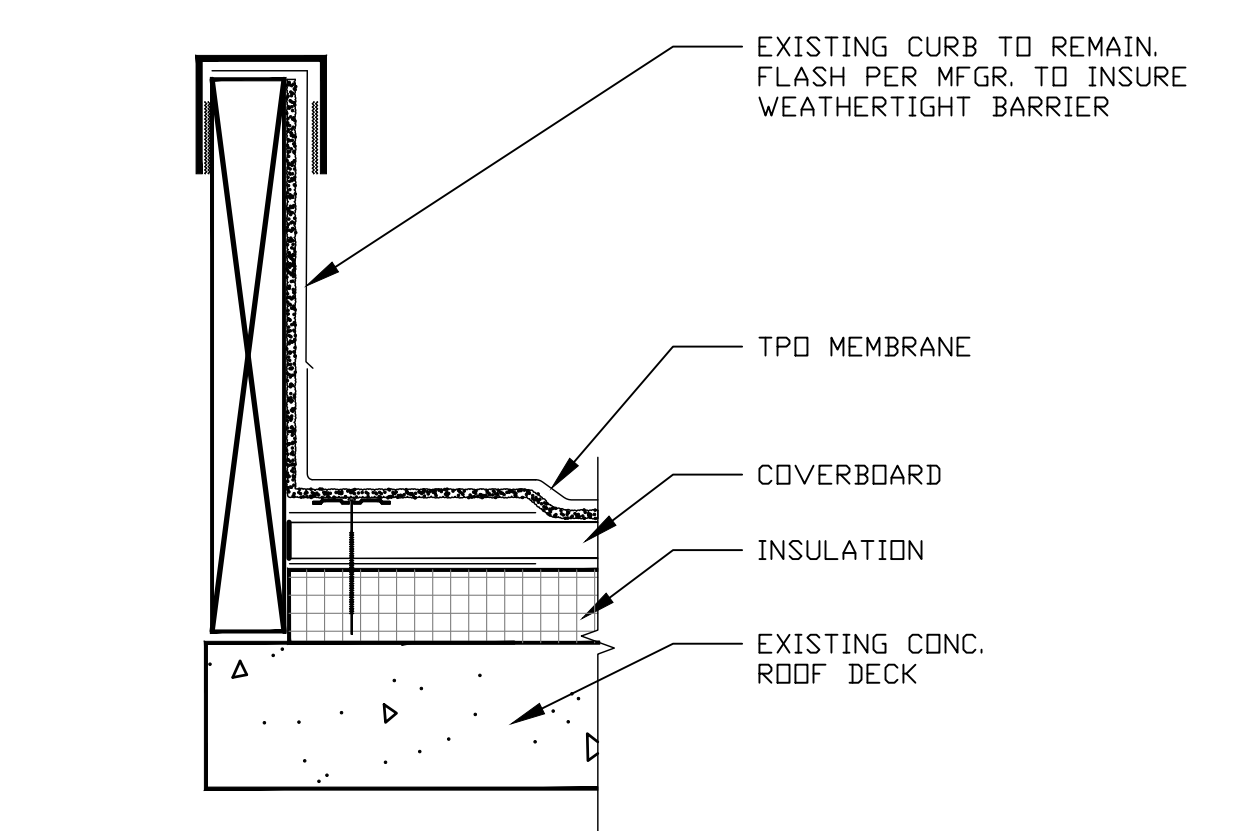

2 ROOF EQUIPMENT CURB  
SCALE: NOT TO SCALE

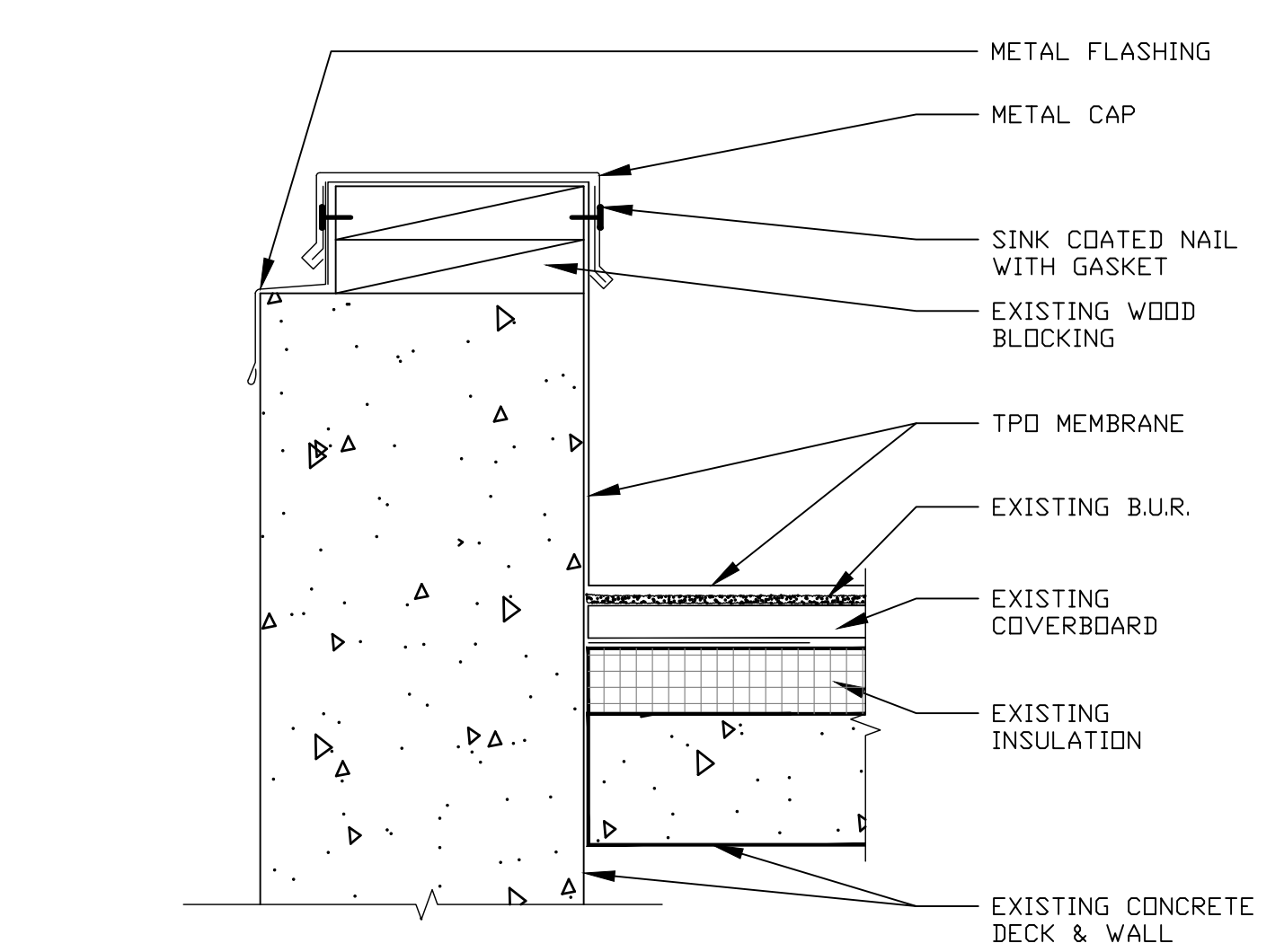

3 PARAPET DETAIL  
SCALE: NOT TO SCALE

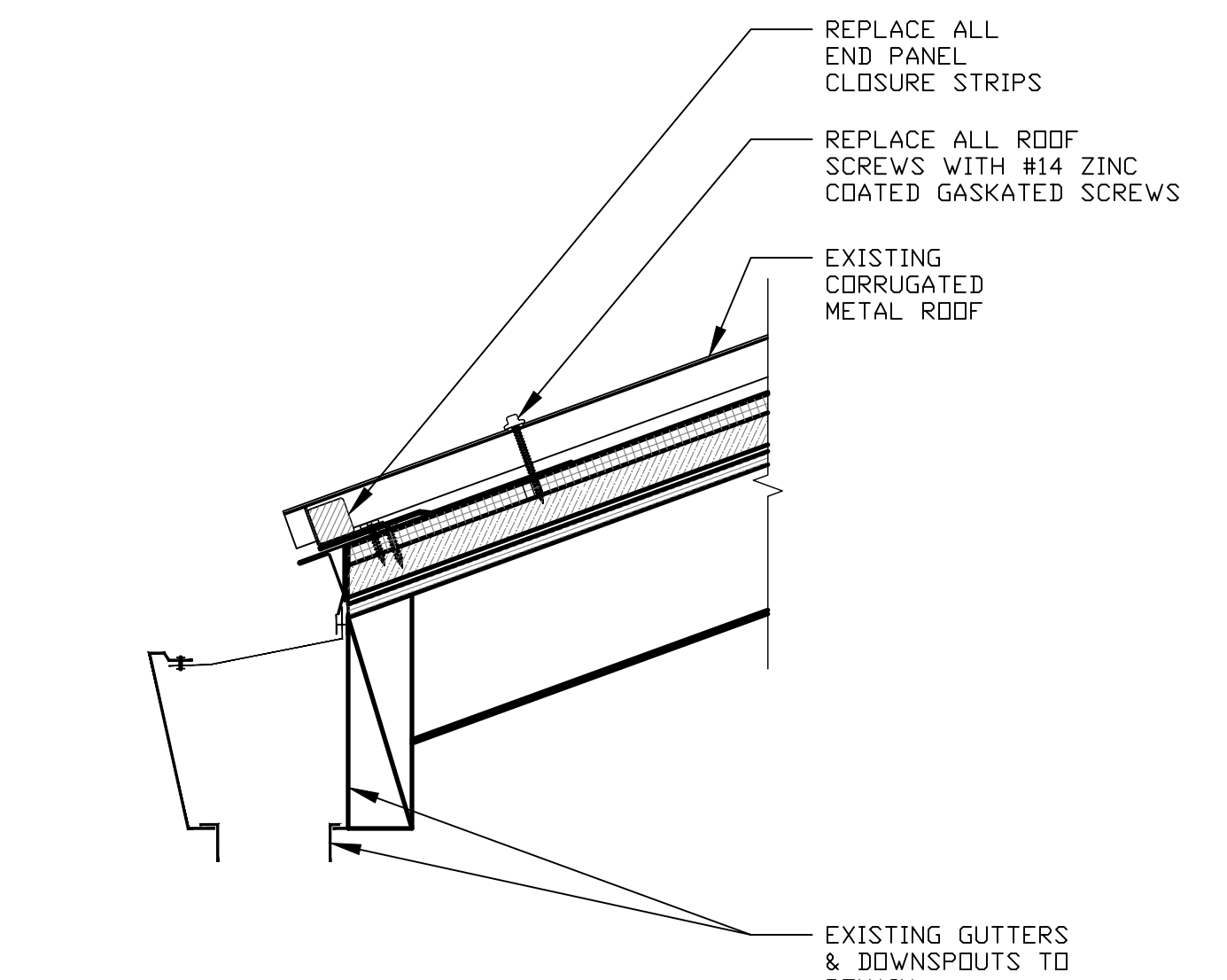

4 EAVE DETAIL  
SCALE: NOT TO SCALE

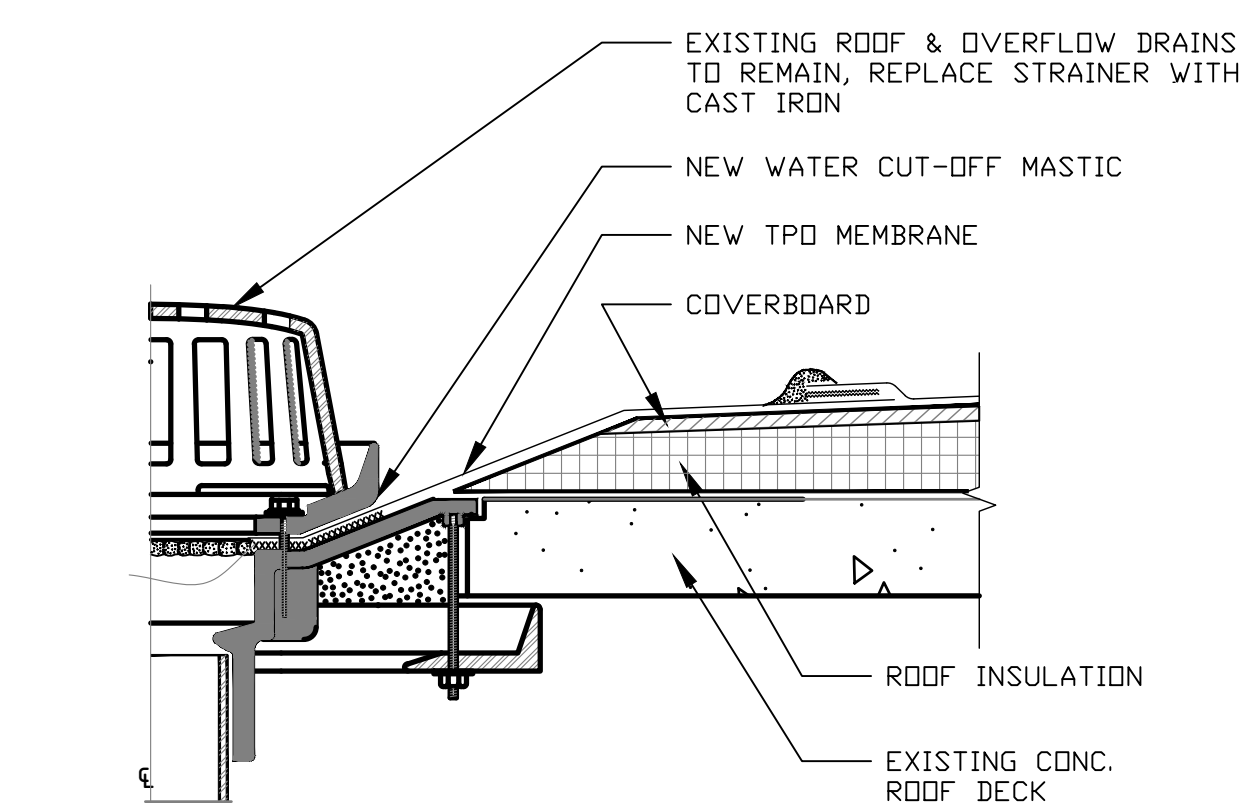

5 TYP ROOF DRAIN DETAIL  
SCALE: NOT TO SCALE

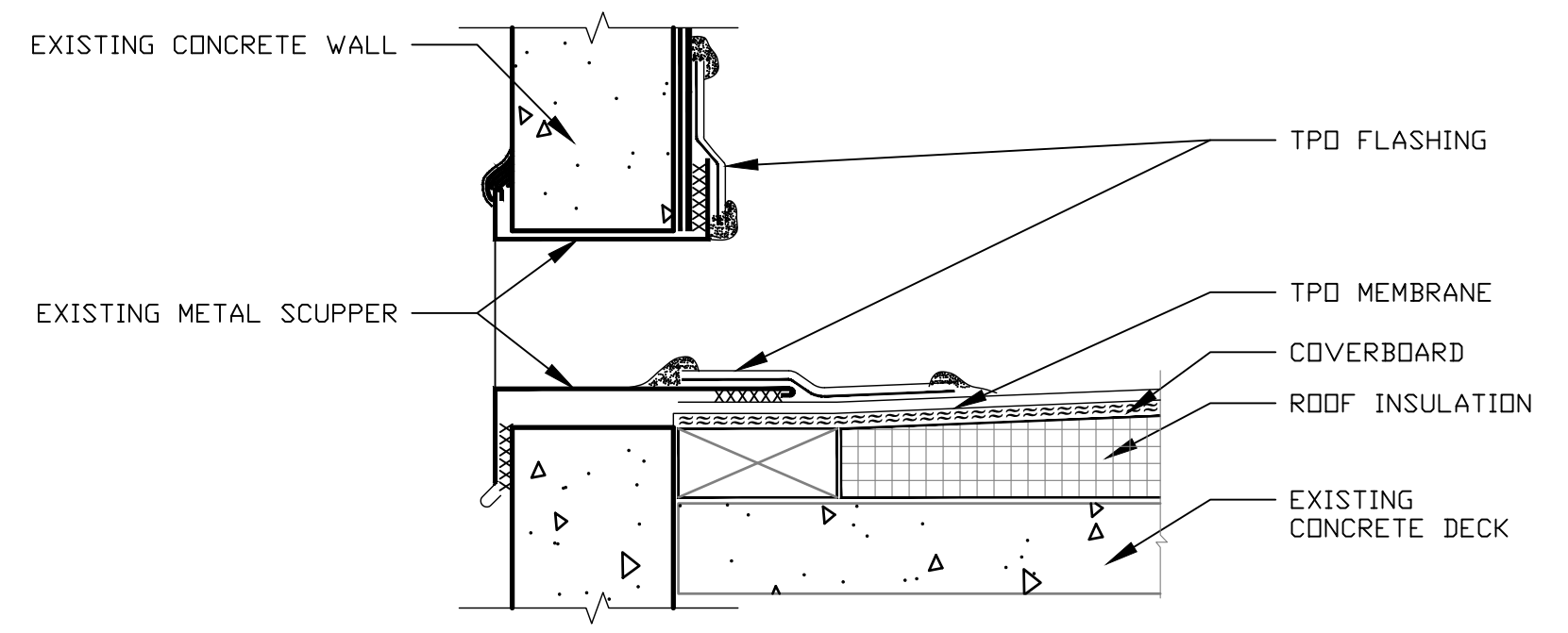

6 THRU WALL SCUPPER  
SCALE: NOT TO SCALE

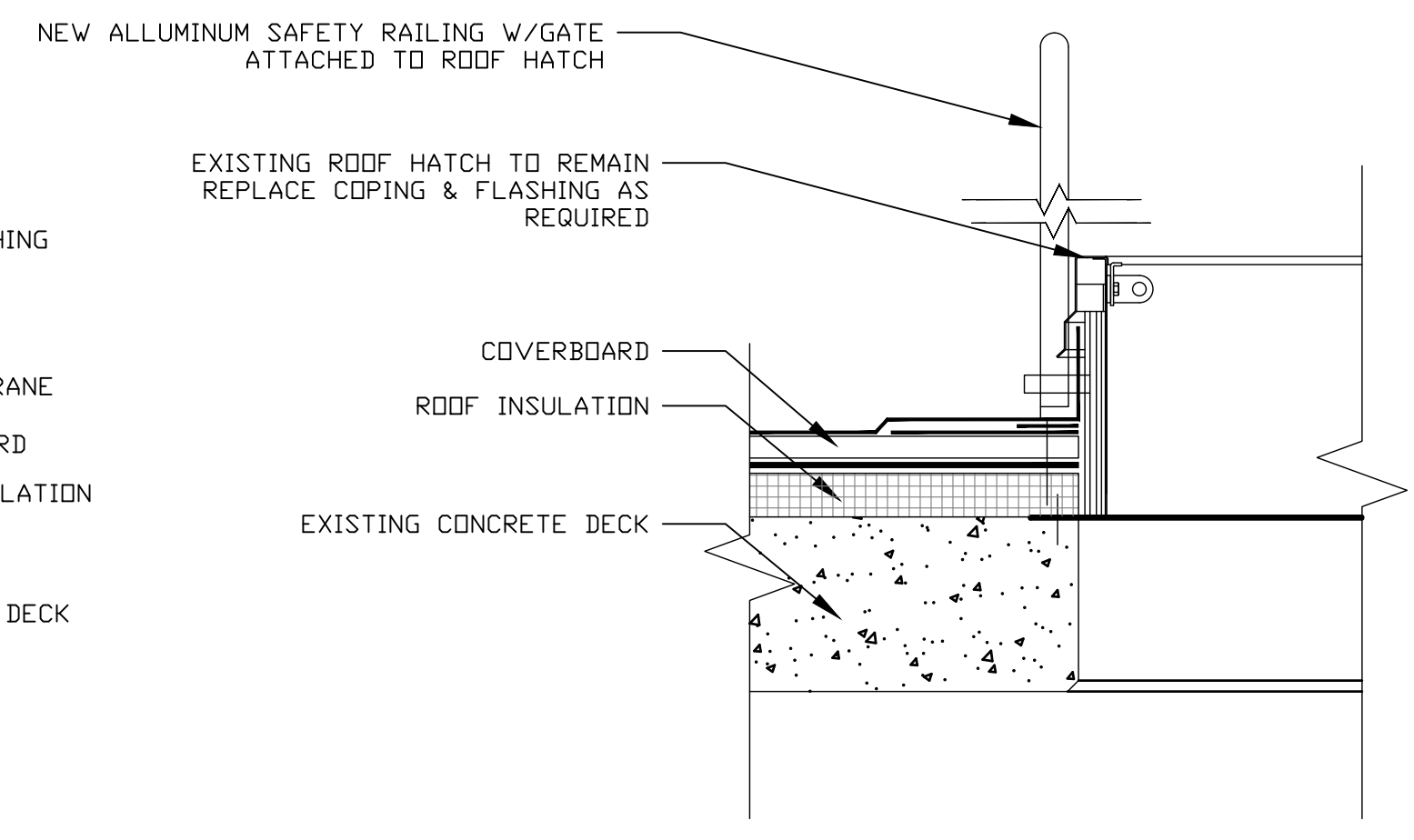

7 ROOF HATCH (EXISTING TO REMAIN)  
SCALE: NOT TO SCALE

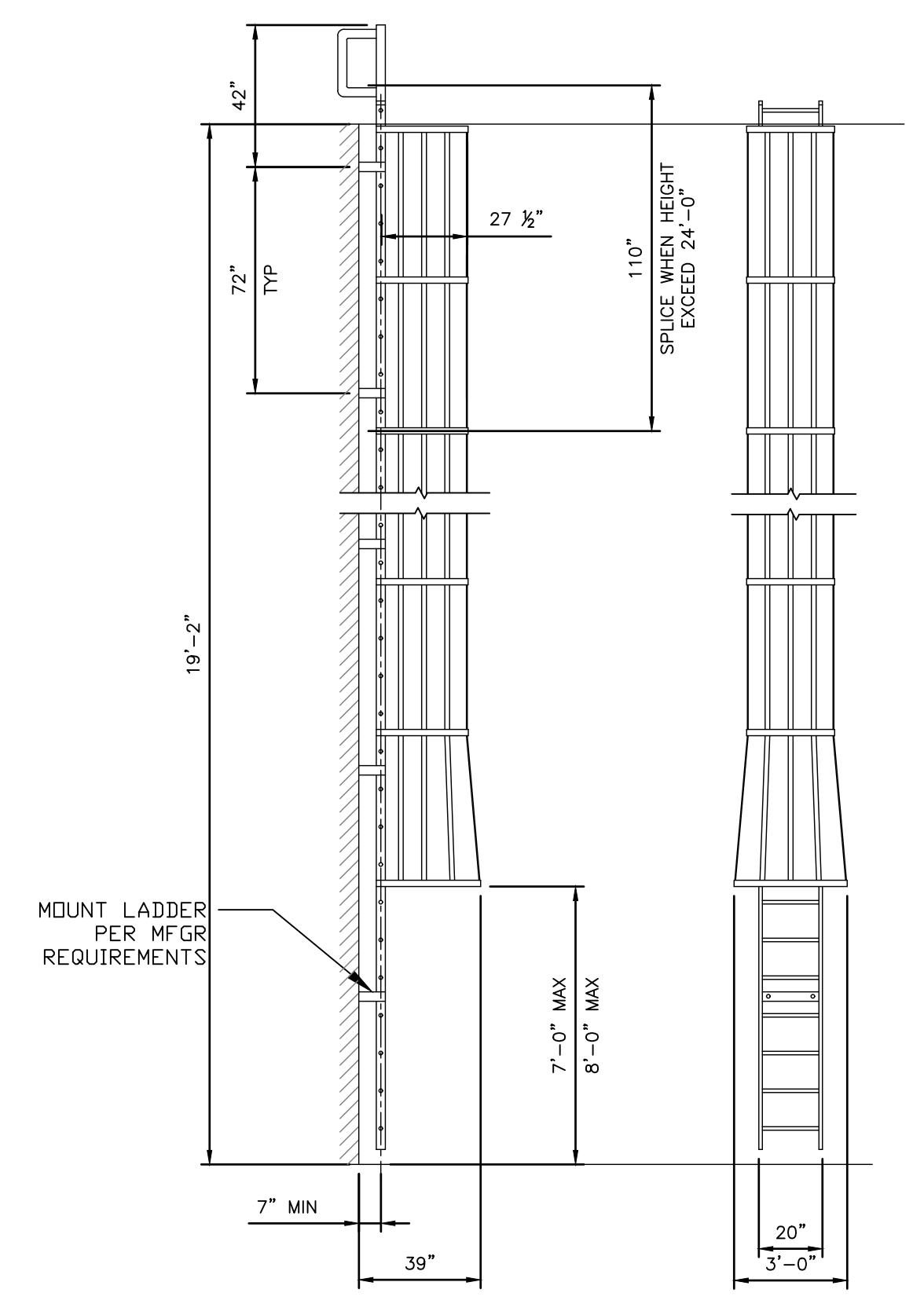

8 CAGED LADDER DETAIL  
SCALE: NOT TO SCALE