

ADDENDUM NO. 1

TO: PLANS AND SPECIFICATIONS FOR STATE OF MISSOURI
CONSTRUCT ADDITION & EXISTING BUILDING RE-ROOF
JOPLIN READINESS CENTER
JOPLIN, MISSOURI
PROJECT NO. T2333-01

Bid Opening Date: 1:30 PM, Thursday, August 29, 2024 (Not Changed)

Bidders are hereby informed that the Construction Plans and/or Specifications are modified as follows:

SPECIFICATION CHANGES:

1. Section 133419 – Metal Building Systems
 - a. ADD Paragraph 2.1-A.37 as follows:
37. American Standard Steel Building Systems

DRAWING CHANGES:

1. Sheet M-152
 - a. REMOVE original sheet and REPLACE with attached sheet.
2. Sheet M-153
 - a. REMOVE original sheet and REPLACE with attached sheet.

GENERAL COMMENTS:

1. The Pre-Bid Meeting was held August 15, 2024 followed by a walk-thru of the project site. The Pre-Bid Meeting sign-in sheet is attached.
2. Please contact Mandy Roberson, Contract Specialist, at 573-522-0074 or mandy.roberson@oa.mo.gov for questions regarding bidding procedures and MBE/WBE/SDVE goals and submittal requirements.
3. The deadline for technical questions was 12:00 PM on August 21, 2024.
4. Changes to, or clarification of, the bid documents are only made as issued in the addenda.
5. All correspondence with respect to this project must include the State of Missouri project number as indicated above.
6. Prospective Bidders contact American Document Solutions, 1400 Forum Blvd Suite 7A, Columbia MO 65203, (573) 446-7768 to get plans and specifications.
7. Current Planholders list is available online at: [T2333-01 Construct Addition & Existing Building Re-Roof-Joplin Readiness Center :: Plan Holders :: State of Missouri Office of Administration \(oafmdcplanroom.com\)](https://oafmdcplanroom.com)

8. All bids shall be submitted on the bid form without additional terms and conditions, modifications, or stipulations. Each space on the bid form shall be properly filled including an amount for each alternate. Failure to do so will result in rejection of the bid.
9. MBE/WBE/SDVE participation requirements can be found in DIVISION 00. The MBE/WBE/SDVE participation goals are 10%/10%/3%, respectively. Only certified firms as of the bid opening date can be used to satisfy the MBE/WBE/SDVE participation goals for this project. If a bidder is unable to meet a participation goal, a Good Faith Effort Determination Form must be completed. Failure to complete this process will result in rejection of the bid.
10. Alternate amounts shall be entered as the amount associated with the listed alternate and should not include the base bid.

ATTACHMENTS:

1. Pre-Bid Meeting Sign-In Sheet
2. Sheet M-152
3. Sheet M-153

August 22, 2024

END ADDENDUM NO. 1

PRE-BID MEETING SIGN-IN SHEET

Project: Construct Addition & Existing Building Re-Roof
 Location: Joplin, MO.

Project No.: T2333-01
 Date: 15 AUG 24

NAME	COMPANY	PHONE	EMAIL
Jeremy Newton	Missouri National Guard	573-638-9500 X-37484	jeremy.l.newton.nfg@army.mil
Jonathan wells	GRI	417-540-7483	wellsj7777@gmail.com
Brandon Tichenor	Dirtlevel Landscaping	417-300-3363	brandentichenor@gmail.com
Jake Doss	MacCo Builders	412-540-7812	jdosse@maccobuilders.com
Mike Strickland	MacCo Builders	417-317-4159	mstrickland@maccobuilders.com
Clifton Jarrett	Crossland Const.	620-674-6817	cjarrett@crossland.com
Colton Marion	CSG	417-451-5743	estimating@marionllc.net
Eric Friga	Friga Const	417-887-7134	eric@frigaconst.com
Josh Newton	Ridge Construction	573-308-4490	josh@ridgeconst.com
DL ACKLEY	DL Ackley BEIS	816-400-2316	DAVID.ACKLEY@BROWNSANDROOT.COM
Michael Yeakey	Taylor Overhead Door	417 499 7135	michael.yeakey@moderation.com
Richard Spivry	CDL Electric	417-214-1222	richard.spivry@cdl-electric.com
Walter Brand	BEI	417-986-8309	wbrand@beijoplin.com
Chris Yeager	Joplin Roofing	417 437 1879	joplinroofing@sbcsglobal.net
Michael Ashin	MGT Construction	417 881-0403	estimating@mgtconstruction.com



BUXTON KUBIK DODD
DESIGN COLLABORATIVE
ARCHITECTS
301 N. N. 10TH ST. SUITE 100
JOPLIN, MISSOURI 64501
PHONE: 417-785-0000 FAX: 417-785-0000
WWW.BUXTONKUBIKDODD.COM
REGISTERED ARCHITECTS MISSOURI

NEW EXHAUST FAN CURB SECTION

SCALE: 1/12"=1'-0"
A-153

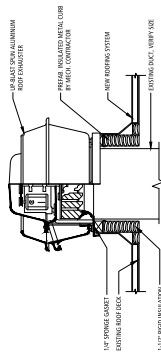

1

GAS PIPING ROOF SUPPORT DETAIL

NOT TO SCALE
A-153

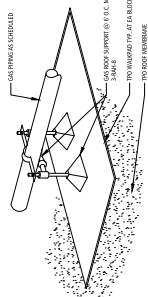

4

PLUMBING VENT FLASHING

SCALE: 1/16\"/>

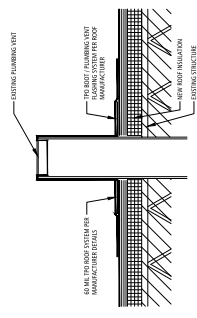

5

NEW RTU CURB DETAIL SECTION

SCALE: 1/12\"/>

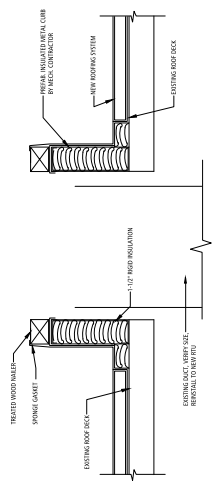

2

UNIT HTR FLUE RE-FLASHING

SCALE: 1/16\"/>

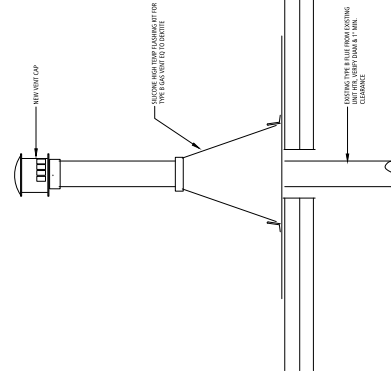

3

PACKAGED ROOFTOP UNITS

MARK	DESCRIPTION	MANUFACTURER	MODEL NUMBER	SP	CFM	HP	ELF	REMARKS	NOTES
RF-1	CENTRIFUGAL ROOFTOP FAN	COOK	100700A	18	1377	1646	250	10071	ROA-FLUOR
RF-2	CENTRIFUGAL ROOFTOP FAN	COOK	100700B	18	1547	1835	250	10072	ROA-FLUOR
RF-3	CENTRIFUGAL ROOFTOP FAN	COOK	100700C	24	2442	3131	312	10073	250 HP BUREAU 60-200B
RF-4	CENTRIFUGAL ROOFTOP FAN	COOK	100700D	18	1592	1935	175	10074	ROA-FLUOR
RF-5	CENTRIFUGAL ROOFTOP FAN	COOK	100700E	18	1592	1935	175	10075	ROA-FLUOR
RF-6	CENTRIFUGAL ROOFTOP FAN	COOK	100700F	18	1592	1935	175	10076	ROA-FLUOR
RF-7	CENTRIFUGAL ROOFTOP FAN	COOK	100700G	18	1592	1935	175	10077	ROA-FLUOR
RF-8	CENTRIFUGAL ROOFTOP FAN	COOK	100700H	24	2442	3131	312	10078	ROA-FLUOR
RF-9	CENTRIFUGAL ROOFTOP FAN	COOK	100700I	18	1592	1935	175	10079	ROA-FLUOR

FAN SCHEDULE

MARK	DESCRIPTION	MANUFACTURER	MODEL NUMBER	SP	CFM	HP	ELF	REMARKS	NOTES
RF-1	CENTRIFUGAL ROOFTOP FAN	COOK	100700A	18	1377	1646	250	10071	ROA-FLUOR
RF-2	CENTRIFUGAL ROOFTOP FAN	COOK	100700B	18	1547	1835	250	10072	ROA-FLUOR
RF-3	CENTRIFUGAL ROOFTOP FAN	COOK	100700C	24	2442	3131	312	10073	250 HP BUREAU 60-200B
RF-4	CENTRIFUGAL ROOFTOP FAN	COOK	100700D	18	1592	1935	175	10074	ROA-FLUOR
RF-5	CENTRIFUGAL ROOFTOP FAN	COOK	100700E	18	1592	1935	175	10075	ROA-FLUOR
RF-6	CENTRIFUGAL ROOFTOP FAN	COOK	100700F	18	1592	1935	175	10076	ROA-FLUOR
RF-7	CENTRIFUGAL ROOFTOP FAN	COOK	100700G	18	1592	1935	175	10077	ROA-FLUOR
RF-8	CENTRIFUGAL ROOFTOP FAN	COOK	100700H	24	2442	3131	312	10078	ROA-FLUOR
RF-9	CENTRIFUGAL ROOFTOP FAN	COOK	100700I	18	1592	1935	175	10079	ROA-FLUOR

NOTES:
1. VERIFY GAS PIPING FAN MANUF.
2. PROVIDE GIP FLASHING GASKET SYSTEM AND PRINCE KIT
3. PROVIDE GIP FLASHING GASKET SYSTEM AND PRINCE KIT

OFFICE OF ADMINISTRATION
DIVISION OF FACILITIES
MANAGEMENT,
DESIGN AND CONSTRUCTION
NATIONAL GUARD
CONSTRUCT ADDITION
JOPLIN READINESS CENTER
2000 W. 32ND STREET
JOPLIN, MISSOURI 64804

PROJECT # T2333-01
SITE # 6276
FACILITY # 8136276002

REVISION: SUBMITTAL
REVISION: DATE: 04/24/2024
REVISION: DATE: 04/24/2024
REVISION: DATE: 04/24/2024
REVISION: DATE: 04/24/2024

CAD DWG FILE: A-153
DRAWN BY: JLD
CHECKED BY: JLD
DESIGNED BY: JLD

SHEET TITLE:
RE-ROOF DETAILS
(BID ALTERNATE #02)

SHEET NUMBER:
M-153
33 OF 37 SHEETS
04/24/2024